

Notes:
 This drawing is the property and copyright of John Kerr Associates and written consent must be obtained before divulging to a third party or copying whole or part of the drawing by any method whatsoever.
 All dimensions are to be checked on site prior to construction.
 Any discrepancies are to be reported to the architect before works commence.
 All dimensions are in millimeters.
 Do not scale dimension.
 This drawing is to be read in conjunction with the specification and with all relevant consultants' specialists' drawings and/or documents.
 All relevant Statutory Approvals to be obtained before works commence.

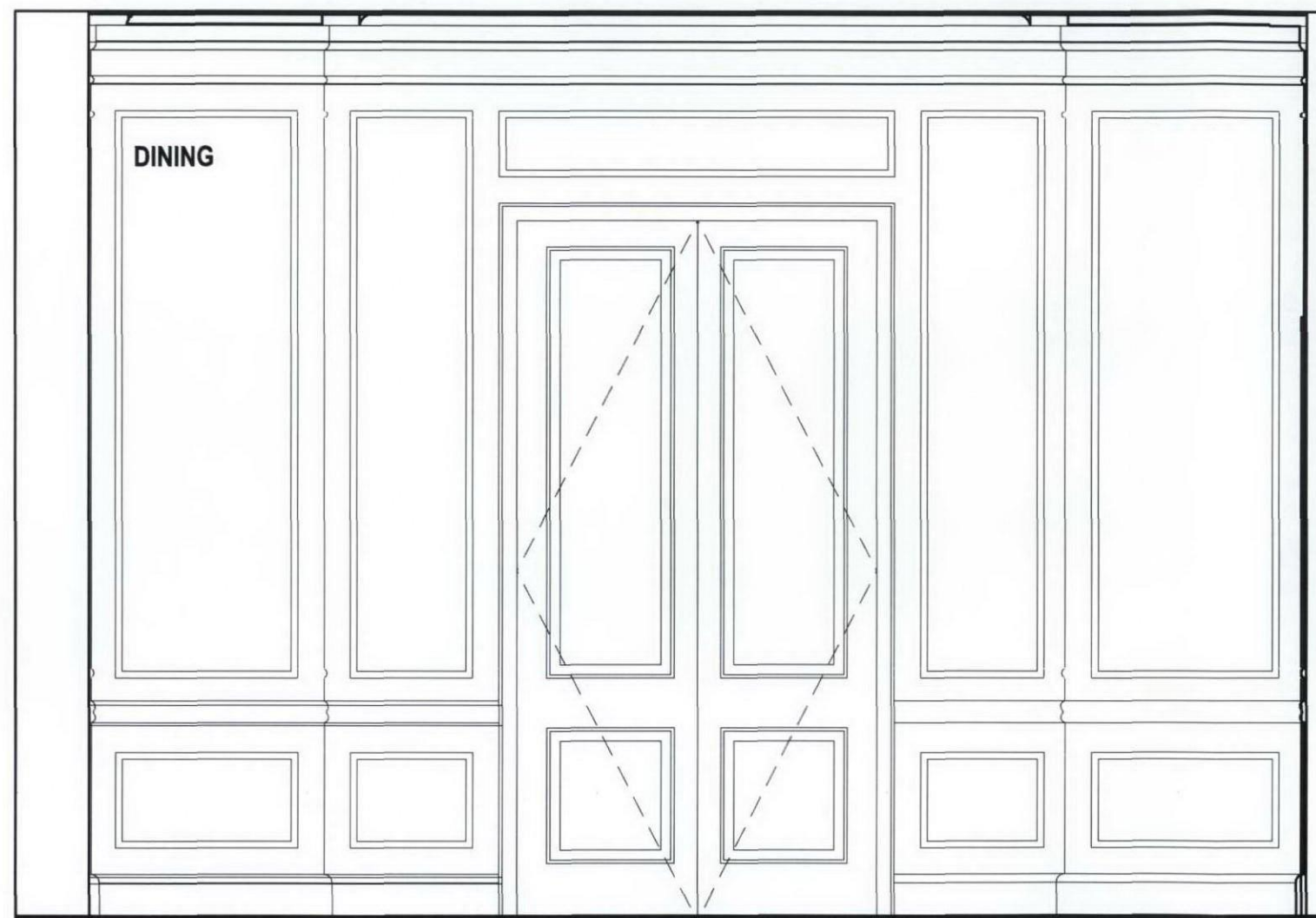

PROPOSED SECTION C

DOUBLE DOORS TO DINING ROOM AS PROPOSED

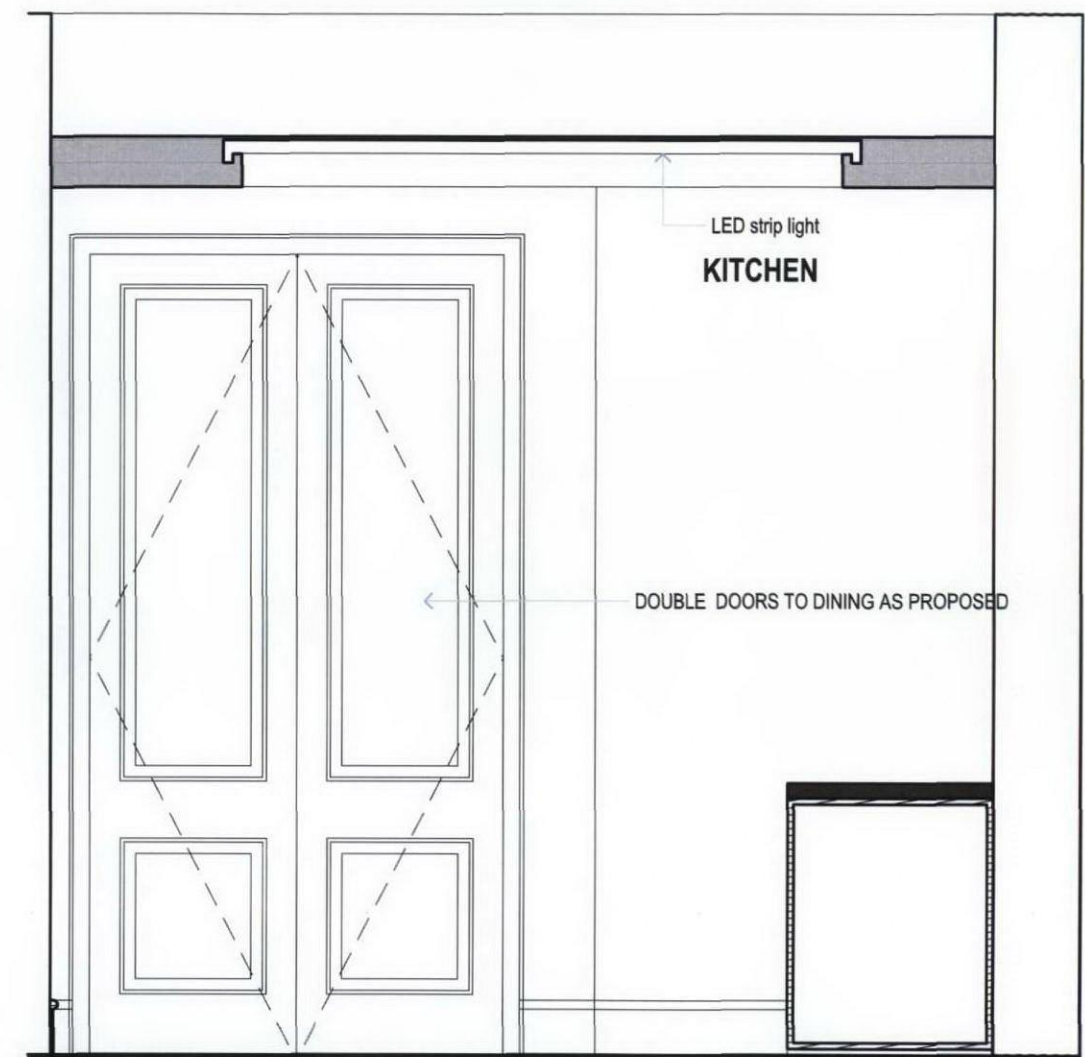

PROPOSED SECTION B

Project:	19 CHESTER TERRACE LONDON NW1	Drawing:	PROPOSED SECTION B AND C	Scale:	1:25@A3
Client:	MR AND MRS FAIMAN			Date:	SEPTEMBER 2012
				Drawn:	PK
				No:	423/14G
JOHN KERR ASSOCIATES 57 CAMDEN MEWS LONDON NW1 9BY TEL:020 7209 2784 FAX:020 7209 2786 WWW.JOHNKERRASSOCIATES.COM					