

Copyright reserved to Clear Future Architecture Ltd.

Figured dimensions only are to be used.  
Contractor must verify all dimensions on site before commencing work. Any discrepancies must be brought to the attention of the architect.

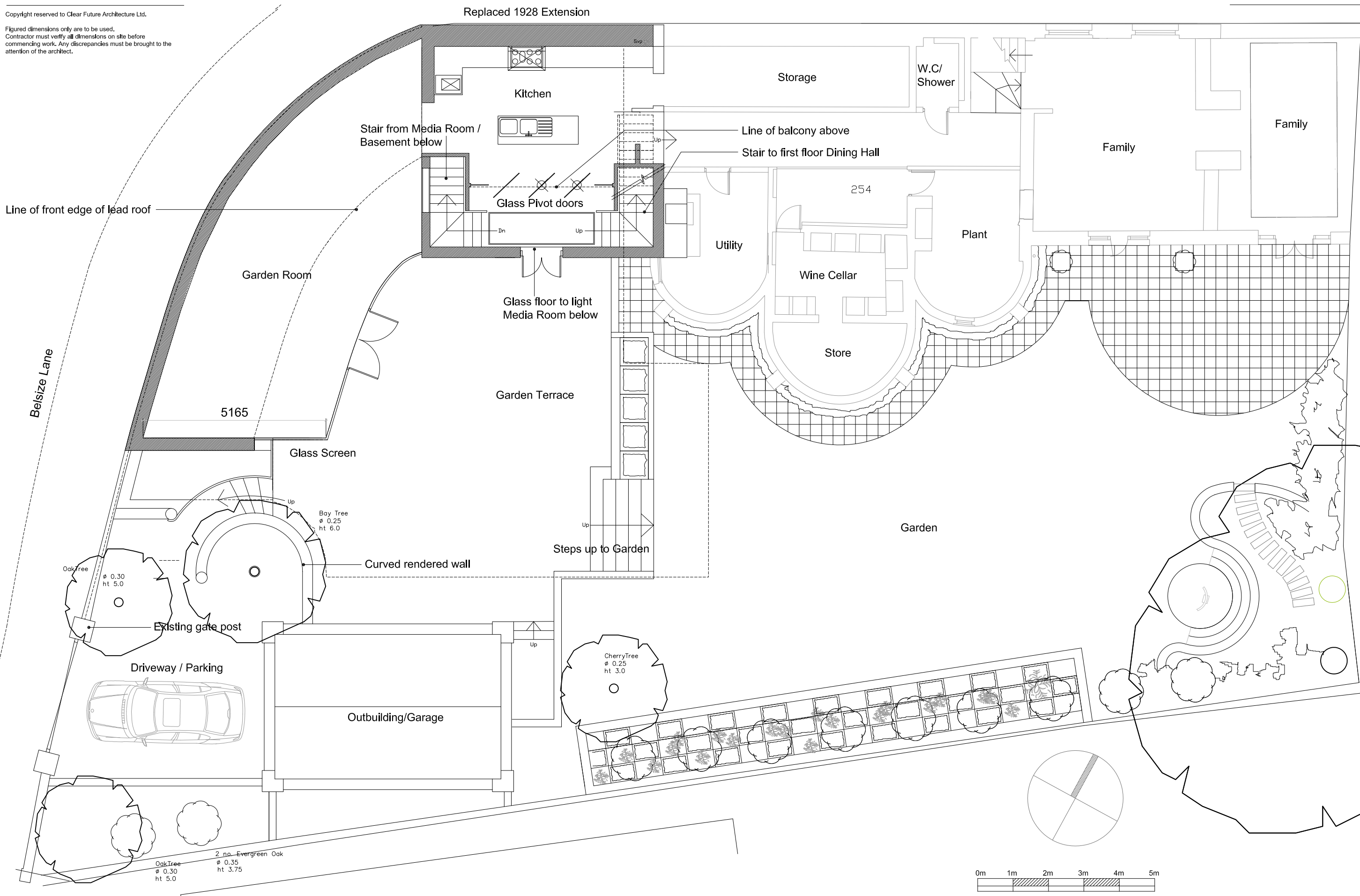

Garden Floor Plan

Hunter's Lodge, Belsize Lane, London

Drawing: Lower Ground/Garden Floor Plan (Proposed)

Scale: 1:100@A3, 1:50@A1 Drawn: MW

Status: Planning Date: Oct. 2012

Ref: 1007 - 120 Revision: C

Clear Future : Architecture

Cotbank Mews, 152 Westbury Road,  
Westbury on Trym, Bristol, BS9 3AL

Telephone: +44 (0)117 962 1432

Mobile: +44 (0)7973264343

E-Mail: mark.watkins@cf-architecture.co.uk