

Rev	Date	Description
B	2012-06-21	PLAN AMENDED
C	2012-06-25	FOOD TECH ROOM ADDED.
D	2012-07-05	PLAN AMENDED TO SUIT PLANNERS COMMENTS.
E	2012-07-20	OUTLINES OF EXISTING BASEMENT SHOWN.
F	2012-10-16	PLAN AMENDED TO SUIT PLANNERS COMMENTS. PLANNING ISSUE.

NORTH

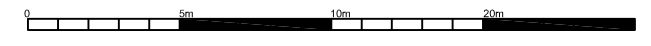
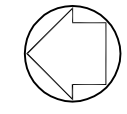

NEW ENCLOSURE FOR WASTE COMPOUND
 2m high timber fence

2m timber outer fence
 3m inner mesh fence
 -planting between

MAIN ENTRANCE TO DAY UNIT

BICYCLE STANDS

MAIN ENTRANCE TO TAVISTOCK

SITTING & PLANTING (STAFF GARDEN)

DROP OFF

access to garden

DAY UNIT PLAY AREA

TRUST GARDEN

TRUST SITE

SINGLE STOREY DEMOLISHED
2 STOREY NEW BUILD

outline of existing basement

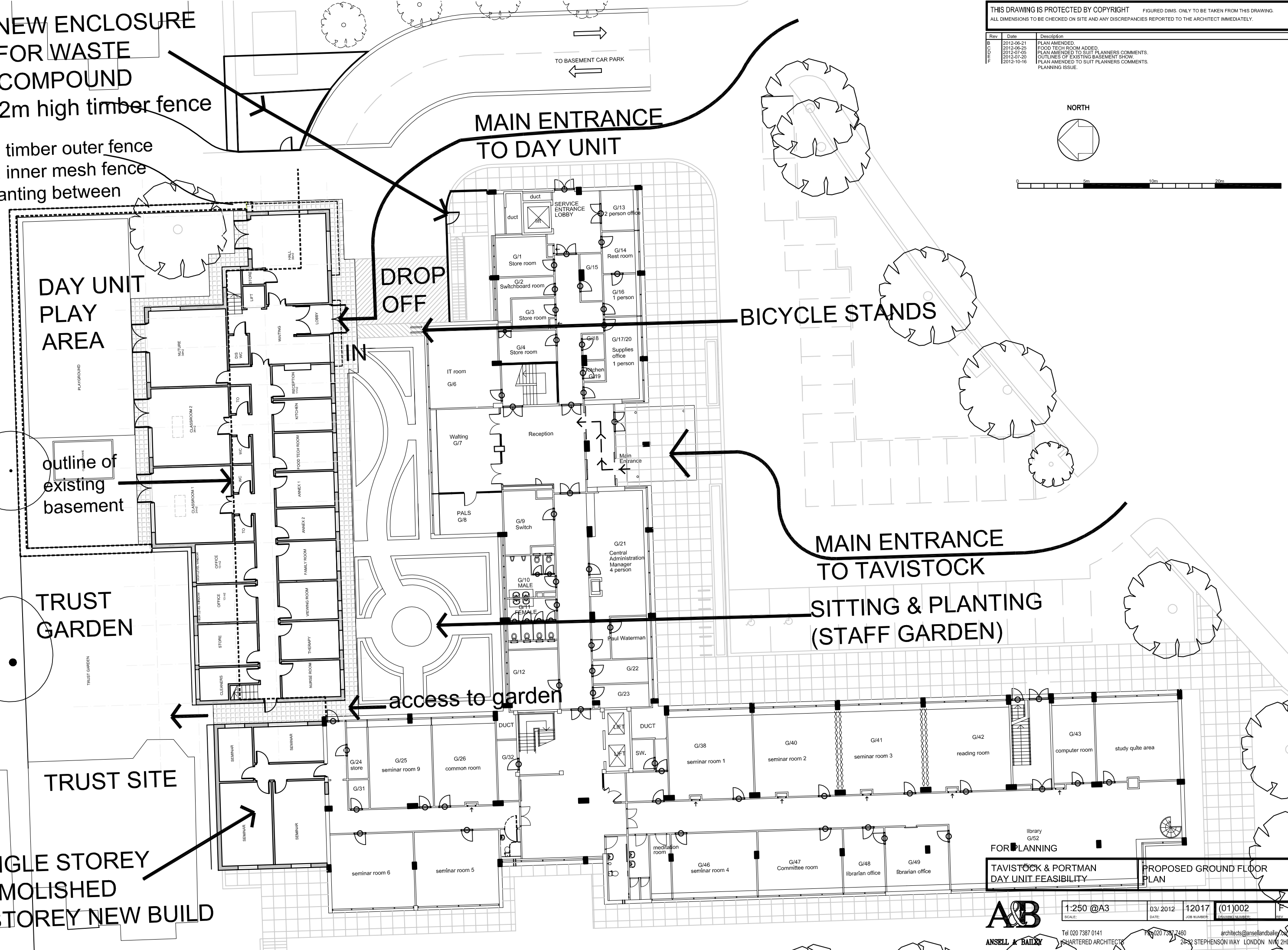

FOR PLANNING
TAVISTOCK & PORTMAN DAY UNIT FEASIBILITY
 PROPOSED GROUND FLOOR PLAN