

Notes:

1. Copyright of this drawing remains the sole property of Bellis Cooley Architects unless otherwise assigned in writing.

2. Do not scale from this drawing. Figured dimensions are to be worked in all cases with any discrepancies reported to the Architect prior to commencement of any work.

3. Setting-out is based on outline survey only. All dimensions to be checked on site prior to construction/ordering.

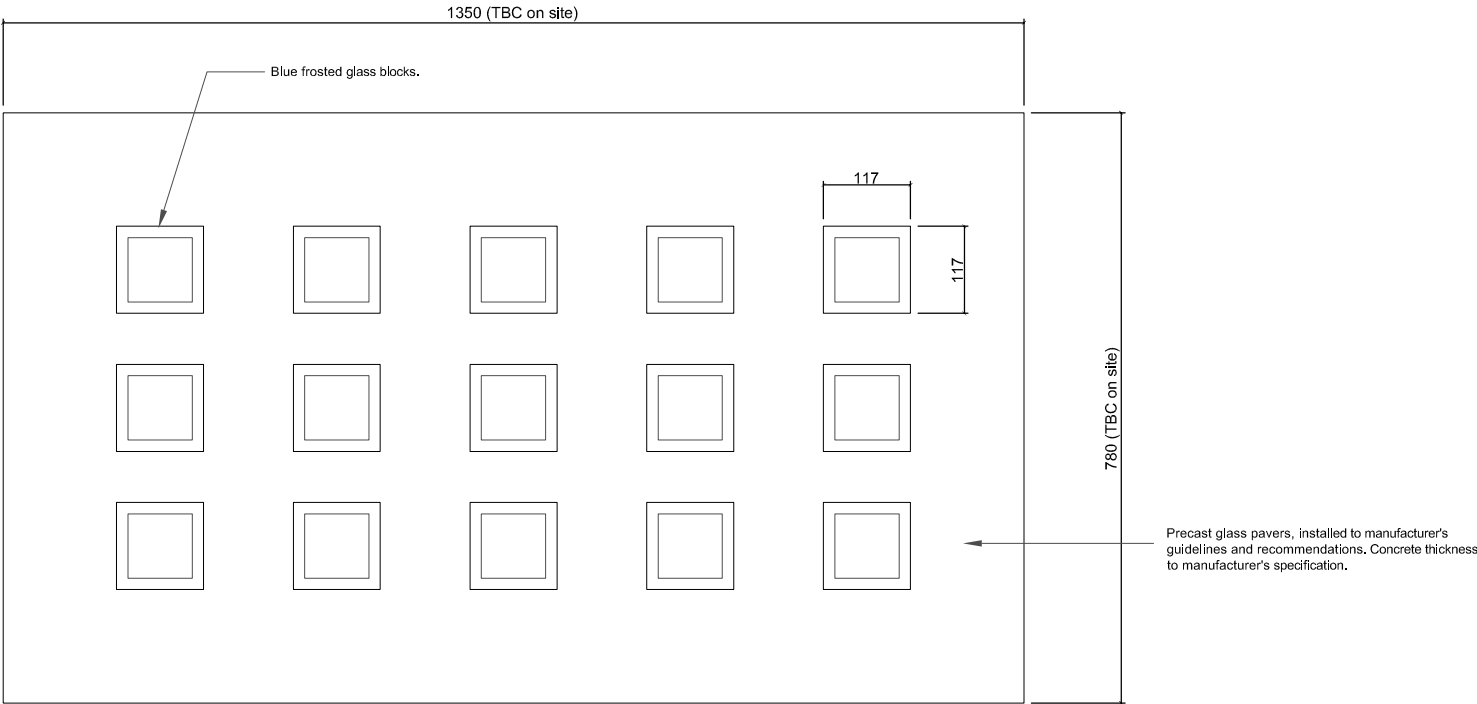

PRECAST UNIT TO ACHIEVE
1HR FIRE RESISTANCE

1 Plan

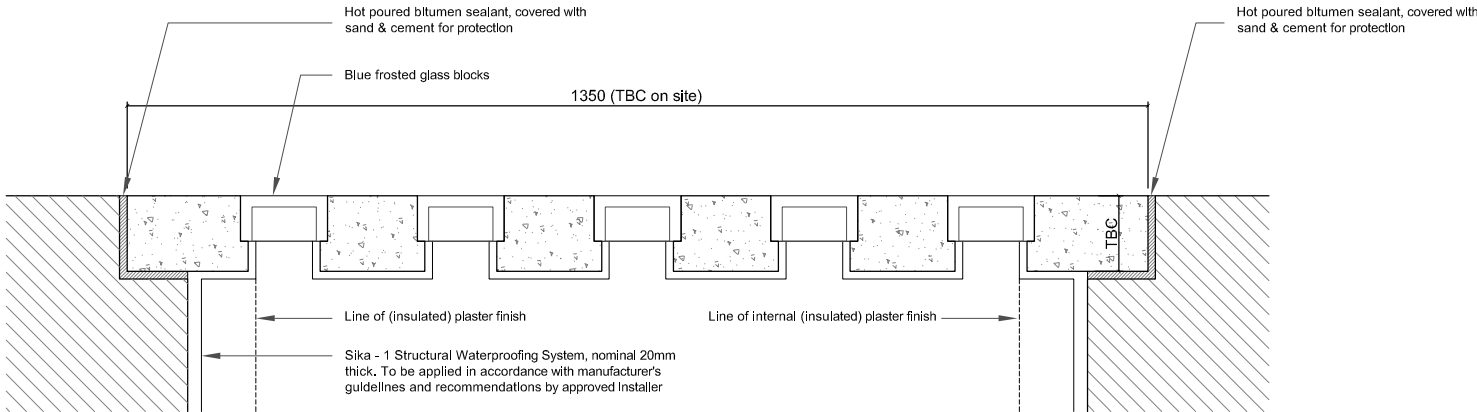

2 Section

| | | | |
|-----|---------------------|----|----------|
| A | Updated to comments | IE | 22.11.12 |
| - | New drawing | IE | 21.11.12 |
| REV | DESCRIPTION | BY | DATE |

Cooley | Architects

Studio 201 16 Baldoins Gardens London EC1N 7RJ
t: 020 3176 4481 www.cooleyarchitects.com

CONTRACT

Redevelopment of
133 Kings Cross Road WC1X 9BJ

DRAWING TITLE

Details - Pavement Lights

| | | |
|-----------------|----------|-------------|
| DRAWN BY | DATE | CHECKED |
| AT | Feb 2012 | RC |
| SCALE | SIZE | STATUS |
| 1:5@A1, 1:10@A3 | A1 or A3 | For Comment |

| | |
|------------|-----|
| DRAWING No | REV |
| 0548 - 907 | A |