

scales 1: 50 @ A1
1: 100 @ A4

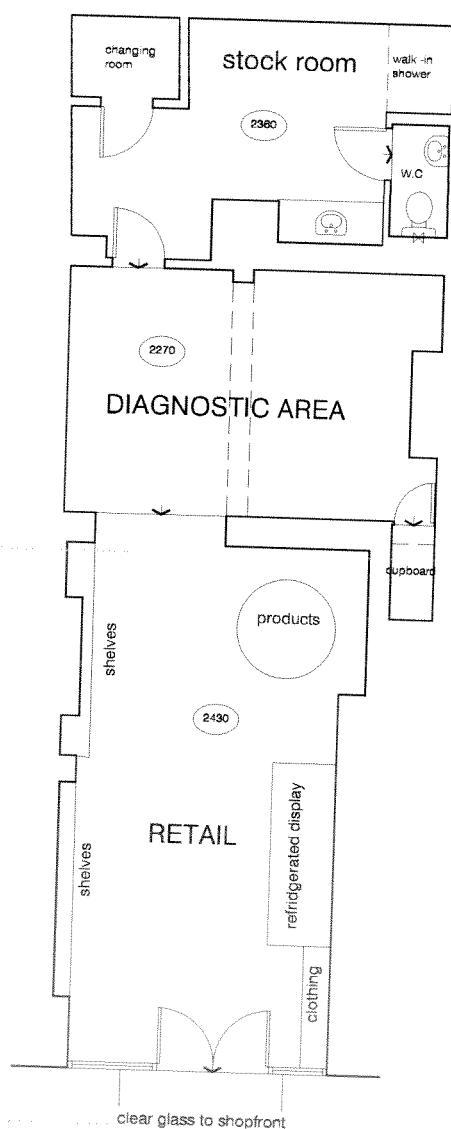
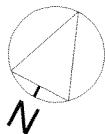

CHETWYND ROAD

Ground Floor

DVM
ARCHITECTS

4a Murray Street London NW1 9RE
Telephone 0207 485 2121 Facsimile 0207 267 2527
e-mail: studio@dvmarch.com

Client
Daniel Tolbot

Project
63 Chetwynd Road
London NW5 1BX

Title
Ground Floor Plan
as Existing

Scale	Date	Job No
1: 50	24.07.2012	1812
Drawing No	Rev	
1812-01		

All dimensions are to be checked on site.
© This drawing is copyright and remains the property of David & Victoria Warner.
It is not to be reproduced in part or whole without written consent.