

A: Existing situation

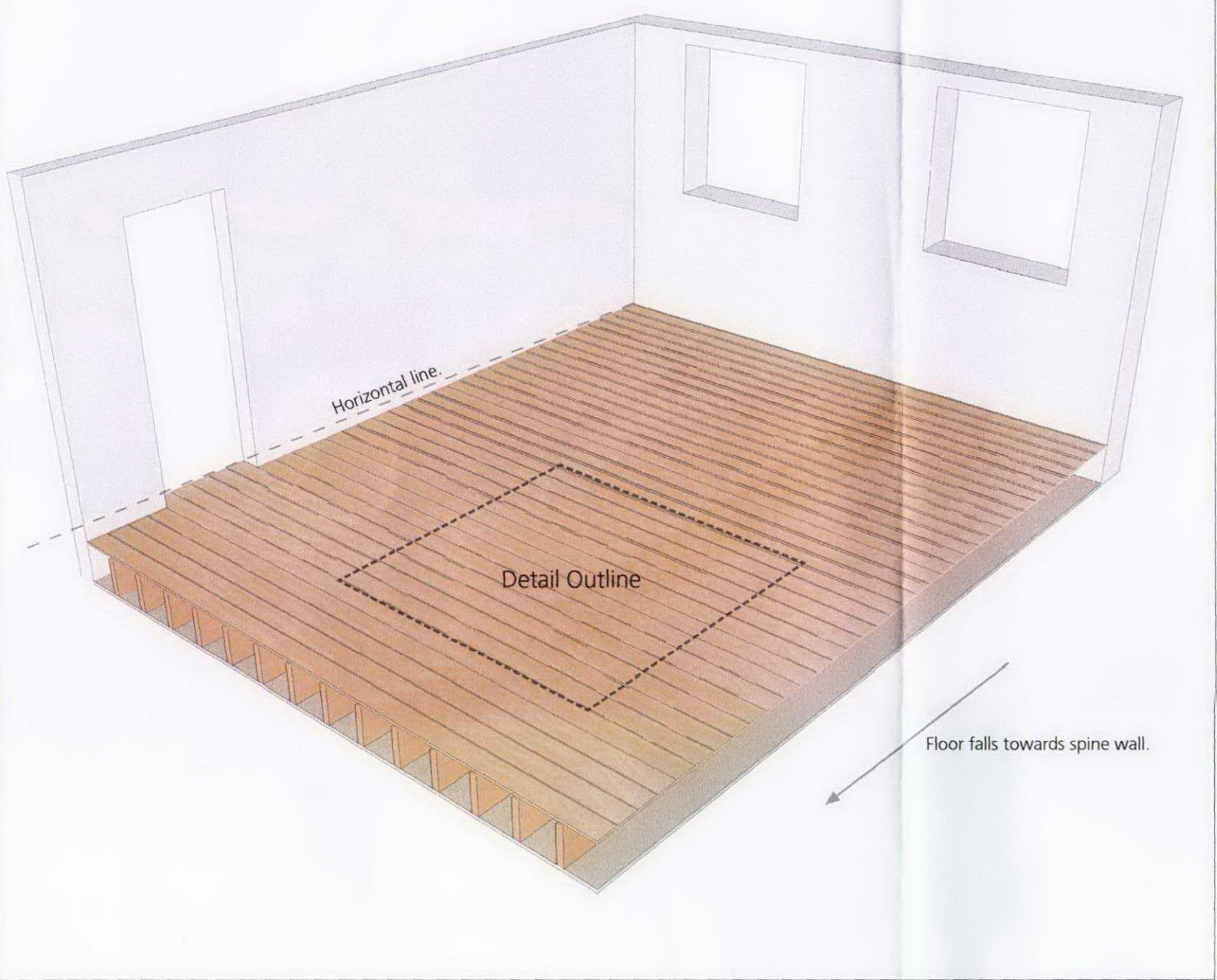

B: Detail View

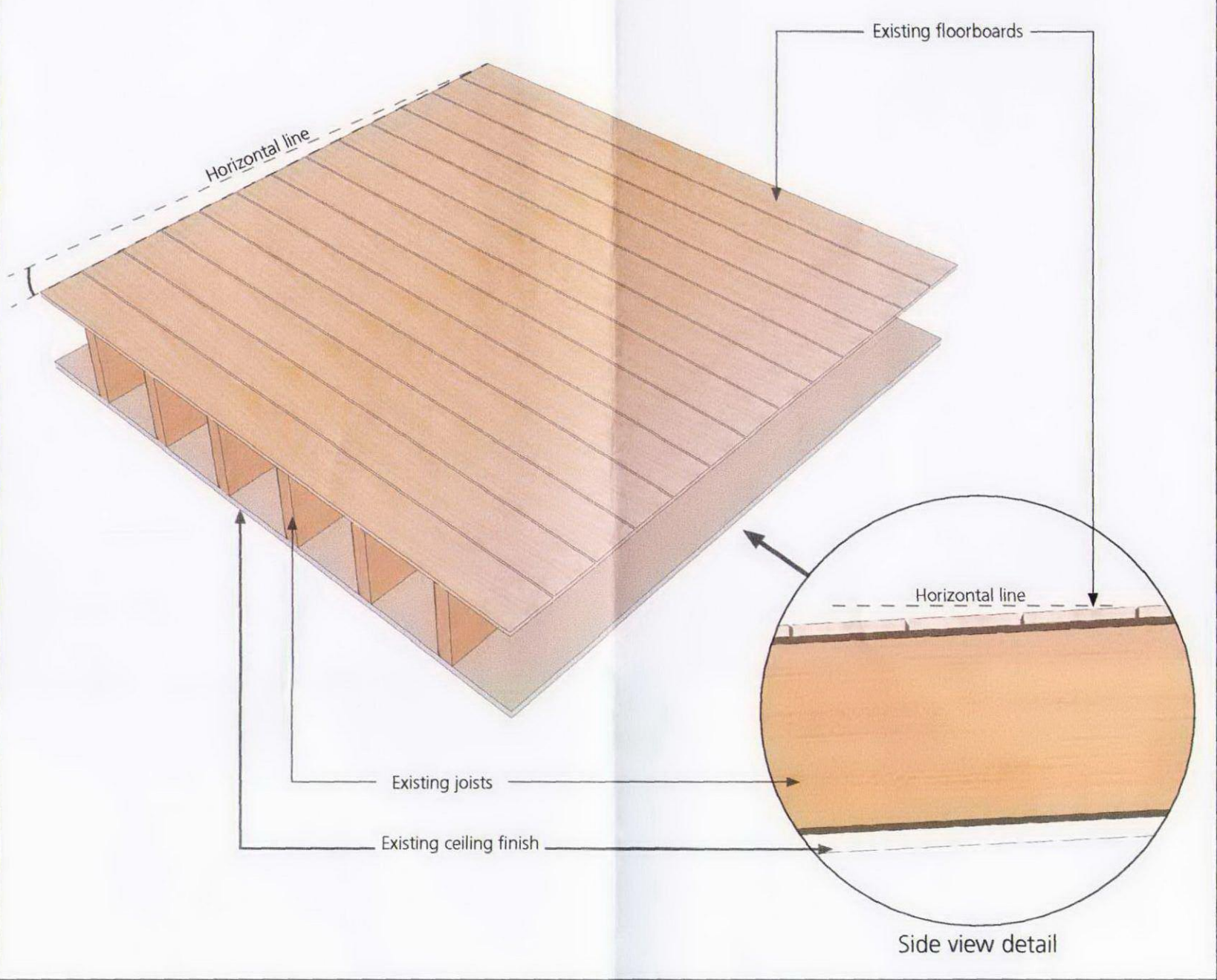

C: Detail View

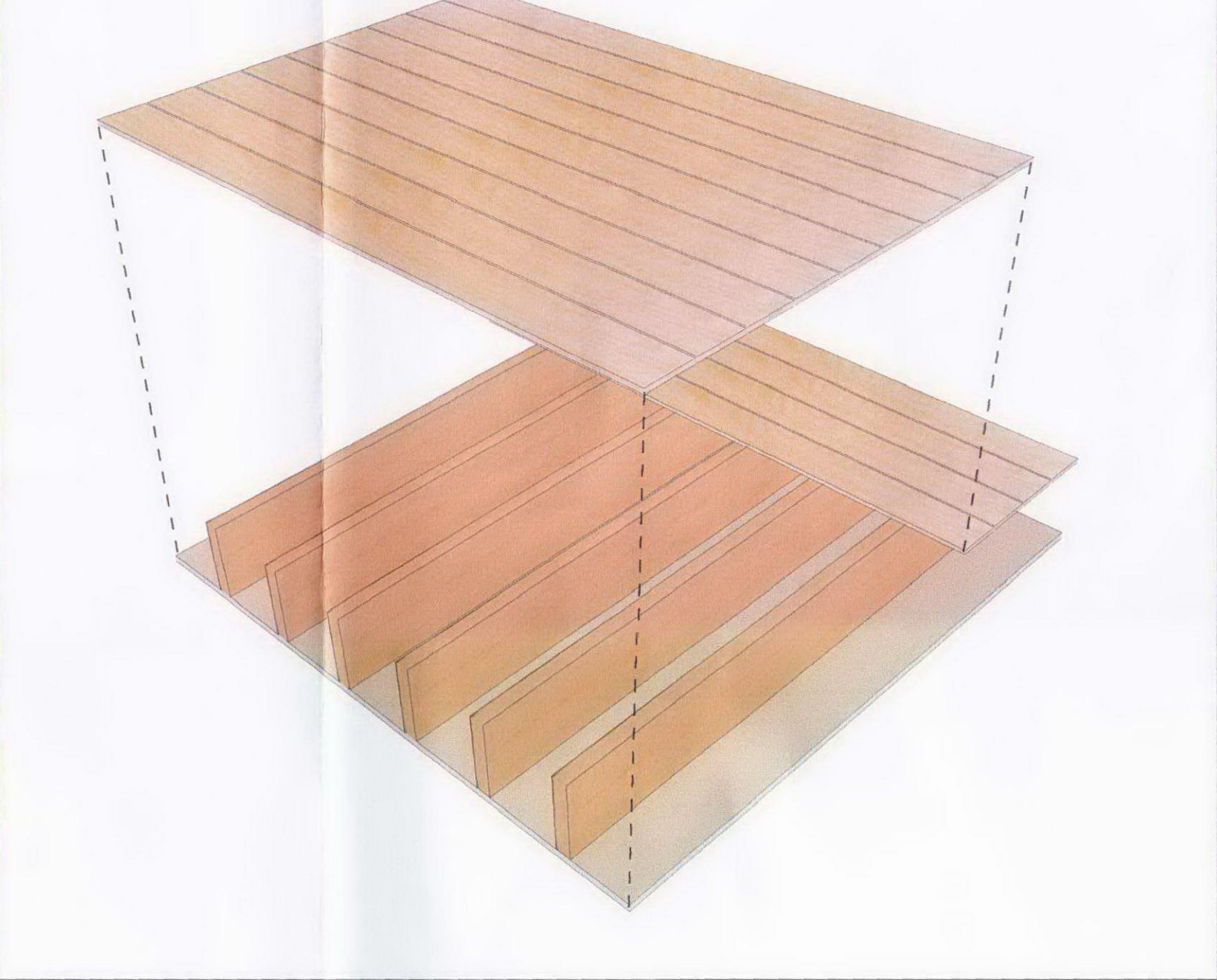

1. Remove existing floorboards and carefully set aside

D: Detail view

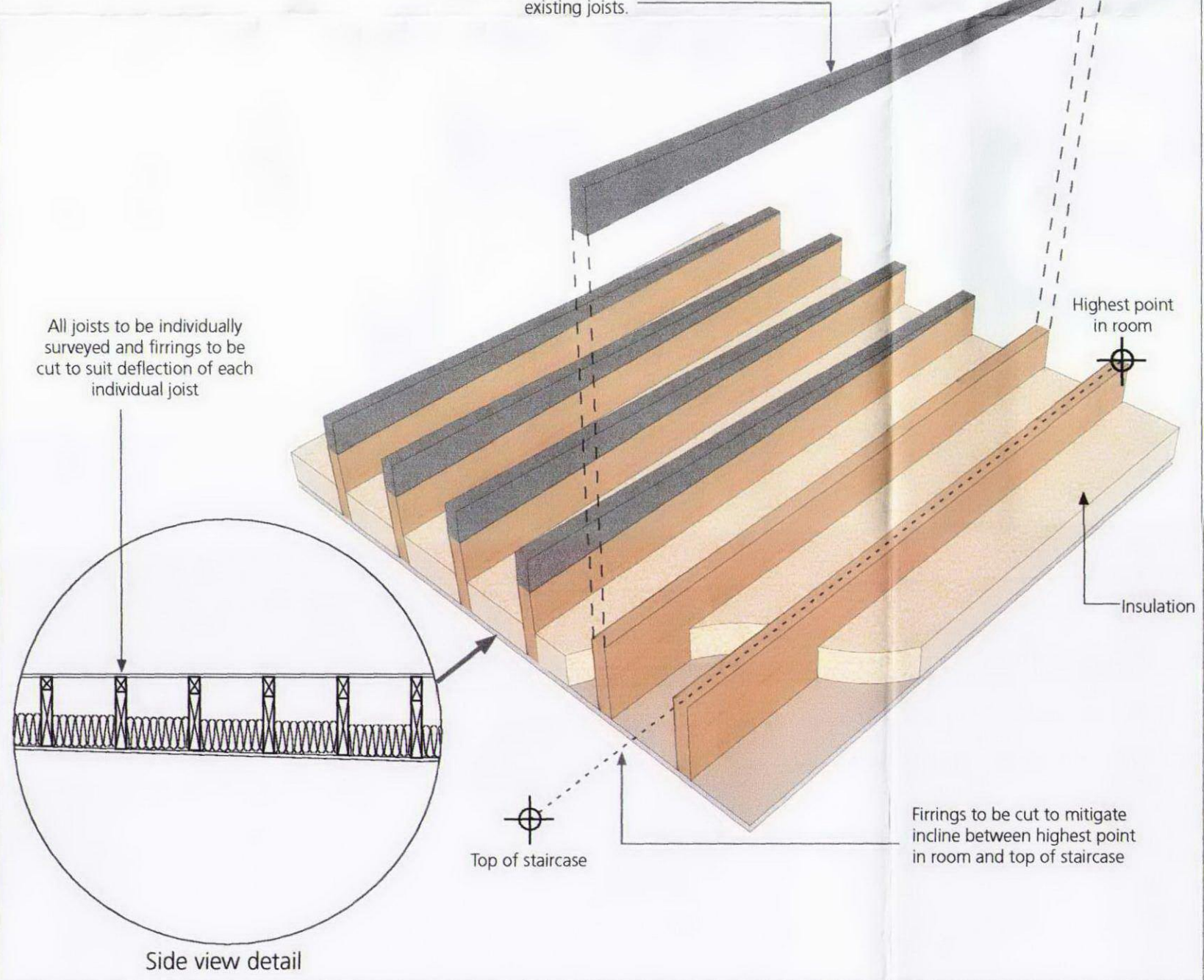

2. Level of highest point in room and top of staircase to be established. Firrings to be cut to mitigate incline between highest point in room and top of staircase
3. Firrings to be fixed to existing joists.
4. Fill voids between joists with insulation

E: Detail View

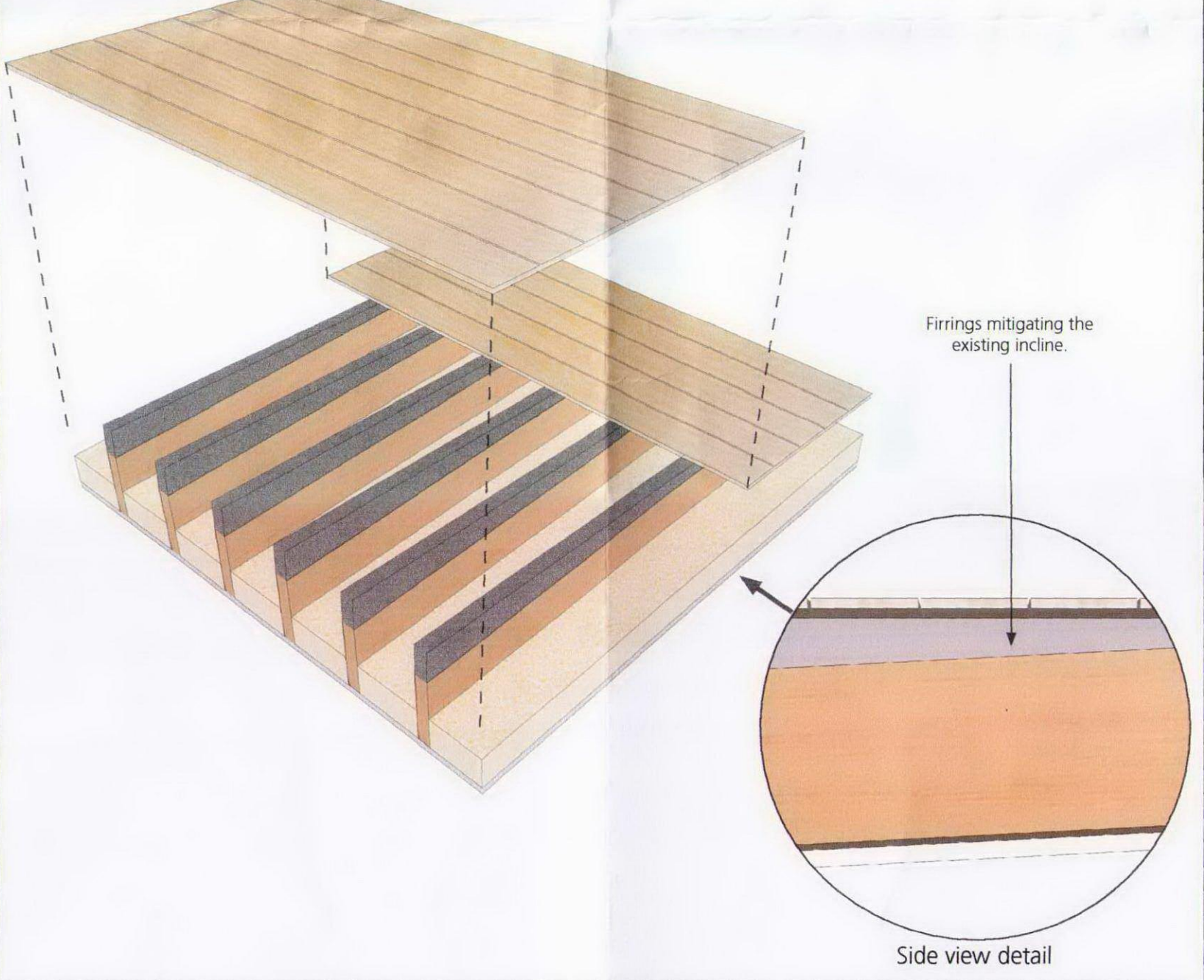

5. Replace existing floorboards

F: Proposed situation



6. Increase structural opening of doors where necessary to make up for rise in floor levels

Revision Date Amendment

Notes

Client University College London
Project 31 Tavistock Square, London, WC1H 9EZ
Drawing Proposed Floor Levelling - Process Diagram

Scale NTS
Date NOV 2012
Status PLANNING
Drawn GN

Project N° Drawing N°

burwell deakins : architects

t 020 8305 6010
f 020 8305 6020
e info@burwelldeakins.com

NO DIMENSIONS ARE TO BE SCALED FROM THIS DRAWING. THE CONTRACTOR/MANUFACTURER IS RESPONSIBLE FOR CHECKING ALL DIMENSIONS AND QUERRING ANY DISCREPANCIES. THIS DRAWING IS THE PROPERTY OF BDA ARCHITECTS LTD. COPYRIGHT IS RESERVED BY THEM AND THE DRAWING IS ISSUED ON THE CONDITION THAT IT IS NOT COPIED, REPRODUCED, EITHER WHOLLY OR IN PART, OR FOR ANY OTHER PURPOSE WITHOUT THE WRITTEN PERMISSION OF BDA ARCHITECTS LTD.