

GENERAL NOTES:

Doors (Existing and New to Match)

- Prepare for decoration
- Intumescent layer added to each inset panel
- Smoke seals routed into door edges

Windows (Existing)

- All windows to be eased
- New sash cords
- New weights where required
- New staff and parting beads where required
- New brush seals routed into each window
- Decorate
- Roller blind to all windows without shutters - between secondary glazing and window where applicable

Architectural Features

- Existing skirtings, dado rails, picture rails, friezes, cornicing and ceiling roses to be retained and redecorated. Where required, existing features to be repaired to match original.

Floors Levelling

- Floor may require levelling works to be carried out. A levels survey will be carried out to determine the extent of work required.

KEY:

- Existing fabric to be retained
- Proposed infill to match existing adjacent
- Elements to be removed

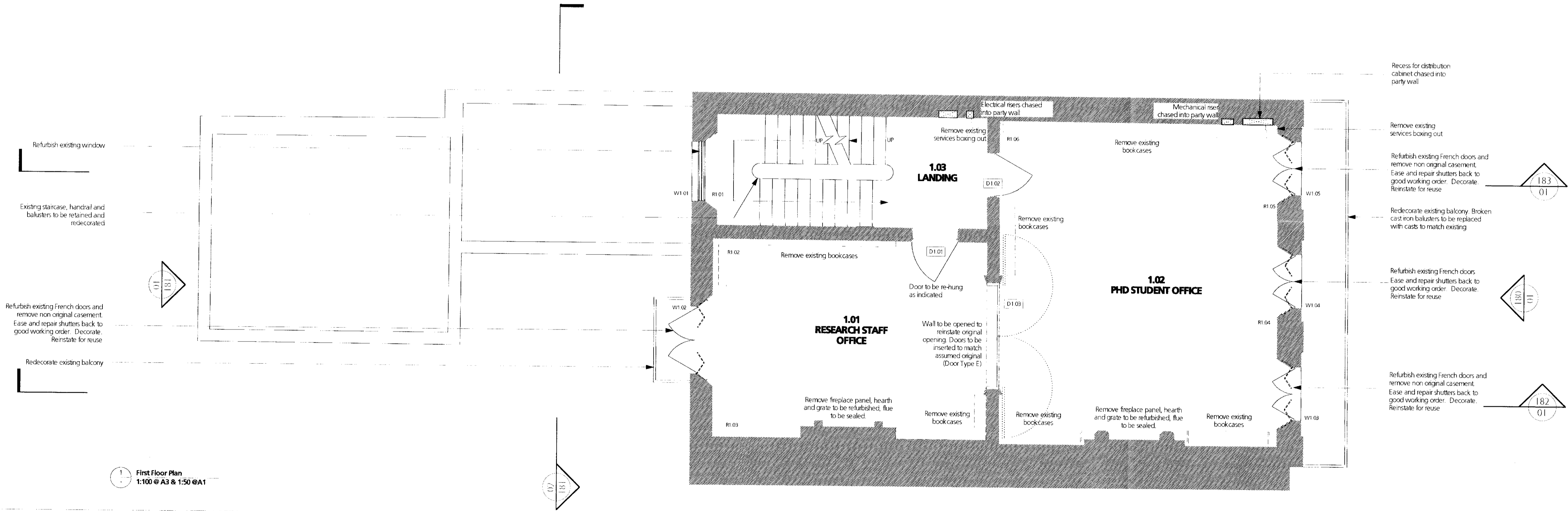

1 First Floor Plan
1:100 @ A3 & 1:50 @A1

Revision	Date	Amendment	Notes
----------	------	-----------	-------

NO OTHER WORK TO BE CARRIED FROM THE DRAWING. THE CONTRACTOR MANUFACTURER IS RESPONSIBLE FOR CHECKING ALL DIMENSIONS AND QUANTITIES. ANY DISCREPANCIES SHOULD BE REPORTED TO THE ARCHITECT IMMEDIATELY. THE DRAWING IS NOT TO BE USED FOR ANY OTHER PURPOSES WITHOUT THE WRITTEN CONSENT OF BURWELL DEAKINS ARCHITECTS.

Client University College London
Project 31 Tavistock Square, London, WC1H 9EZ
Drawing Proposed First Floor

Scale 1:50 @A1 1:100 @A3
Date OCT 2012 Status Drawn PLANNING
Drawn GN

Project N° 479 Drawing N° 479/PL/122 Revision PI

burwell deakins : architects

t 020 8305 6010
f 020 8305 6020
e info@burwellarchitects.com
w www.burwellarchitects.com
a unit 001 california building deals gateway london SE13 7SF