

GENERAL NOTES:

Doors (Existing and New to Match)

- _Prepare for decoration
- _Intumescent layer added to each inset panel
- _Smoke seals routed into door edges



Windows (Existing)

- _All windows to be eased
- _New sash cords
- _New weights where required
- _New staff and parting beads where required
- _New brush seals routed into each window
- _Decorate
- _Roller blind to all windows without shutters - between secondary glazing and window where applicable

Architectural Features

- _Existing skirtings, dado rails, cornicing, ceiling roses and ornate plasterboard ceilings to be retained and redecorated. Where required, existing features to be repaired to match original.

KEY:

-  = Existing fabric to be retained
-  = Proposed infill to match existing adjacent
-  = Elements to be removed

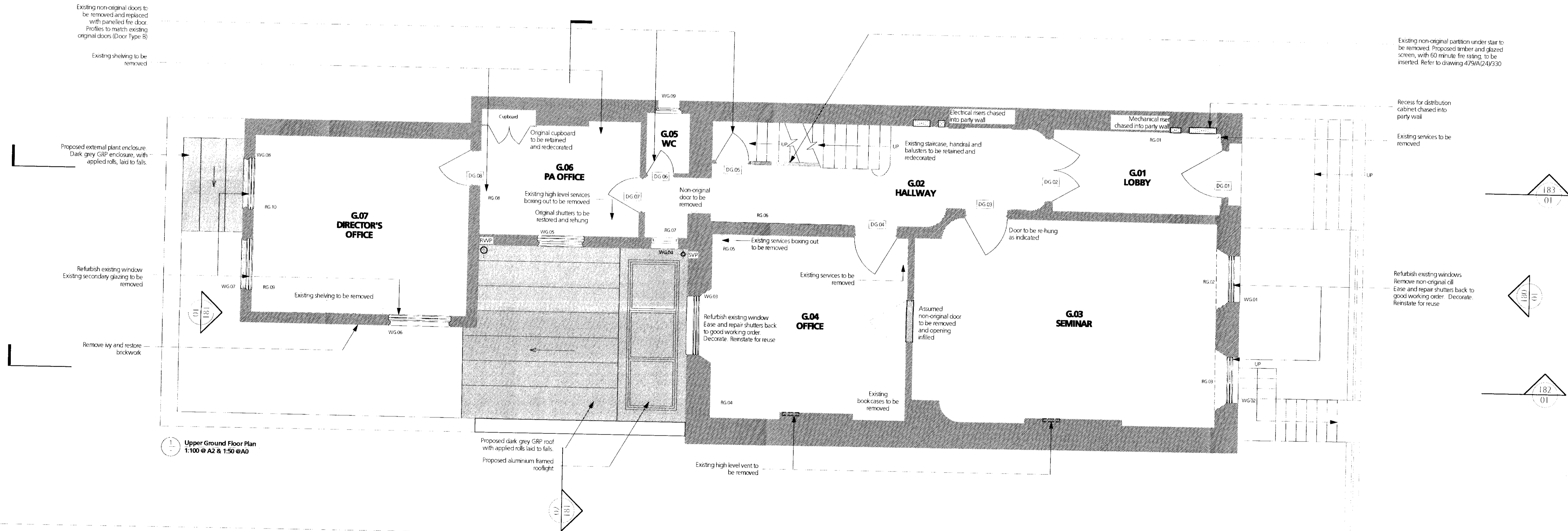

| Revision | Date | Amendment | Notes |
|----------|------|-----------|-------|
|----------|------|-----------|-------|

Client University College London
Project 31 Tavistock Square, London, WCH 9EZ
Drawing Proposed Upper Ground Floor

Scale 1:50@A1 1:100@A3
Date OCT 2012
Status Drawn
PLANINING GN

Project N° 479
Drawing N° 479/PL/121
Revision PI

burwell deakins : architects

t 020 8305 6010
f 020 8305 6020
e info@burwellarchitects.com
w www.burwellarchitects.com
a unit 0.01 california building deals gateway london SE13 7SF