

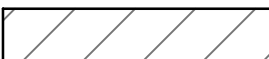



THE BEDFORD ESTATES

 PROPOSED
 EXISTING WALLS

C	29/11/2012	Issued For Planning
B	11/06/2012	Issued For Planning
A	29/05/2012	Issued For Planning
REV	ISSUE DATE	REVISION NOTES

GENERAL NOTES

Do not scale. All written dimensions must be checked on site before work commences on site or in shop. Figured dimensions take preference over those scaled. Discrepancies, where identified, must be reported to the Architect immediately.

Any areas indicated on this drawing are for guidance purposes only. No responsibility is taken for their accuracy.

All work must be carried out in accordance with the Building Regulations and to the satisfaction of the Local Authority.

STATUS

PLANNING

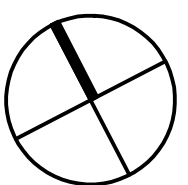

Garnett+Partners LLP
Holborn Hall
195 High Holborn
London WC1V 7BD
Tel. +44 (0)20 7404 7677
Fax. +44 (0)20 7404 6648
mail@garnettpartners.com
www.garnettpartners.com

architects / planners / designers

**GARNETT
+PARTNERS**

CLIENT

The Bedford Estate

PROJECT

40-41 Store Street
London WC1

DRAWING TITLE

Basement Plan
As Proposed

SCALE 1:50 @ A1 1:100 @ A3 DATE November '12

JOB NO. 764 DWG NO. (01)600 REV. C

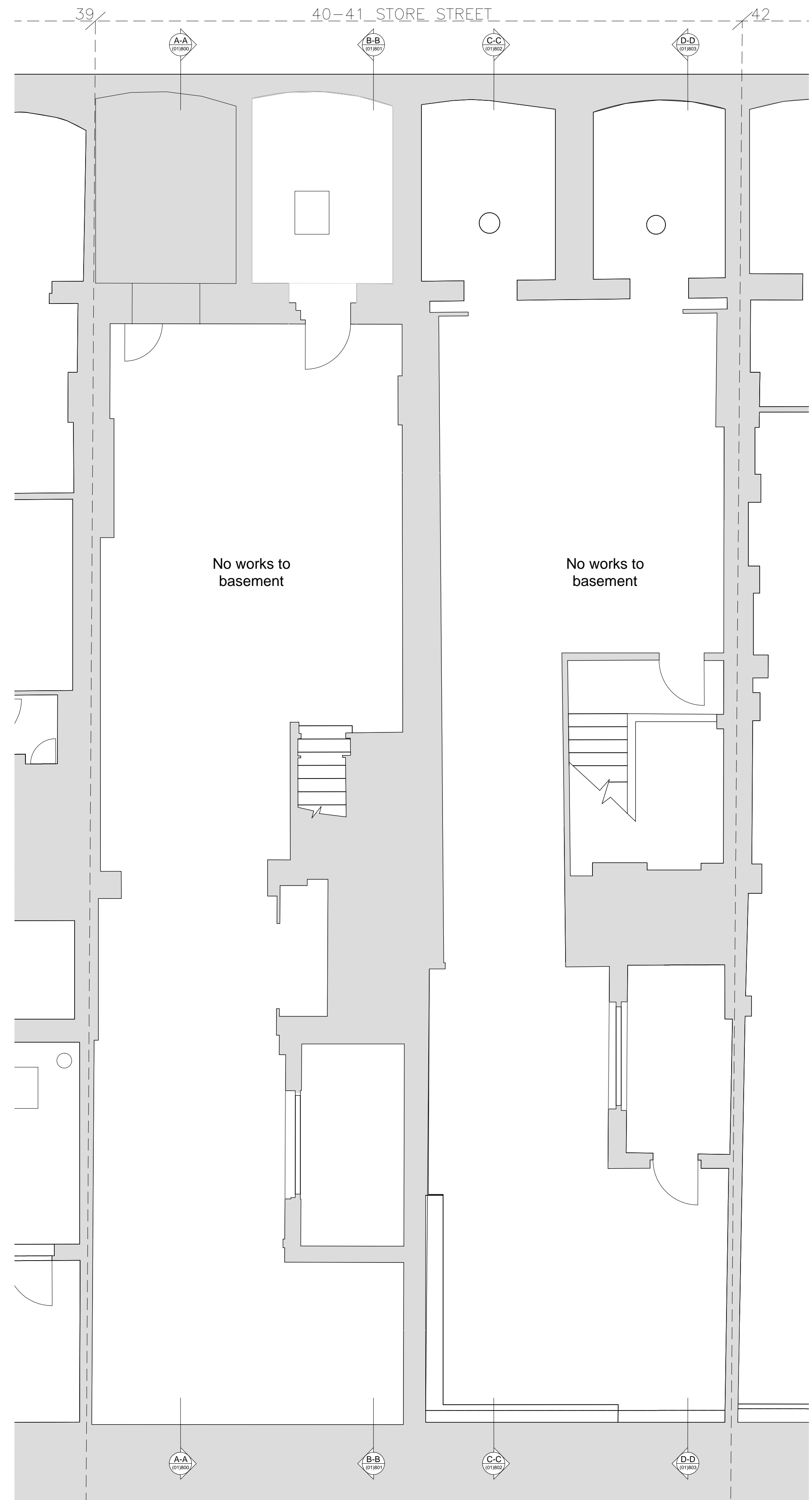

01
(01)600
BASEMENT PLAN
As Proposed

SCALE 0 1 2 4 6 10M