

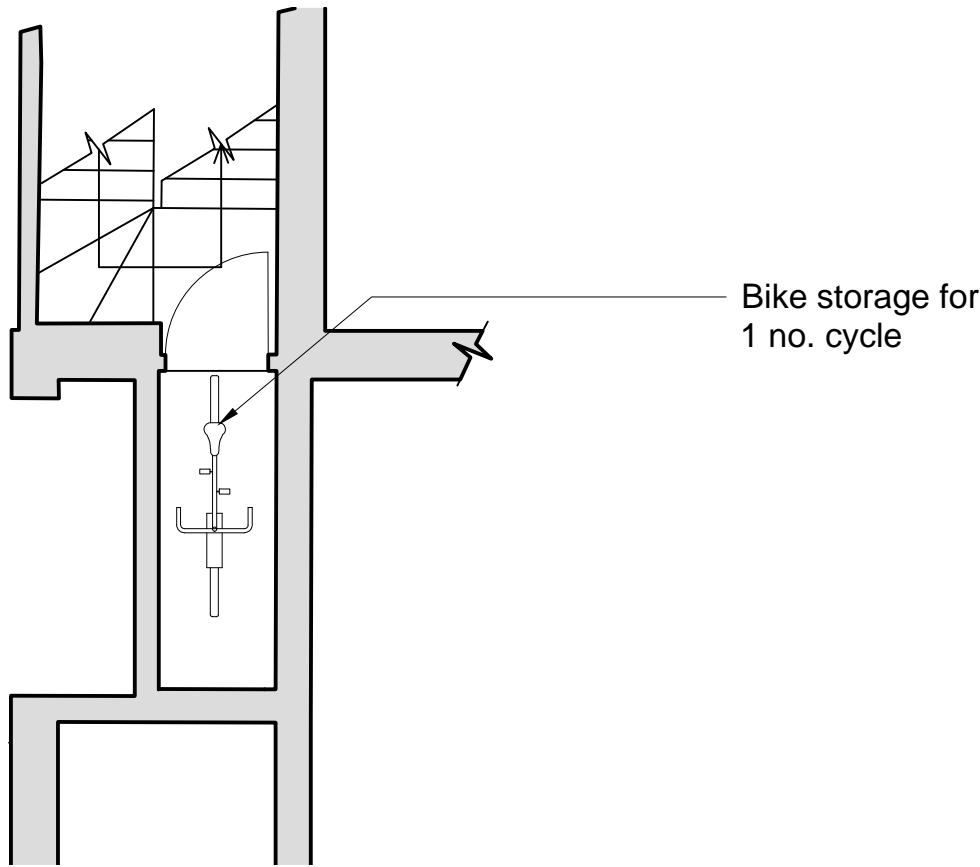

THE BEDFORD ESTATES

PROPOSED

EXISTING WALLS

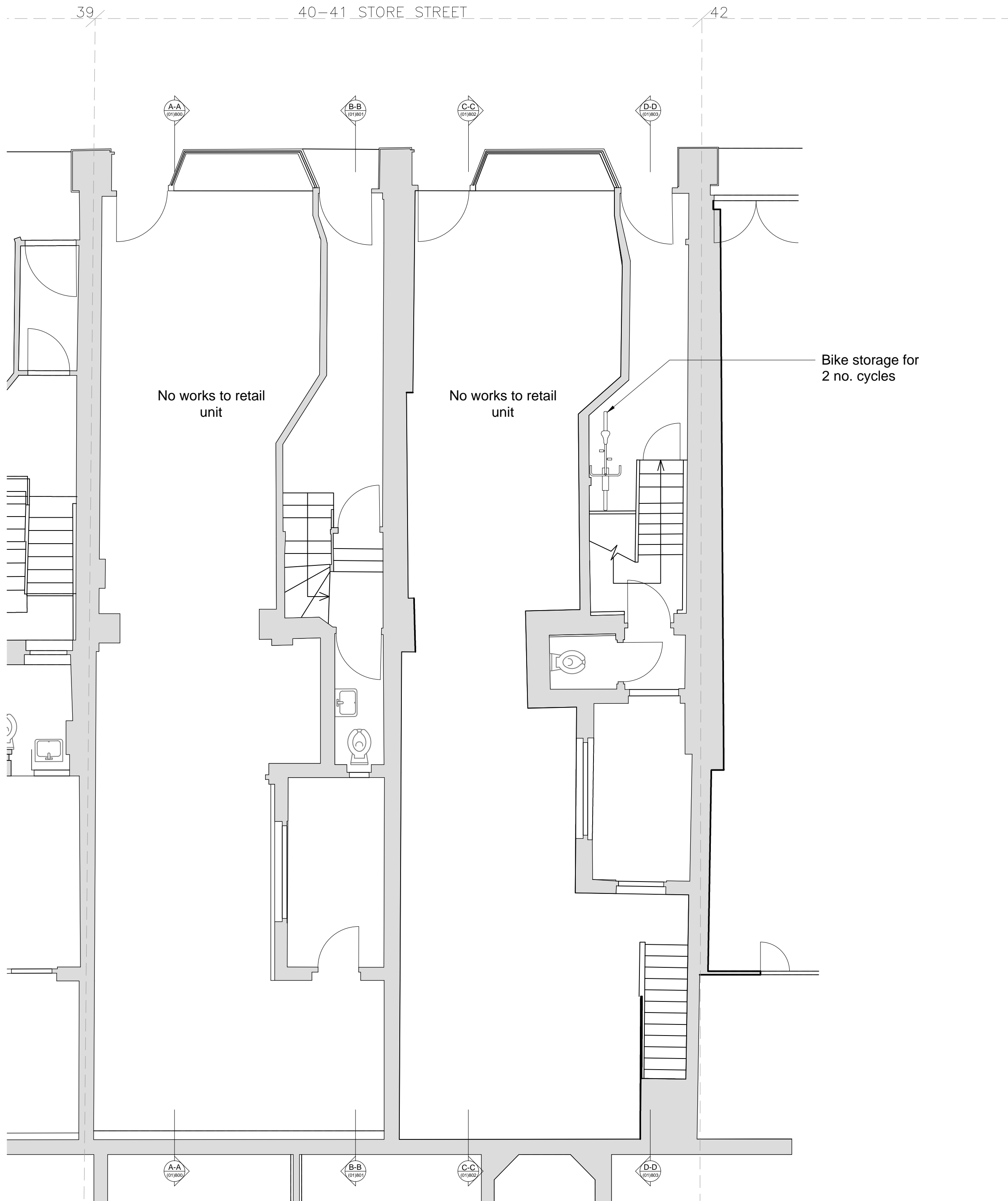

02 Half-Landing Between Ground & First Floor of No.40  
(01)601 As Proposed

01 GROUND FLOOR PLAN  
(01)601 As Proposed



D	29/11/2012	Issue For Planning
C	18/07/2012	Issue For Planning
B	11/06/2012	Issue For Planning
A	29/05/2012	Issue For Planning
REV	ISSUE DATE	REVISION NOTES

GENERAL NOTES

Do not scale. All written dimensions must be checked on site before work commences on site or in shop. Figured dimensions take preference over those scaled. Discrepancies, where identified, must be reported to the Architect immediately.

Any areas indicated on this drawing are for guidance purposes only. No responsibility is taken for their accuracy.

All work must be carried out in accordance with the Building Regulations and to the satisfaction of the Local Authority.

STATUS

PLANNING

Garnett+Partners LLP  
Holborn Hall  
195 High Holborn  
London WC1V 7BD  
Tel. +44 (0)20 7404 7677  
Fax. +44 (0)20 7404 6648  
mail@garnettpartners.com  
www.garnettpartners.com  
architects / planners / designers

CLIENT

The Bedford Estate

PROJECT

40-41 Store Street  
London WC1

DRAWING TITLE

Ground Floor Plan  
As Proposed

SCALE	1:50 @ A1	1:100 @ A3	DATE	November '12
JOB NO.	764	DWG NO.	(01)601	REV. D