

02

APPROVED THIRD FLOOR PLAN (09)

Scale 1:100

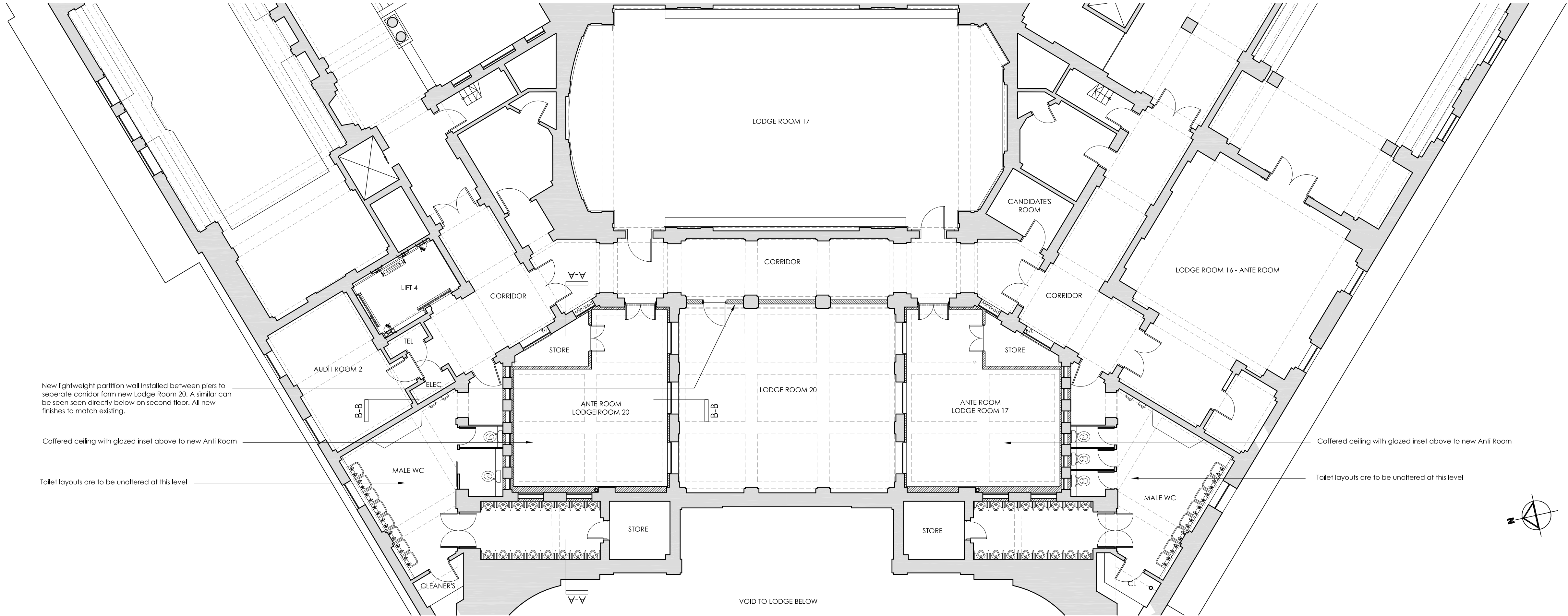

- General Notes:-
1. All drawings remain the copyright of MRDA and cannot be reproduced without approval.
 2. This drawing must not be scaled.
 3. Documents/drawings transferred by electronic mail are not to be altered without the consent of MRDA.
 4. Dimensional/level accuracy only applies to the written notation.
 5. The drawings/information issued by MRDA are to be cross referenced where necessary with other relevant Consultants information.
 6. If in doubt ask!!

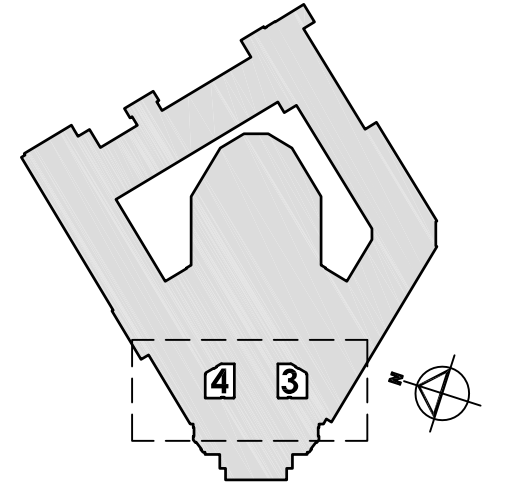

KEY:	
	Existing wall construction
	Proposed lightweight partitions and indicative walls to be drylined.
	Existing windows to be broken out and bricked up with matching glazed bricks.
	Dotted line is indicative of existing walls/windows, doors, fittings etc to be carefully broken out as part of the refurbishment works.
	Demountable access panel to access back fill units.
	Indicative of windows to be bricked.

01

APPROVED SECOND FLOOR PLAN (07)

Scale 1:100

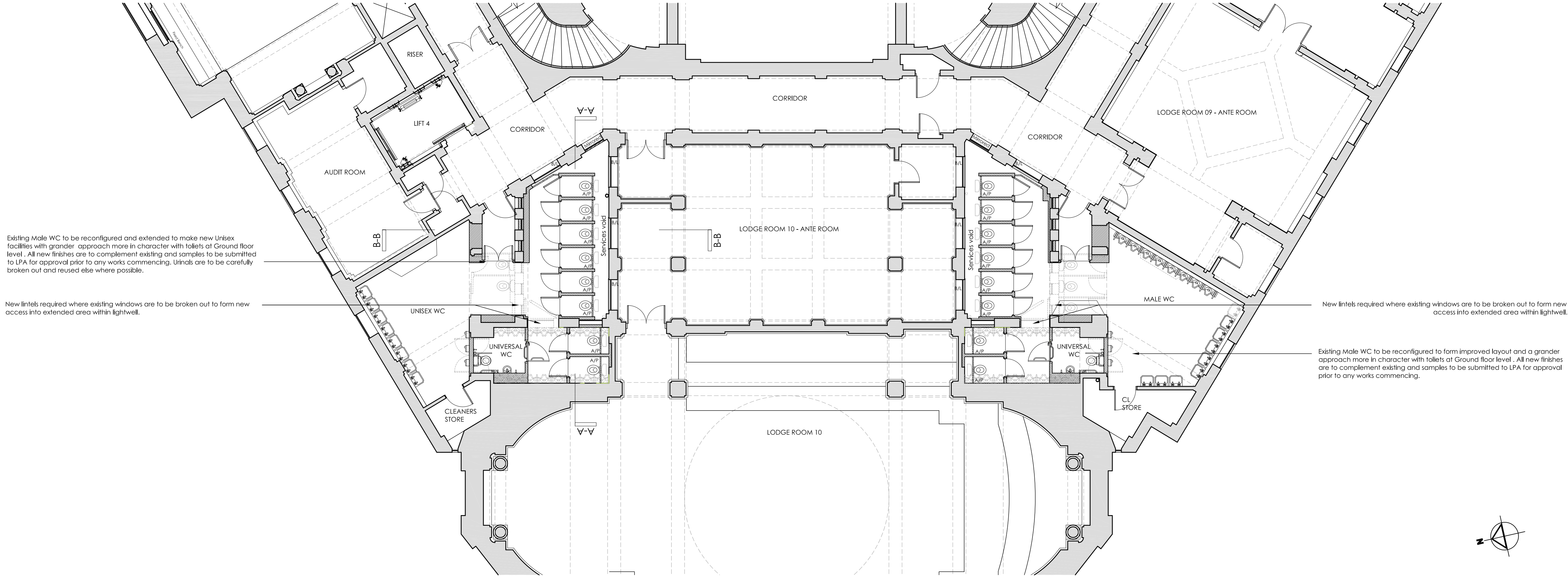

P2	06.02.13 Planning Issue Previously approved drawings from application 2012/3548/P.	CB	RD
P1	15.06.12 Planning Issue	CB	RD
Rev: Date:		Dr: Ch:	

PLANNING

Job No.	1510.01	Date.	06.12
Dwg No.	PL.053	Rev.	P2
Scale.	1:100 @A1	Drawn by.	CB
		Checked by.	RD

Client / Organisation.
Freemasons
Project.
Freemasons Hall, Great Queen Street, London, WC2B 5AZ
Dwg Title.
**APPROVED Floor Plans
Second (07) & Third (09)**

Architects and Conservation Consultants
RIBA Chartered Practice

3 King Street Cloisters, Clifton Walk,
Hammersmith, London, W6 0GY
T: 02087 483755
www.mrda.co.uk

F: 02087 483756
office@mrda.co.uk