

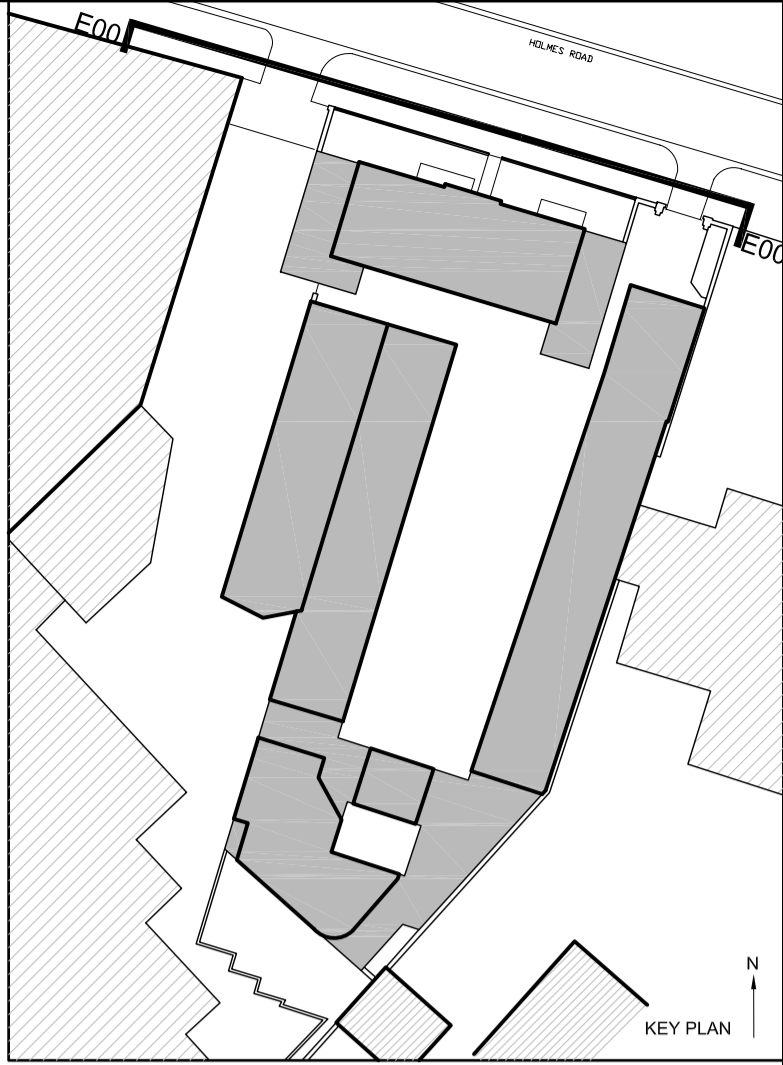

St Patrick's  
Primary School

EXISTING ELEVATION 00  
(North Elevation fronting Holmes Road)

55-57  
Holmes Road



DO NOT SCALE OFF THIS DRAWING  
ALL DIMENSIONS MUST BE CHECKED ON SITE  
INFORM THE ARCHITECT OF ANY  
DISCREPANCIES PRIOR TO CONSTRUCTION  
PLOT SIZE: A1



St Patrick's  
Primary School

PROPOSED ELEVATION 00  
(North Elevation fronting Holmes Road)

55-57  
Holmes Road

SCALE 0 metres 5 metres 10 metres

REVISIONS:  
A 15 10 12 FOR PLANNING  
B 11 02 13 UPDATED FOR PLANNING

PETER BARBER  
ARCHITECTS

173 Kings Cross Road LONDON WC1X 9BZ  
T:020 7833 4499 F:020 7833 4999  
e:architecture@peterbarberarchitects.com

JOB: 41 - 43 Holmes Road, NW5 3AN

CLIENT: London Borough of Camden

SCALE: 1/100 @ A1 DATE: 03 12

DRAWN: JP CHECKED: PB

TITLE: Existing and Proposed Elevation 00  
(North Elevation facing Holmes Road)

DRAWING NO: 100\_E\_00

REV: B