

The drawing is Copyright © of GVA Ganley Limited.  
All dimensions to be checked on schedules and Conditions in conjunction with any specifications, schedules and Conditions drawings and details.

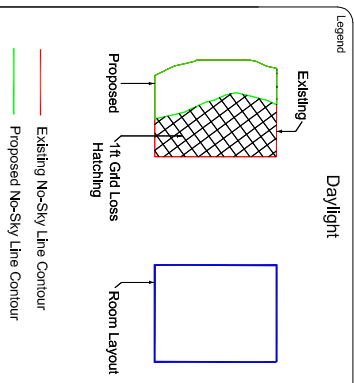

**Sources of Information**

**Existing And Surrounding Buildings:**  
MBS Survey Software Ltd 3d Survey sent 15 Sept 2012

**Proposed Scheme:**  
Karatkiewicz Carson Architects LLP 3d Model  
Sent on 23 Oct 2012 And Drawing Nos:  
202\_A\_D\_BLR\_100\_00 Rev 6  
202\_A\_D\_BLR\_100\_01 Rev 5 to 202\_A\_D\_BLR\_100\_07 Rev 5  
202\_A\_D\_BLR\_100\_08 Rev 2, 202\_A\_D\_BLR\_100\_09 Rev 03  
202\_A\_D\_BLR\_100\_00 Rev 6 to 202\_A\_D\_BLR\_100\_08 Rev 6  
202\_A\_D\_BLR\_300\_00 Rev 2 to 202\_A\_D\_BLR\_300\_04 Rev 1  
202\_A\_D\_BLR\_300\_01 Rev 2 to 202\_A\_D\_BLR\_300\_03 Rev 3  
202\_A\_D\_DHQ\_300\_02 Rev 3, 202\_A\_D\_BLR\_300\_03 Rev 3

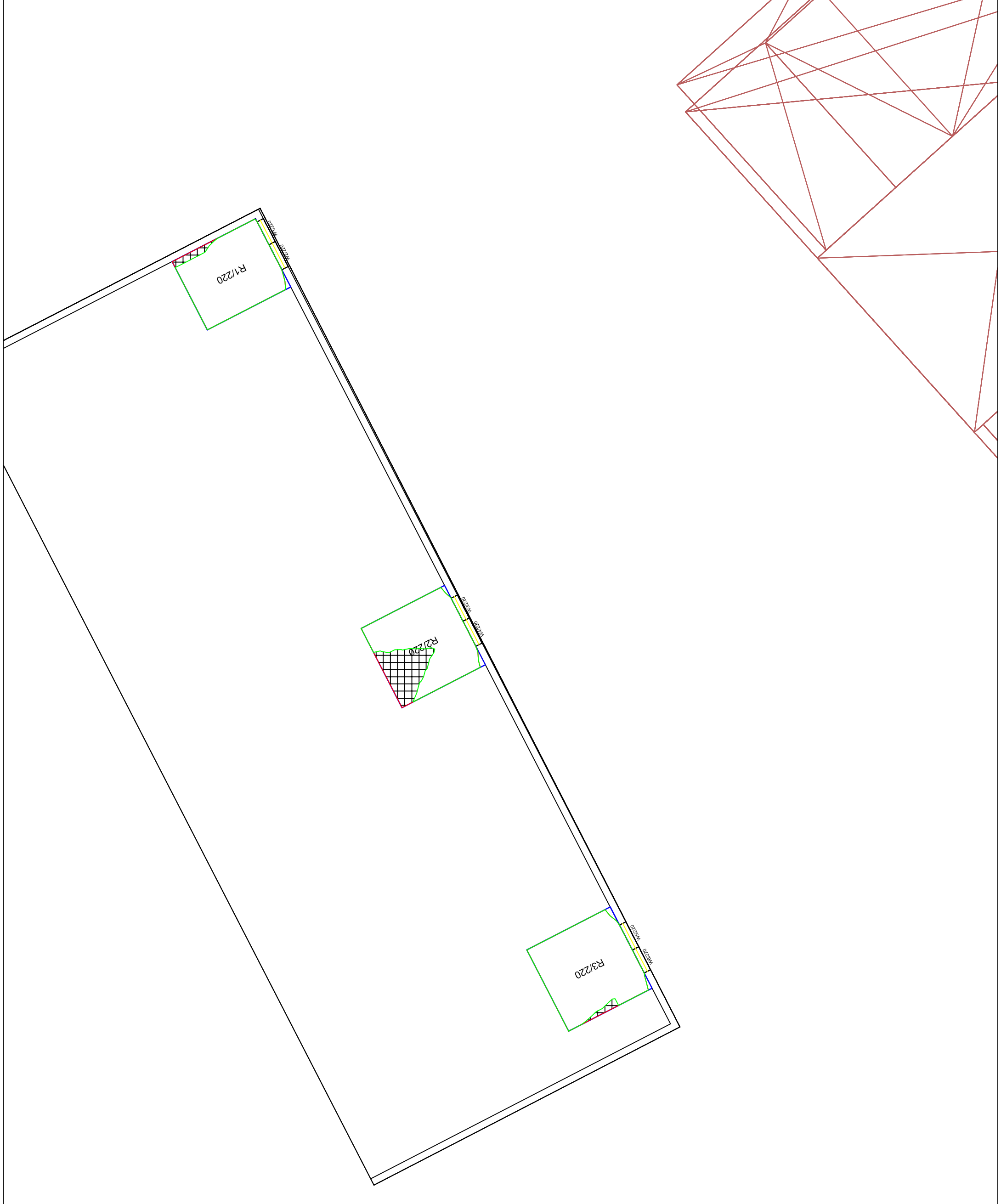

**Project Name**  
Bacton Low Rise  
Gospel Oak

**Client**  
EC Harris

**Drawing Title**  
No-Skyline Contours For  
1-49 Vicar's Road

**Drawn By**  
MO

**Scale**  
Scale @ A3  
1/150

**Date**  
28/02/2013

**Revision**  
-

**Project No.**  
BA81 - 23

**Drawing No.**  
BRE 073

**Revision**  
-

**GVA**  
08449 02 03 04  
GVA Schatunowski Brooks  
10 Stratton Street, London, W1J 8JR  
www.gva.co.uk