

1:500



General Notes

1. Dimensions are in millimetres unless stated otherwise.
2. Levels are in metres, AOD +105.02m is represented as +0.00m
3. Dimensions govern.
Do not scale off drawing.
4. All dimensions to be verified on site before proceeding.
5. All discrepancies to be notified in writing to Make Limited.

Notes

- A. ST ANTHONY'S PREPARATORY SCHOOL
B. HENDERSON COURT
C. GREENHILL
D. NORTH BRIDGE HOUSE SENIOR SCHOOL (PREVIOUSLY ROYAL SCHOOL HAMPSTEAD)
E. FITZJOHNS PRIMARY SCHOOL

 Existing structure proposed for demolition

00	28/02/13	Planning submission		
Rev	Date	Reason For Issue		Chk

	Keyplan
--	---------

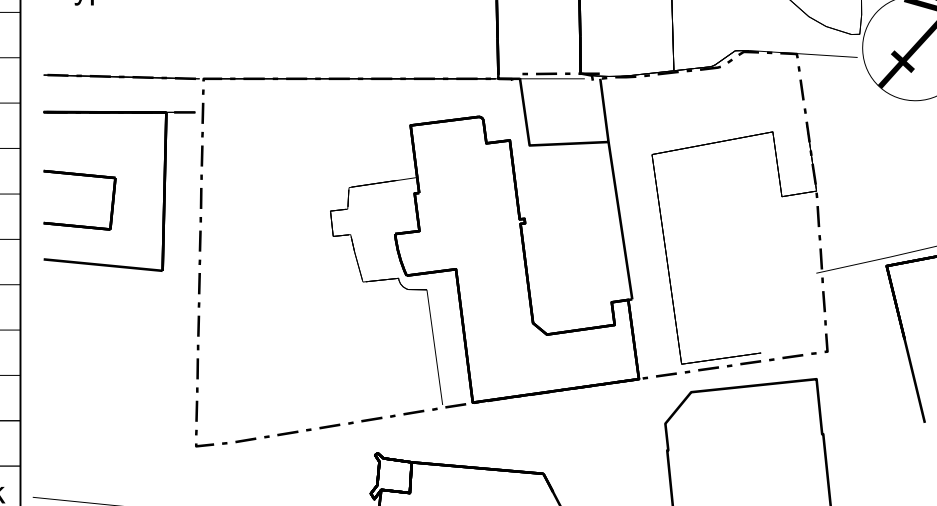

Client
Ms R Lord
Mr J Weston
92 Fitzjohn's Avenue
London
NW3 6NP

Architect
make
55-65 Whitfield Street,
London, W1T 4HE
tel +44 (0) 20 7636 5151
www.makearchitects.com

Project Name	92 Fitzjohn's Avenue, NW3
--------------	---------------------------

Drawing Title
Site demolition plan

Scale 1: 500 1: 1000	Project No
	0852

Paper Size @A1 @A3	Drawing No. A (P) 1002
--------------------------	----------------------------------

Date	01.02.2013
Rev No.	00

© Make Limited 2008