

communal staircase top half landing

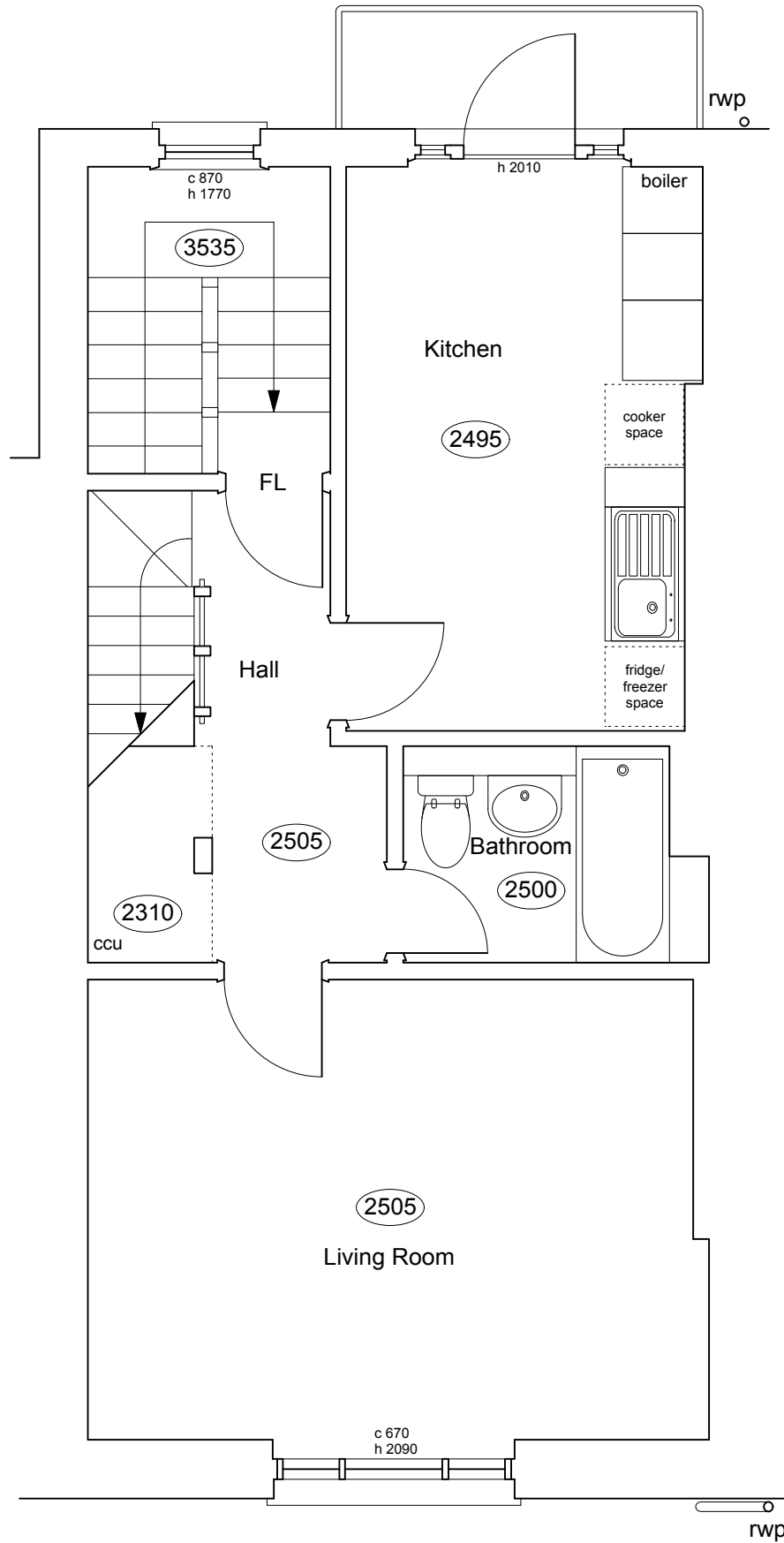

NOTE - 15 AMPTON STREET
 THERE ARE NO ORIGINAL FEATURES OF ANY KIND WHATSOEVER REMAINING IN THE PROPERTY. IT IS ASSUMED THAT THE TERRACE (15, 17 & 19) HAS BEEN ENTIRELY REBUILT, APART FROM THE FRONT ELEVATION AND PARTY WALLS.

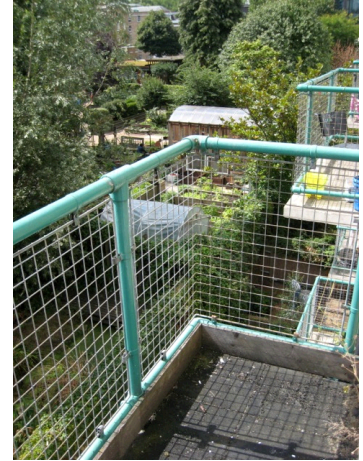

	PROJECT 5 ARCHITECTURE LLP 8 Waterson Street London E2 8HL T: +44 (0)20 7739 9131 F: +44 (0)20 7739 3687 E: info@p5a.co.uk	job title 15 AMPTON STREET, LONDON WC1X 0LT	scale 1:50 @ A3	drawn AA	drawing no. 6214-AS15-E04
	drawing 2ND FLOOR PLAN - AS EXISTING	date AUGUST 2010	checked SA		