

CONSTRUCTION KEY	
	existing retained
	line over/under/behind
	demolished
	new construction

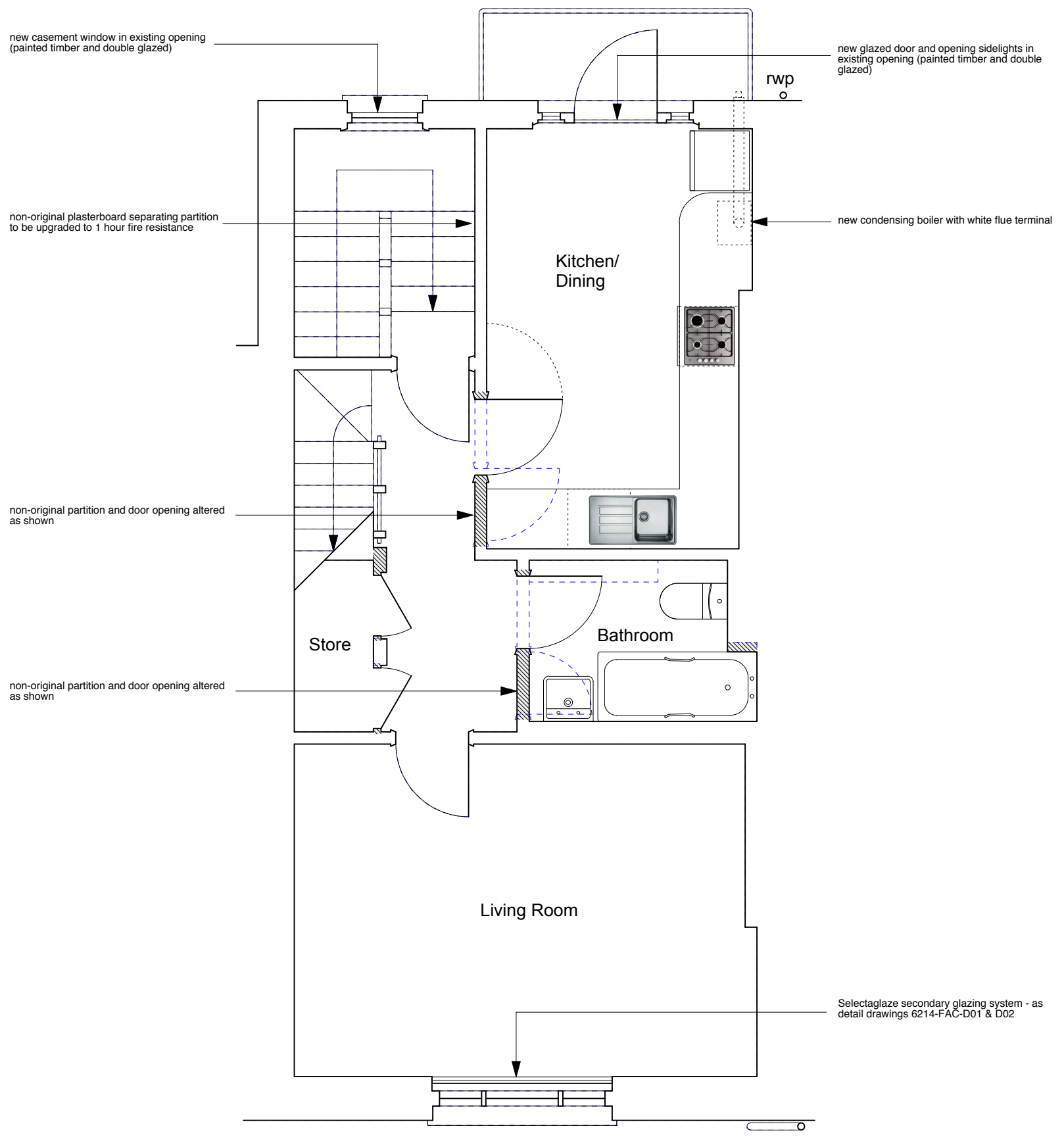

NOTE:
All ceiling plasterboard to be replaced throughout the second floor (1 hour fire resisting) on resilient bars
All internal doors renewed as solid timber flush fire doors



	PROJECT 5 ARCHITECTURE LLP 8 Waterson Street London E2 8HL T: +44 (0)20 7739 9131 F: +44 (0)20 7739 3687 E: info@p5a.co.uk	job title 15 AMPTON STREET, LONDON WC1X 0LT	scale 1:50 @ A3	drawn SA	drawing no. 6214-AS15-P04
	drawing 2ND FLOOR PLAN - PROPOSED	date NOV 2012	checked		