

CONSTRUCTION KEY

- existing retained
- line over/under/behind
- demolished
- new construction

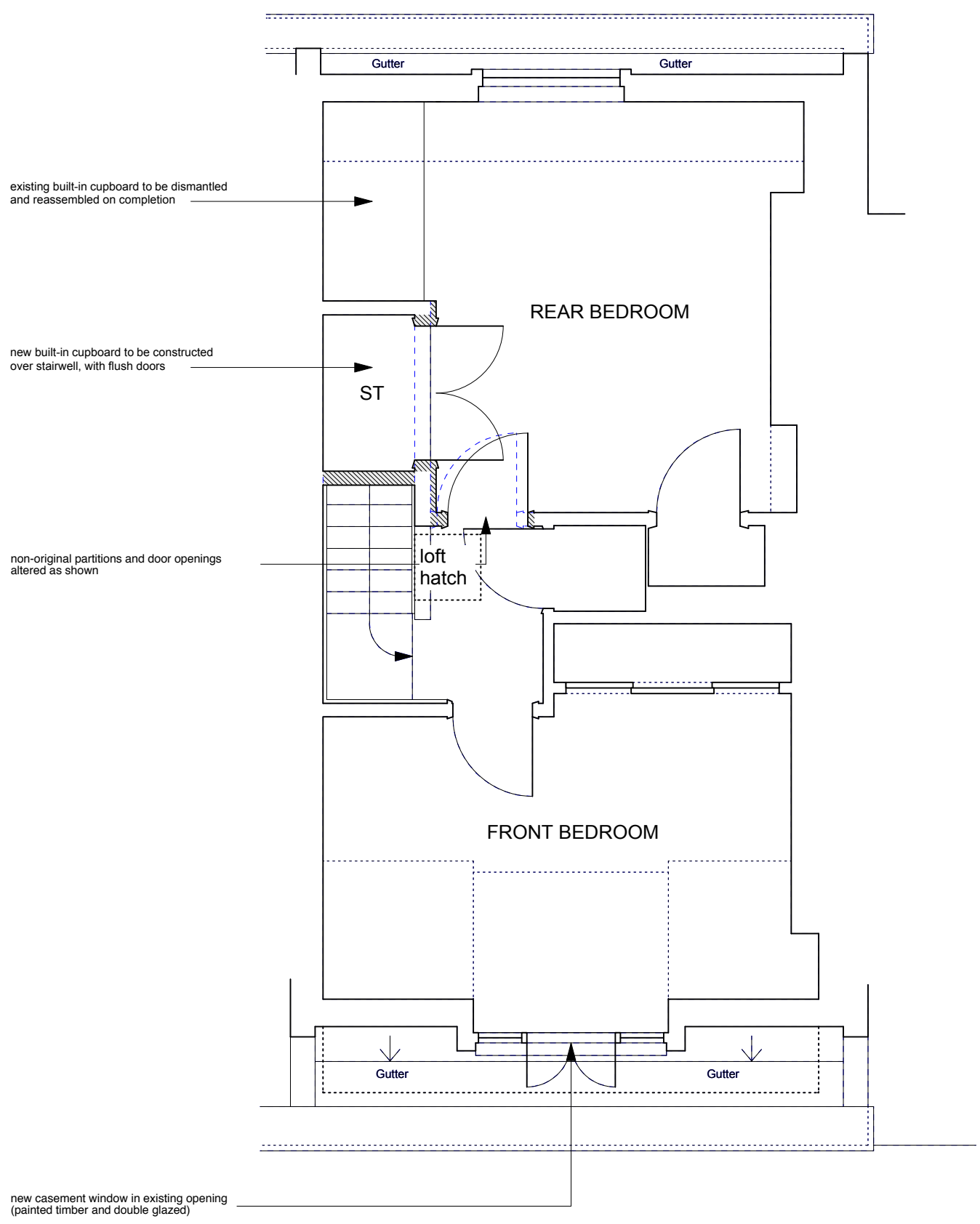

NOTE:
 All ceiling plasterboard to be replaced throughout the third floor (1/2 hour fire resisting)
 All internal doors renewed as solid timber flush fire doors



Rev.B - 29/01/2013 - EXISTING BUILT-IN CUPBOARD ADDED IN REAR BEDROOM

	PROJECT 5 ARCHITECTURE LLP 8 Waterson Street London E2 8HL T: +44 (0)20 7739 9131 F: +44 (0)20 7739 3687 E: info@p5a.co.uk	job title 19 AMPTON STREET, LONDON WC1X 0LT drawing ATTIC (3RD FLOOR) PLAN - PROPOSED	scale 1:50 @ A3 date NOVEMBER 2012	drawn checked XX	6214-AS19-P05B