

© bere:architects 2012

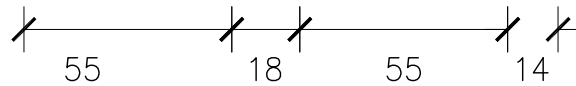

Bayer triple-glazed timber frame sliding sash window  
U-value of 0.81 W/m²K

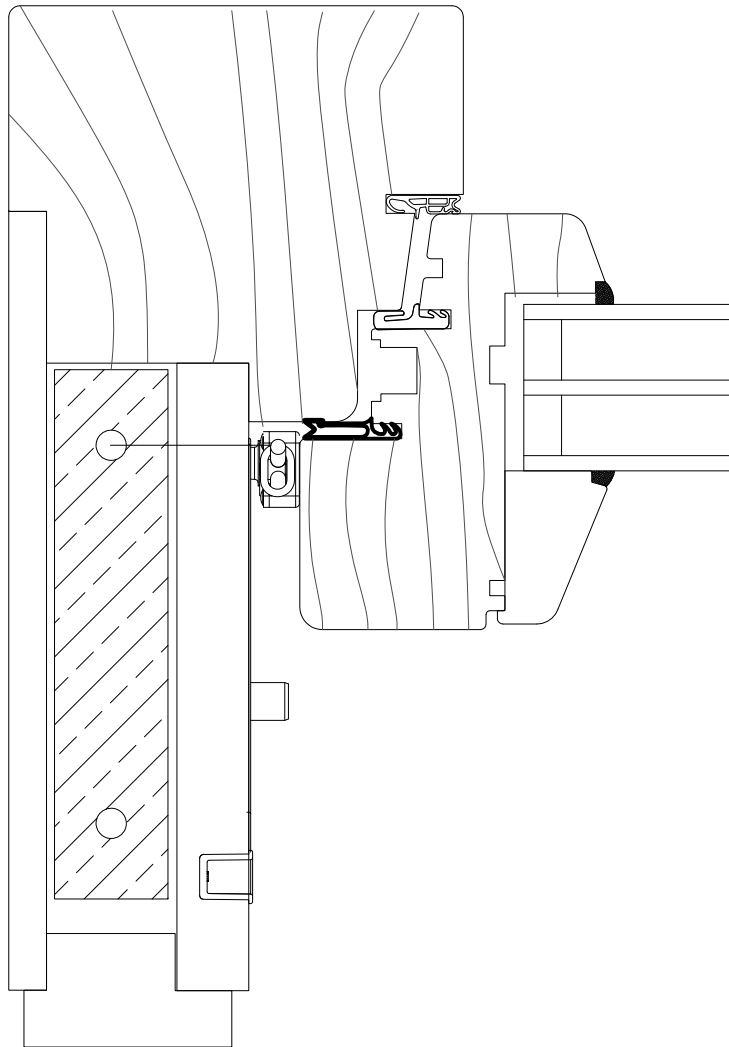
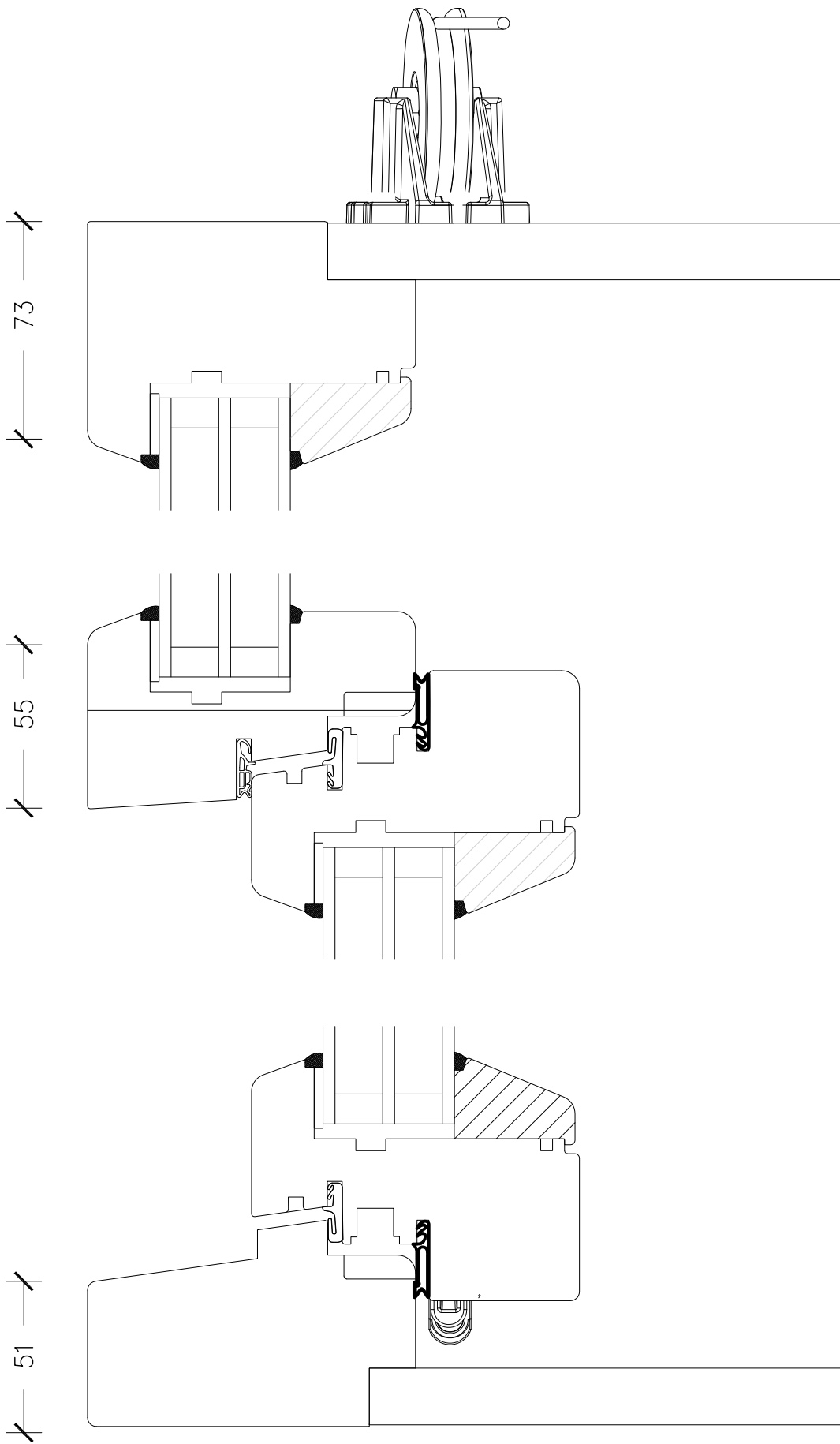
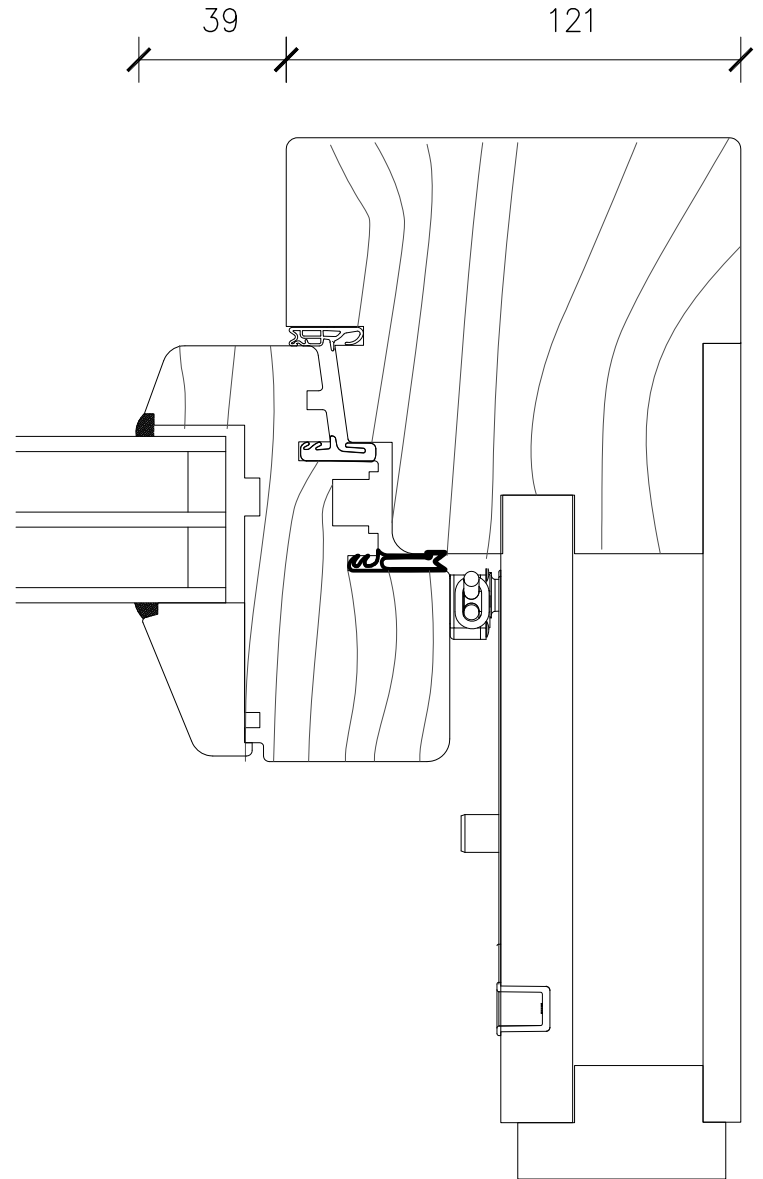

- 1 Use figured dimensions only
- 2 Do not scale from this drawing
- 3 All dimensions to be checked on site and the Architect to be informed of any discrepancies before construction commences
- 4 All references to drawings refer to current revision of that drawing
- 5 Structural and services information shown is indicative only. Refer to consultants' drawings for details and setting out
- 6 All work and materials to be in accordance with current applicable statutory legislation and to comply with all relevant codes of practice and British and European standards

Rev	Description	Date	By	Chk
A	Planning Issue	15.11.12	LK	CS
B	Rear Insulated Sliding Sash	02.04.13	JO	CS

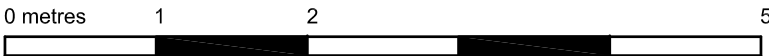

PLANNING

PROPOSED

**Project:** 52 Belsize Park Gardens  
Belsize Park

**Subject:** Typical Rear Window Profile  
Bayer Sliding Sash

**Scale:** 1:2 @ A3

**Date:** 11.10.12

**bere:architects**

Mildmay Centre, Woodville Road, London, N16 8NA  
T +44 (0)20 7241 1064 bere@bere.co.uk www.bere.co.uk

Project	Drawing	Rev
---------	---------	-----

414.B5.G32.W02 B