

SECTION A-A

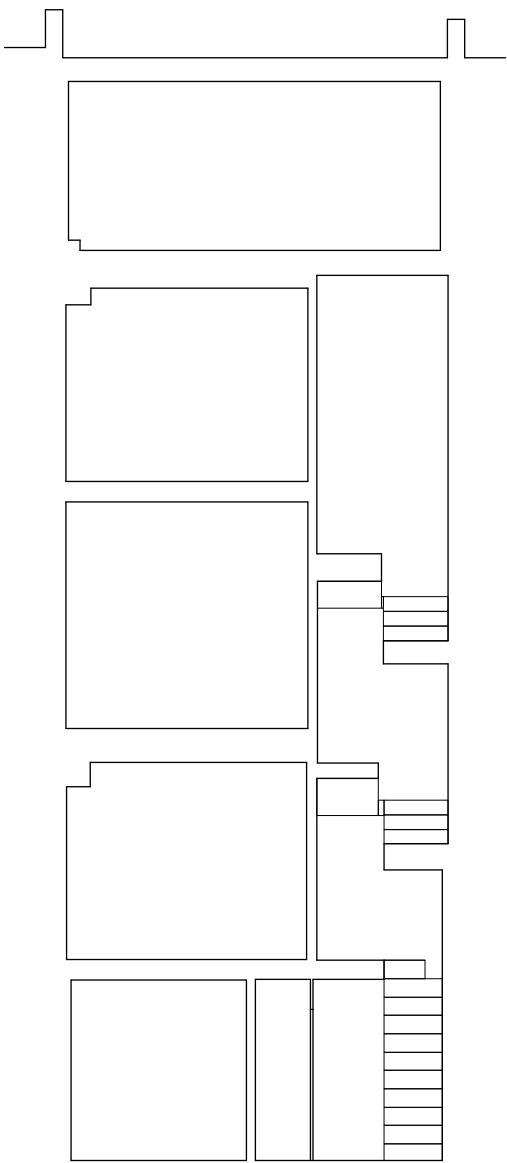

SECTION B-B

20.00 AAD

20.00 AAD

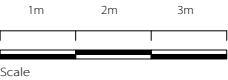

DESIGN ISSUE	
<p>NOTES:</p> <p>All dimensions must be confirmed on site and verified with the Architect. Any discrepancies on the drawing must be reported to the Architect prior to any works being carried out on site. Do not scale off drawing.</p> <p>The copyright of this schedule / drawing remains with the Architect. No part of this schedule / drawing may be reproduced in any form or by any means without the written permission of Nicholas Lee Architects.</p>	
Project: 117 Albert Street	
Drawing Title: Sections A-A and B-B	
Drawing No: 1209/ES-001	
Date: 28.03.13	Scale: 1:100 @ A3
<p>NICHOLAS LEE ARCHITECTS 34A Rosslyn Hill, London NW3 1NH Tel: 020 7435 9315</p>	