

EXISTING GROUND FLOOR PLAN

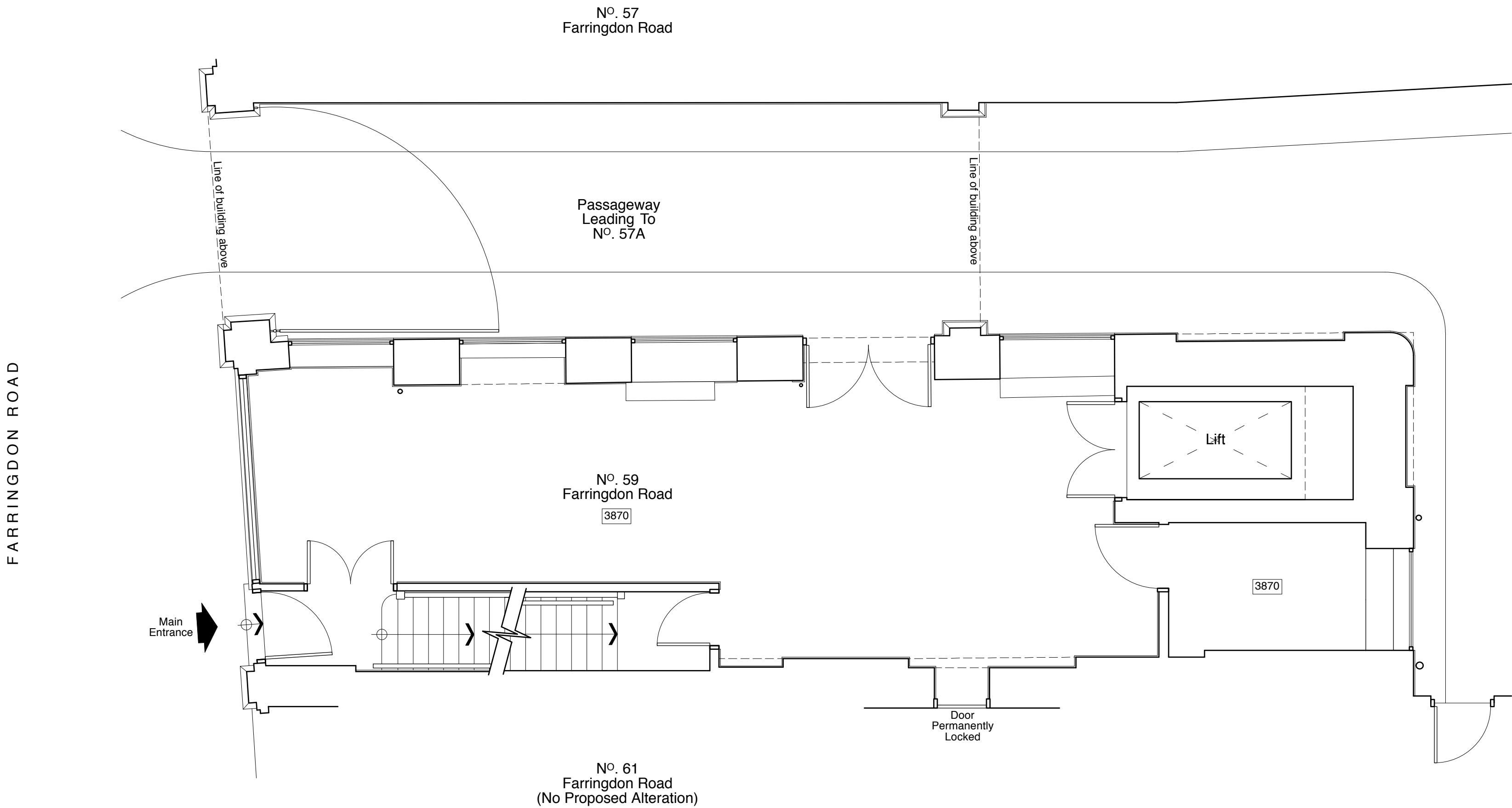

rev.	date	notes
© gpad ltd.		
gpad architecture & interior design		
CLIENT KENRIGHT PROPERTIES LTD		
PROJECT ZEPPELIN BUILDING 59-61 FARRINGDON ROAD LONDON EC1M 3JB		
TITLE EXISTING GROUND FLOOR PLAN		
DWG NO	398-PA.08	REV
DRAWN BY	J.W	SCALE 1:50@A2
CHECKED BY		DATE March 2013
T: 020 7549 2133 Unit 1 F: 020 7549 2144 9a Dollington Street E: info@gpadltd.com Clerkenwell W: www.gpadltd.com London EC1V 0BQ		
This drawing is the copyright of gpad ltd. Not to be reproduced, retained or disclosed to any unauthorised person either wholly or in part without written permission. Do not scale of this drawing. All indicated dimensions to be checked and verified on site by the contractor before commencement of any fabrication, drawings or work whatsoever on site. Report any discrepancies to the Architect immediately. Drawings to be read in conjunction with relevant drawings and specification.		
FILE NAME	PRINT SIZE	A2