

All dimensions and levels to be checked by the contractor on site. This drawing is the property of RS Architects and is not to be reproduced.

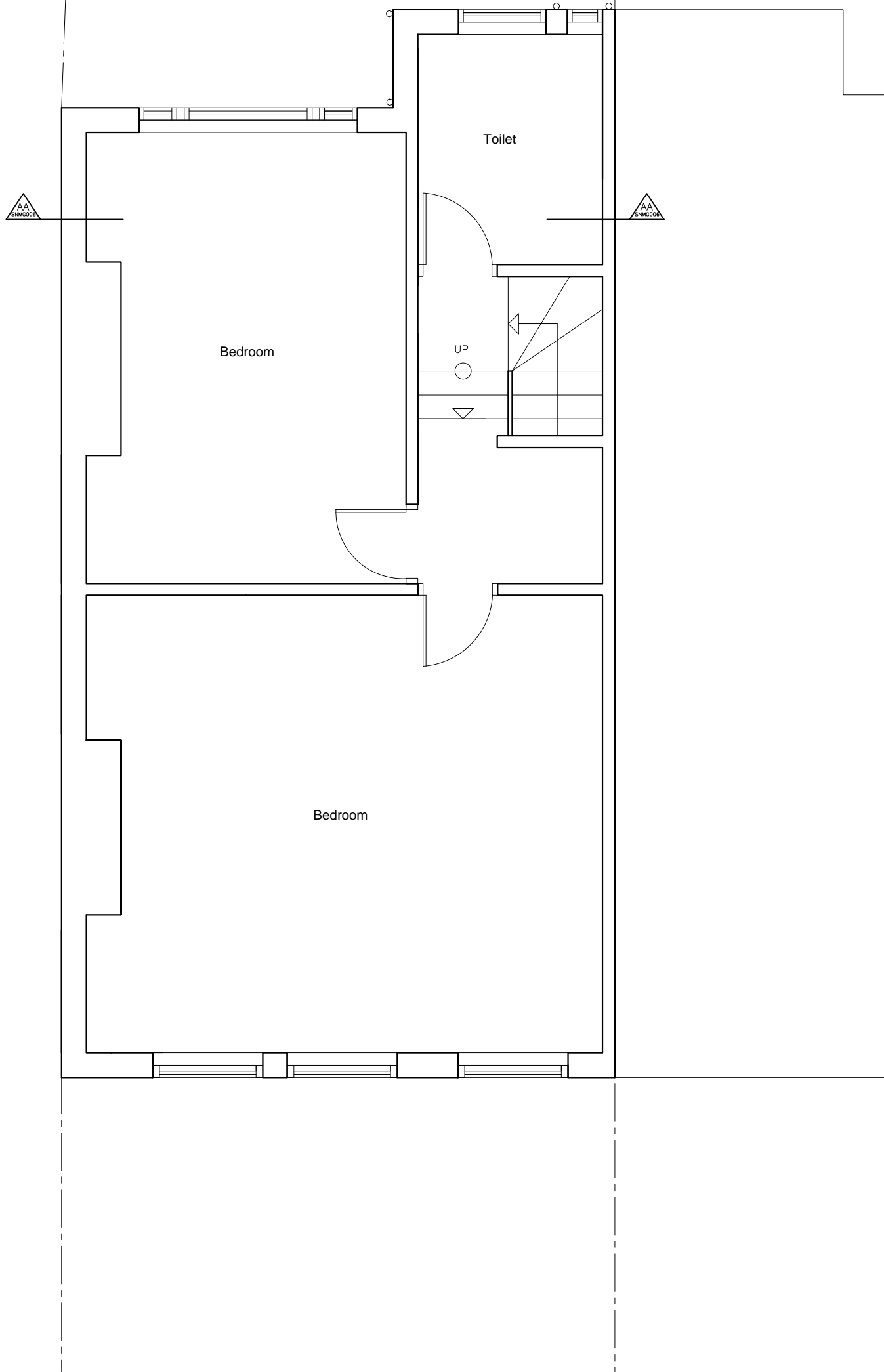

RS Architects 31 Keneme Drive Barnet EN5 2NW
www.rsarchitects.co.uk 020 8449 5441

PROJECT	1 Maygrove Road, London, NW6 2EE		
TITLE	Existing Second Floor Plan		
DATE	April 2013	DRAWN	NB
SCALE	1:50 @ A3	CHECK	RS
STATUS	Planning		
DWG NO.	SN MG 005	REV	A

