

This drawing has been prepared for Planning purposes only and should not be used for construction purposes.

All figured dimensions are in millimetres

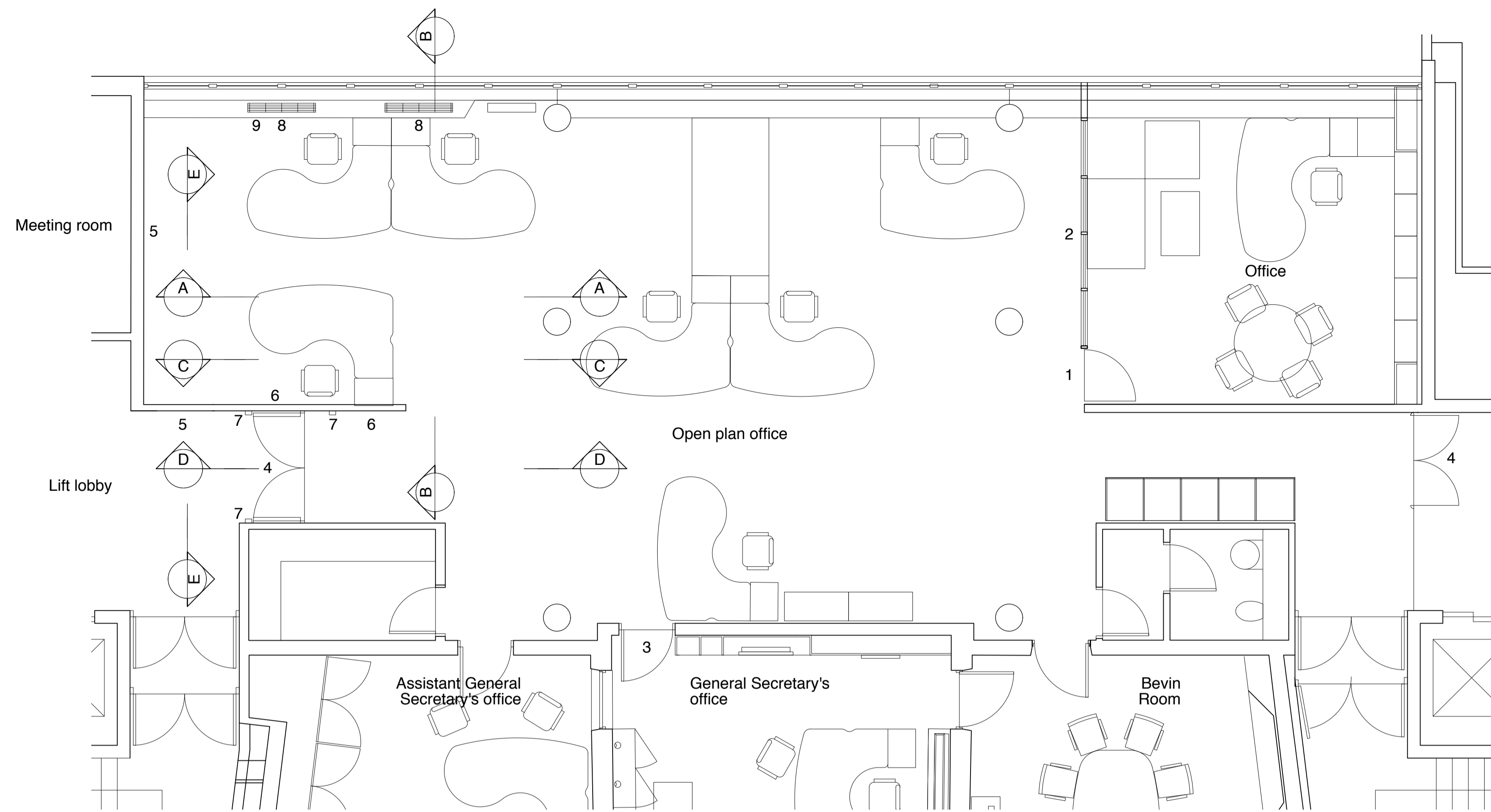

EXISTING FOURTH FLOOR PLAN
1:50 @ A1

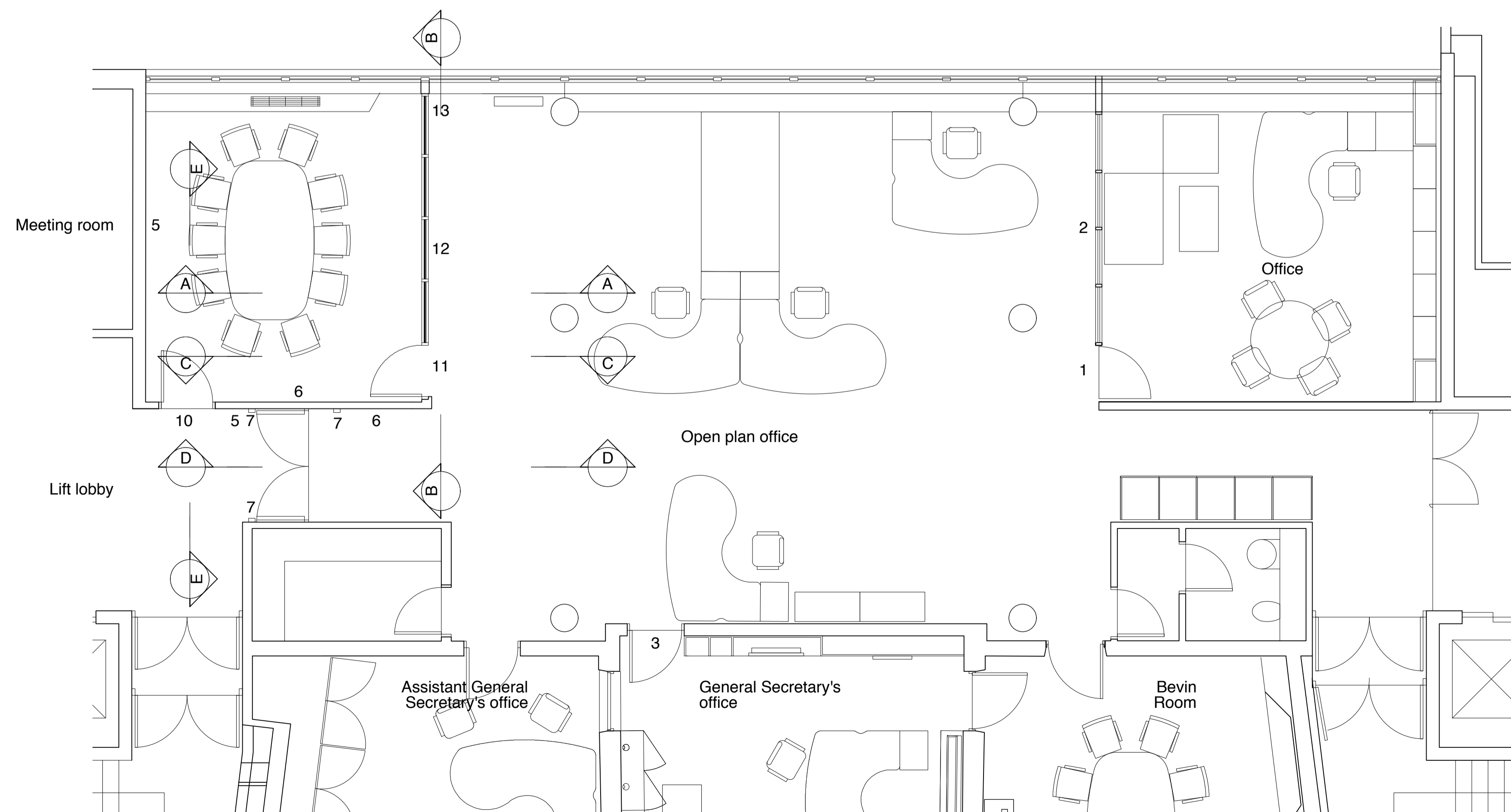

PROPOSED FOURTH FLOOR PLAN
1:50 @ A1

Key

- 1 Solid veneer door to office (installed in 1980s)
- 2 Glass partition with intergral blinds (installed in 1980s)
- 3 Entrance to general secretary office
- 4 Entrance from lift/stair lobby
- 5 Plaster wall
- 6 Lebanese Cedar veneer
- 7 Security card reader for door
- 8 Fan coil unit
- 9 Existing veneer housing to fan coil unit
- 10 Proposed meeting room door to provide direct access to meeting room to TUC staff. Door and frame to match existing doors to general secretary's offices.
- 11 Solid cedar veneer door to meeting room in hardwood frame to match doors to General secretary's offices.
- 12 Glazed acoustic partition with integral blinds
- 13 Fan coil unit removed and existing veneer housing adapted to suit.



Key plan and north key

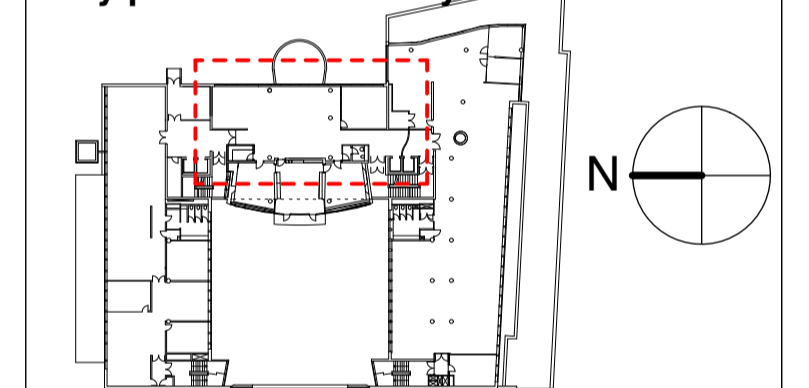

Rev	Description	Drawn	Date
P	Planning	OP	08.05.13

Trades Union Congress
Congress House Refurbishment
Existing and Proposed Fourth Floor Plans
Status: Planning
Scale 1:50@A1, 1:100@A3
May 2013

Draw N° 186_P_20	Rev P
Drawn by OP	Authorised by AK Size A1

HUGHBROUGHTONARCHITECTS
41a Beavor Lane London W6 9BL
T 020 8735 9959 F 020 8563 3891 E info@hbarchitects.co.uk
© Hugh Broughton Architects Ltd