

Diese Zeichnung ist unser Eigentum. Jede Vervielfältigung, Verwertung oder Weitergabe an Dritte Personen ist verboten und wird verfolgt.

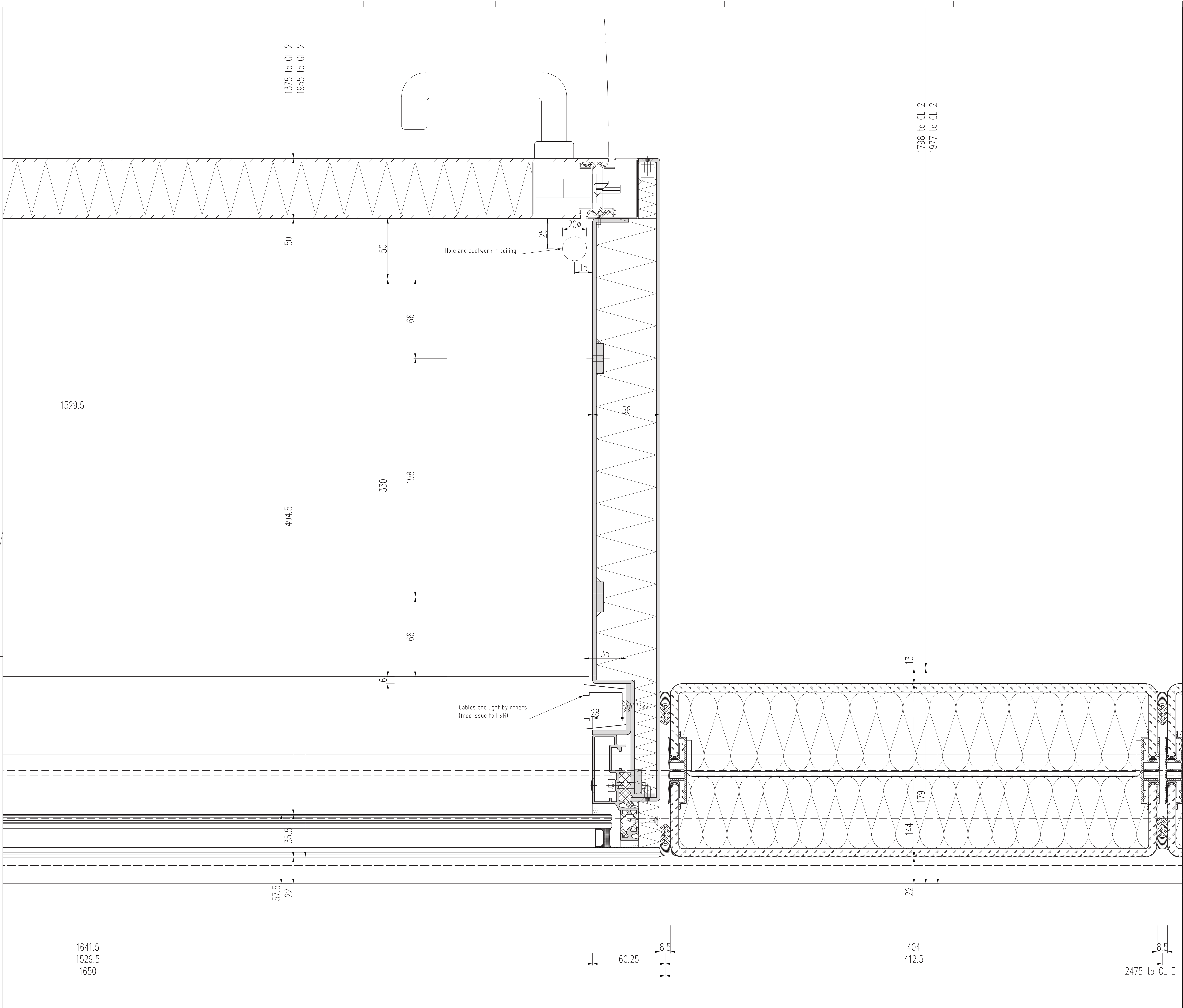

# Horizontal detail 2197

Type 1b+4b, Level 00

IRAL-08-CL-2197

Site plan showing the location of the detail within the building footprint.

04	No revision	REBA	15.01.13
03	see revision cloud	REBA	14.11.12
02	Electrical information added	REBA	28.09.12
01	General revision	REBA	23.08.12

REV.	Description	Subject	Name	Date
04	No revision		REBA	15.01.13
03	see revision cloud		REBA	14.11.12
02	Electrical information added		REBA	28.09.12
01	General revision		REBA	23.08.12

**CLIENT**  
UCL Howland Street

**ARCHITECT**  
Ian Ritchie Architects

**BUILDING LOCATION**  
—

**DESCRIPTION**  
Horizontal detail 2197  
Type 1b+4b, Level 00

**DESIGNED** REBA  
**DATE** 27.07.2012  
**SCALE** A0B1:1  
**APPROVAL** —  
**PROJECT No.** 201142-AB02

The drawing and its contents are the property of F&R and may not be reproduced or passed to third parties without our written permission.

**PROJECT & BUILDING INFORMATION**  
Project: 201142-AB02  
Building: UCL Howland Street  
Drawing: 2197  
Scale: A0B1:1  
Version: 04

**PROJECT & BUILDING INFORMATION**  
Project: 201142-AB02  
Building: UCL Howland Street  
Drawing: 2197  
Scale: A0B1:1  
Version: 04

0 20 40 60 80 100 110

11

90

70

50

30

10

1641.5

1529.5

1650

1798 to GL 2

1977 to GL 2

1375 to GL 2

1955 to GL 2

50

50

66

330

198

56

494.5

1529.5

6

66

35

28

13

179

144

22

57.5

22

35.5

60.25

8.5

404

412.5

8.5

2475 to GL E

Hole and ductwork in ceiling

Cables and light by others (free issue to F&R)

25

200

15

11

90

70

50

30

10

1641.5

1529.5

1650

1798 to GL 2

1977 to GL 2

1375 to GL 2

1955 to GL 2

50

50

66

330

198

56

494.5

1529.5

6

66

35

28

13

179

144

22

57.5

22

35.5

60.25

8.5

404

412.5

8.5

2475 to GL E

Hole and ductwork in ceiling

Cables and light by others (free issue to F&R)

25

200

15

11

90

70

50

30

10

1641.5

1529.5

1650

1798 to GL 2

1977 to GL 2

1375 to GL 2

1955 to GL 2

50

50

66

330

198

56

494.5

1529.5

6

66

35

28

13

179

144

22

57.5

22

35.5

60.25

8.5

404

412.5

8.5

2475 to GL E

Hole and ductwork in ceiling

Cables and light by others (free issue to F&R)

25

200

15

11

90

70

50

30

10

1641.5

1529.5

1650

1798 to GL 2

1977 to GL 2

1375 to GL 2

1955 to GL 2

50

50

66

330

198

56

494.5

1529.5

6

66

35

28

13

179

144

22

57.5

22

35.5

60.25

8.5

404

412.5

8.5

2475 to GL E

Hole and ductwork in ceiling

Cables and light by others (free issue to F&R)

25

200

15

11

90

70

50

30

10

1641.5

1529.5

1650

1798 to GL 2

1977 to GL 2

1375 to GL 2

1955 to GL 2

50

50

66

330

198

56

494.5

1529.5

6

66

35

28

13

179

144

22

57.5

22

35.5

60.25

8.5

404

412.5

8.5

2475 to GL E

Hole and ductwork in ceiling

Cables and light by others (free issue to F&R)

25

200

15

11

90

70

50

30

10

1641.5

1529.5

1650

1798 to GL 2

1977 to GL 2

1375 to GL 2

1955 to GL 2

50

50

66

330

198

56

494.5

1529.5

6

66

35

28

13

179

144

22

57.5

22

35.5

60.25

8.5

404

412.5

8.5

2475 to GL E

Hole and ductwork in ceiling

Cables and light by others (free issue to F&R)

25

200

15

11

90

70

50

30

10

1641.5

1529.5

1650

1798 to GL 2

1977 to GL 2

1375 to GL 2

1955 to GL 2

50

50

66

330

198

56

494.5

1529.5

6

66

35

28

13

179

144

22

57.5

22

35.5

60.25

8.5

404

412.5

8.5

2475 to GL E

Hole and ductwork in ceiling

Cables and light by others (free issue to F&R)

25

200

15

11

90

70

50

30

10

1641.5

1529.5

1650

1798 to GL 2

1977 to GL 2

1375 to GL 2

1955 to GL 2

50

50

66

330

198

56

494.5

1529.5

6

66

35

28

13

179

144

22

57.5

22

35.5

60.25

8.5

404

412.5

8.5

2475 to GL E

Hole and ductwork in ceiling

Cables and light by others (free issue to F&R)

25

200

15

11

90

70

50

30

10

1641.5

1529.5

1650

1798 to GL 2

1977 to GL 2

1375 to GL 2

1955 to GL 2

50

50

66

330

198

56

494.5

1529.5

6

66

35

28

13

179

144

22

57.5

22

35.5

60.25

8.5

404

412.5

8.5

2475 to GL E

Hole and ductwork in ceiling

Cables and light by others (free issue to F&R)

25

200

15

11

90

70

50

30

10

1641.5

1529.5

1650

1798 to GL 2

1977 to GL 2

1375 to GL 2

1955 to GL 2

50

50

66

330

198

56

494.5

1529.5

6

66

35

28

13

179

144

22

57.5

22

35.5

60.25

8.5

404

412.5

8.5

2475 to GL E

Hole and ductwork in ceiling

Cables and light by others (free issue to F&R)

25

200

15

11

90

70

50

30

10

1641.5

1529.5

1650

1798 to GL 2

1977 to GL 2

1375 to GL 2

1955 to GL 2

50

50

66

330

198

56

494.5

1529.5

6

66

35

28

13

179

144

22

57.5

22

35.5

60.25

8.5

404

412.5

8.5

2475 to GL E

Hole and ductwork in ceiling

Cables and light by others (free issue to F&R)

25

200

15

11

90

70

50

30

10

1641.5

1529.5

1650

1798 to GL 2

1977 to GL 2

1375 to GL 2

1955 to GL 2

50

50

66

330

198

56

494.5

1529.5

6

66

35

28

13

179

144

22

57.5

22

35.5

60.25

8.5

404

412.5

8.5

2475 to GL E

Hole and ductwork in ceiling

Cables and light by others (free issue to F&R)

25

200

15

11

90

70

50

30

10

1641.5

1529.5

1650

1798 to GL 2

1977 to GL 2

1375 to GL 2

1955 to GL 2

50

50

66

330

198

56

494.5

1529.5

6

66

35

28

13

179

144

22

57.5

22

35.5

60.25

8.5

404

412.5

8.5

2475 to GL E

Hole and ductwork in ceiling

Cables and light by others (free issue to F&R)

25

200

15

11

90

70

50

30

10

1641.5

1529.5

1650

1798 to GL 2

1977 to GL 2

1375 to GL 2

1955 to GL 2

50

50

66

330

198

56

494.5

1529.5

6

66

35

28

13

179

144

22

57.5

22

35.5

60.25

8.5

404

412.5

8.5

2475 to GL E

Hole and ductwork in ceiling

Cables and light by others (free issue to F&R)

25

200

15

11

90

70

50

30

10

1641.5

1529.5

1650

1798 to GL 2

1977 to GL 2

1375 to GL 2

1955 to GL 2

50

50

66

330

198

56

494.5

1529.5

6

66

35

28

13

179

144

22

57.5

22

35.5

60.25

8.5

404

412.5

8.5

2475 to GL E

Hole and ductwork in ceiling

Cables and light by others (free issue to F&R)

25

200

15

11

90

70

50

30

10

1641.5

1529.5

1650

1798 to GL 2

1977 to GL 2

1375 to GL 2

1955 to GL 2

50

50

66

330

198

56

494.5

1529.5

6

66

35

28

13

179

144

22

57.5

22

35.5

60.25

8.5

404

412.5

8.5

2475 to GL E

Hole and ductwork in ceiling

Cables and light by others (free issue to F&R)

25

200

15

11

90

70

50

30

10

1641.5

1529.5

1650

1798 to GL 2

1977 to GL 2

1375 to GL 2

1955 to GL 2

50

50

66

330

198

56

494.5

1529.5

6

66

35

28

13

179

144

22

57.5

22

35.5

60.25

8.5

404

412.5

8.5

2475 to GL E

Hole and ductwork in ceiling

Cables and light by others (free issue to F&R)

25

200

15

11

90

70

50

30

10

1641.5

1529.5

1650

1798 to GL 2

1977 to GL 2

1375 to GL 2

1955 to GL 2

50

50

66

330

198

56

494.5

1529.5

6

66

35

28

13

179

144

22

57.5

22

35.5

60.25

8.5

404

412.5

8.5

2475 to GL E

Hole and ductwork in ceiling

Cables and light by others (free issue to F&R)

25

200

15

11

90

70

50

30

10

1641.5

1529.5

1650

1798 to GL 2

1977 to GL 2

1375 to GL 2

1955 to GL 2

50

50

66

330

198

56

494.5

1529.5

6

66

35

28

13

179

144

22

57.5

22

35.5

60.25

8.5

404

412.5

8.5

2475 to GL E

Hole and ductwork in ceiling

Cables and light by others (free issue to F&R)

25

200

15

11

90

70

50

30

10

1641.5

1529.5

1650

1798 to GL 2

1977 to GL 2

1375 to GL 2

1955 to GL 2

50

50

66

330

198

56

494.5

1529.5

6

66

35

28

13

179

144

22

57.5

22

35.5

60.25

8.5

404

412.5

8.5

2475 to GL E

Hole and ductwork in ceiling

Cables and light by others (free issue to F&R)

25

200

15

11

90

70

50

30

10

1641.5

1529.5

1650

1798 to GL 2

1977 to GL 2

1375 to GL 2

1955 to GL 2

50

50

66

330

198

56

494.5

1529.5

6

66

35

28

13

179

144

22

57.5

22

35.5

60.25

8.5

404

412.5

8.5

2475 to GL E

Hole and ductwork in ceiling

Cables and light by others (free issue to F&R)

25

200

15

11

90

70

50

30

10

1641.5

1529.5

1650

1798 to GL 2

1977 to GL 2

1375 to GL 2

1955 to GL 2

50

50

66

330

198

56

494.5

1529.5

6

66

35

28

13

179

144

22

57.5

22

35.5

60.25

8.5

404

412.5

8.5

2475 to GL E

Hole and ductwork in ceiling

Cables and light by others (free issue to F&R)

25

200

15

11

90

70

50

30

10

1641.5

1529.5

1650

1798 to GL 2

1977 to GL 2

1375 to GL 2

1955 to GL 2

50

50

66

330

198

56

494.5

1529.5

6

66

35

28

13

179

144

22

57.5

22

35.5

60.25

8.5

404

412.5

8.5

2475 to GL E

Hole and ductwork in ceiling

Cables and light by others (free issue to F&R)

25

200

15

11

90

70

50

30

10

1641.5

1529.5

1650

1798 to GL 2

1977 to GL 2

1375 to GL 2

1955 to GL 2

50

50

66

330

198

56

494.5

1529.5

6

66

35

28

13

179

144

22

57.5

22

35.5

60.25

8.5

404

412.5

8.5

2475 to GL E

Hole and ductwork in ceiling

Cables and light by others (free issue to F&R)

25

200

15

11

90

70

50

30

10

1641.5

1529.5

1650

1798 to GL 2

1977 to GL 2

1375 to GL 2

1955 to GL 2

50

50

66

330

198

56

494.5

1529.5

6

66

35

28

13

179

144

22

57.5

22

35.5

60.25

8.5

404

412.5

8.5

2475 to GL E

Hole and ductwork in ceiling

Cables and light by others (free issue to F&R)

25

200

15

11

90

70

50

30

10

1641.5

1529.5

1650

1798 to GL 2

1977 to GL 2

1375 to GL 2

1955 to GL 2

50

50

66

330

198

56

494.5

1529.5

6

66

35

28

13

179

144

22

57.5

22

35.5

60.25

8.5

404

412.5

8.5

2475 to GL E

Hole and ductwork in ceiling

Cables and light by others (free issue to F&R)

25

200

15

11

90

70

50

30

10

1641.5

1529.5

1650

1798 to GL 2

1977 to GL 2

1375 to GL 2

1955 to GL 2

50

50

66

330

198

56

494.5

1529.5

6

66

35

28

13

179

144

22

57.5

22

35.5

60.25

8.5

404

412.5

8.5

2475 to GL E

Hole and ductwork in ceiling

Cables and light by others (free issue to F&R)

25

200

15

11

90

70

50

30

10

1641.5

1529.5