



SITE PLAN:
scale: 1:200



BLOCK PLAN:
scale: 1:1250

THE SITE



NOTE:
c Crown copyright. All rights reserved.
Licence number: AR 100020449

Rev.

Scale: as shown.
Date: 01/07
Drawn: L.J.S.

Job
**195 ALBANY STREET
LONDON NW1 4AR**

Drawing No.
5/712/01.

FARROW SILVERTON
CHARTERED ARCHITECTS & DESIGN CONSULTANTS

**6 HALE LANE MILL HILL
LONDON NW7 3NX**
tel: 020-8906 8502 fax: 020-8906 8503
e-mail: Farsil@aol.com

NOTE:

EACH SEPARATE DWELLING IS TO BE PROVIDED WITH A SUITABLE NUMBER OF MAINS OPERATED SELF-CONTAINED SMOKE ALARMS IN AREAS AS INDICATED ON THE DRAWING.

SELF-CONTAINED SMOKE ALARMS TO BE INTERCONNECTED WITHIN EACH DWELLING WHERE MORE THAN ONE ALARM IS NEEDED.

THE OWNER IS TO PROVIDE THE OCCUPANTS WITH THE NECESSARY INFORMATION ON THE USE & MAINTENANCE OF THE SMOKE ALARM EQUIPMENT.

MAIN ENTRANCE HALLWAY TO HAVE 1/2 HR. F.R. CONSTRUCTION & HAVE SELF-CLOSING FIRE DOORS TYPE FD20.. ANY GLAZING SHOULD BE FIRE-RESISTING & RESTRICTED TO FANLIGHTS & TO DOOR PANELS ABOVE 1.1m LIMITATIONS ON THE USE OF UNINSULATED GLAZED ELEMENTS. REFER TO TABLE A APPENDIX A OF THE APPROVED DOCUMENT B. FIRE SAFETY.

UNIT ENTRANCE DOORS SHOULD BE SELF-CLOSING FIRE-RESISTING TYPE FD30S WITH SMOKE SEALS WITH NO GLAZING. REFER FIRE DOORS TABLE B1 & APPENDIX A TABLE A4 OF THE APPROVED DOCUMENT.

THE STAIRWELLS TO HAVE OPENABLE WINDOWS AT EACH STOREY LEVEL OR ALTERNATIVELY A 1.0 sq. m. TOP VENTILATOR WHICH IS EITHER PERMANENTLY OPEN OR OPERATED BY REMOTE OR AUTOMATICALLY & TO THE LOCAL AUTHORITIES APPROVAL.

ENTRANCE DOORS TO ALL UNITS SHOULD BE PROVIDED WITH A LOCK WHOSE LATCH BOLT IS OPERATED BY A HANDLE OR KNOB FROM EITHER SIDE & WHOSE DEAD BOLT IS LOCKED & UNLOCKED BY A KEY FROM THE OUTSIDE & BY A MANUALLY OPERATED TURN SNIB FROM THE INSIDE IN ACCORDANCE WITH BS 5588: Part 1.

ALL COMMON ESCAPE ROUTES IN FLATS & MAISONNETTES SHOULD HAVE ESCAPE LIGHTING TO BS 5266 Part 1: 2005 EMERGENCY LIGHTING.

THE INTERNAL LININGS OF WALLS & CEILINGS WITHIN CIRCULATION AREAS SHOULD BE CLASS 0 IN ACCORDANCE WITH APPENDIX A CLAUSES INTERNAL LININGS 10-16 INCLUSIVE OF THE APPROVED DOCUMENT B.

ALL NEW LOAD BEARING ELEMENTS OF THE STRUCTURE ARE REQUIRED TO HAVE A FIRE RESISTANCE OF MIN. 1 HOUR. REFER TO TABLE A2 OF APPENDIX A OF THE APPROVED DOCUMENT B.

ENCASEMENT OF UPVC DRAINAGE PIPES ARE TO HAVE A 1/2 HR STANDARD OF FIRE RESISTANCE SHOULD BE CLASS 0 INTERNALLY & FIRE STOPPED AT FLOOR LEVELS. ACCESS PANELS SHOULD NOT OPEN INTO BEDROOMS OR CIRCULATION AREAS.

PIPES & DUCTWORK PASSING THROUGH SEPARATING ELEMENTS OF STRUCTURE SHOULD BE INSTALLED TO MAINTAIN THE NECESSARY FIRE SEPARATION. ALL TO SEPARATE DETAIL.

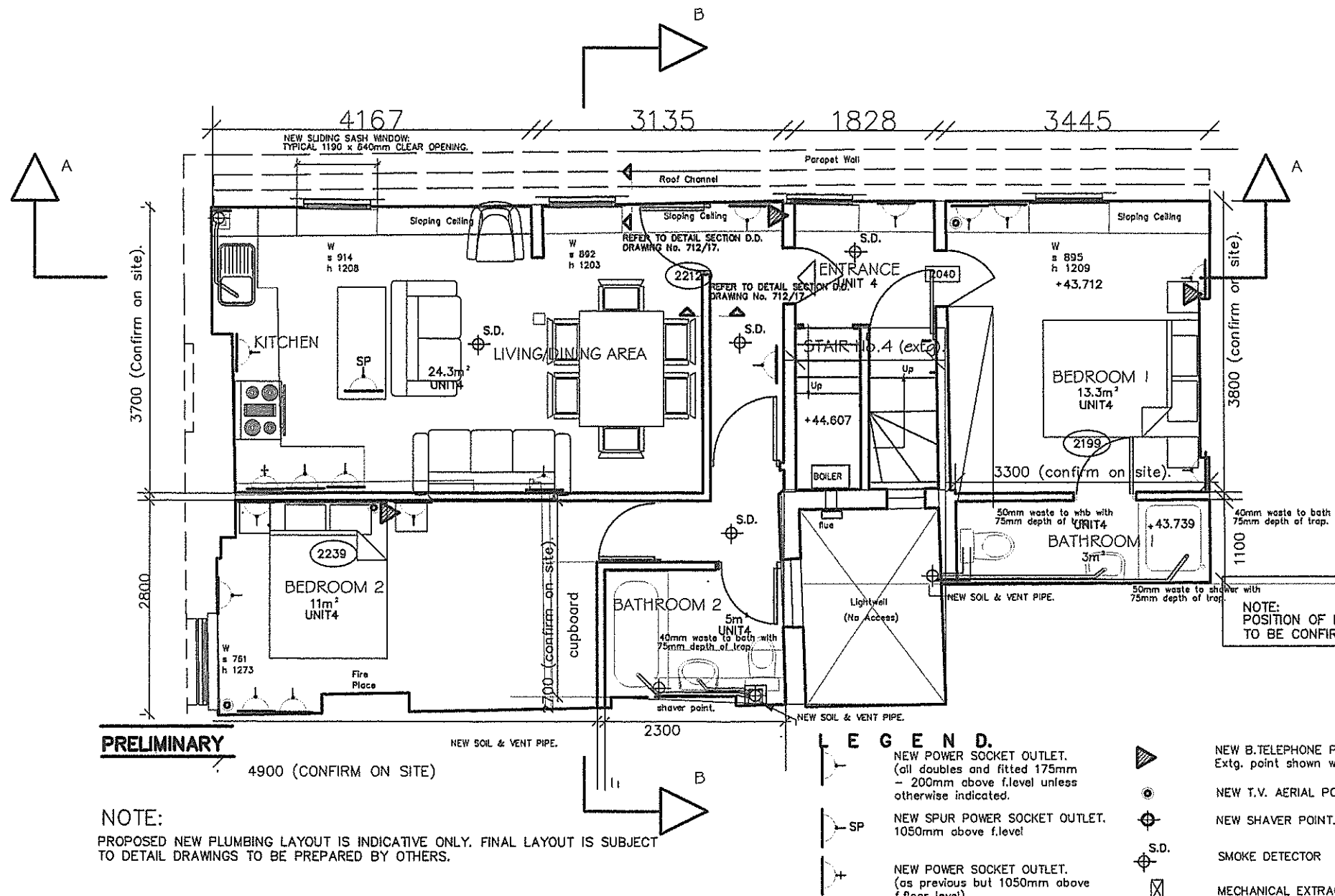

NOTE:

EACH SEPARATE DWELLING IS TO BE PROVIDED WITH A SUITABLE NUMBER OF MAINS OPERATED SELF-CONTAINED SMOKE ALARMS IN AREAS AS INDICATED ON THE DRAWING.

SELF-CONTAINED SMOKE ALARMS TO BE INTERCONNECTED WITHIN EACH DWELLING WHERE MORE THAN ONE ALARM IS NEEDED.

THE OWNER IS TO PROVIDE THE OCCUPANTS WITH THE NECESSARY INFORMATION ON THE USE & MAINTENANCE OF THE SMOKE ALARM EQUIPMENT.

MAIN ENTRANCE HALLWAY TO HAVE 1/2 HR. F.R. CONSTRUCTION & HAVE SELF-CLOSING FIRE DOORS TYPE FD20.. ANY GLAZING SHOULD BE FIRE-RESISTING & RESTRICTED TO FANLIGHTS & TO DOOR PANELS ABOVE 1.1m LIMITATIONS ON THE USE OF UNINSULATED GLAZED ELEMENTS. REFER TO TABLE A APPENDIX A OF THE APPROVED DOCUMENT B. FIRE SAFETY.

UNIT ENTRANCE DOORS SHOULD BE SELF-CLOSING FIRE-RESISTING TYPE FD30S WITH SMOKE SEALS WITH NO GLAZING. REFER FIRE DOORS TABLE B1 & APPENDIX A TABLE A4 OF THE APPROVED DOCUMENT.

THE STAIRWELLS TO HAVE OPENABLE WINDOWS AT EACH STOREY LEVEL OR ALTERNATIVELY A 1.0 sq. m. TOP VENTILATOR WHICH IS EITHER PERMANENTLY OPEN OR OPERATED BY REMOTE OR AUTOMATICALLY & TO THE LOCAL AUTHORITIES APPROVAL.

ENTRANCE DOORS TO ALL UNITS SHOULD BE PROVIDED WITH A LOCK WHOSE LATCH BOLT IS OPERATED BY A HANDLE OR KNOB FROM EITHER SIDE & WHOSE DEAD BOLT IS LOCKED & UNLOCKED BY A KEY FROM THE OUTSIDE & BY A MANUALLY OPERATED TURN SNIFF FROM THE INSIDE IN ACCORDANCE WITH BS 5588: Part 1.

ALL COMMON ESCAPE ROUTES IN FLATS & MAISONNETTES SHOULD HAVE ESCAPE LIGHTING TO BS 5266 Part 1: 2005 EMERGENCY LIGHTING.

THE INTERNAL LININGS OF WALLS & CEILINGS WITHIN CIRCULATION AREAS SHOULD BE CLASS 0 IN ACCORDANCE WITH APPENDIX A CLAUSES INTERNAL LININGS 10-16 INCLUSIVE OF THE APPROVED DOCUMENT B.

ALL NEW LOAD BEARING ELEMENTS OF THE STRUCTURE ARE REQUIRED TO HAVE A FIRE RESISTANCE OF MIN. 1 HOUR. REFER TO TABLE A2 OF APPENDIX A OF THE APPROVED DOCUMENT B.

ENCASEMENT OF uPVC DRAINAGE PIPES ARE TO HAVE A 1/2 HR STANDARD OF FIRE RESISTANCE SHOULD BE CLASS 0 INTERNALLY & FIRE STOPPED AT FLOOR LEVELS. ACCESS PANELS SHOULD NOT OPEN INTO BEDROOMS OR CIRCULATION AREAS.

PIPES & DUCTWORK PASSING THROUGH SEPARATING ELEMENTS OF STRUCTURE SHOULD BE INSTALLED TO MAINTAIN THE NECESSARY FIRE SEPARATION. ALL TO SEPARATE DETAIL.

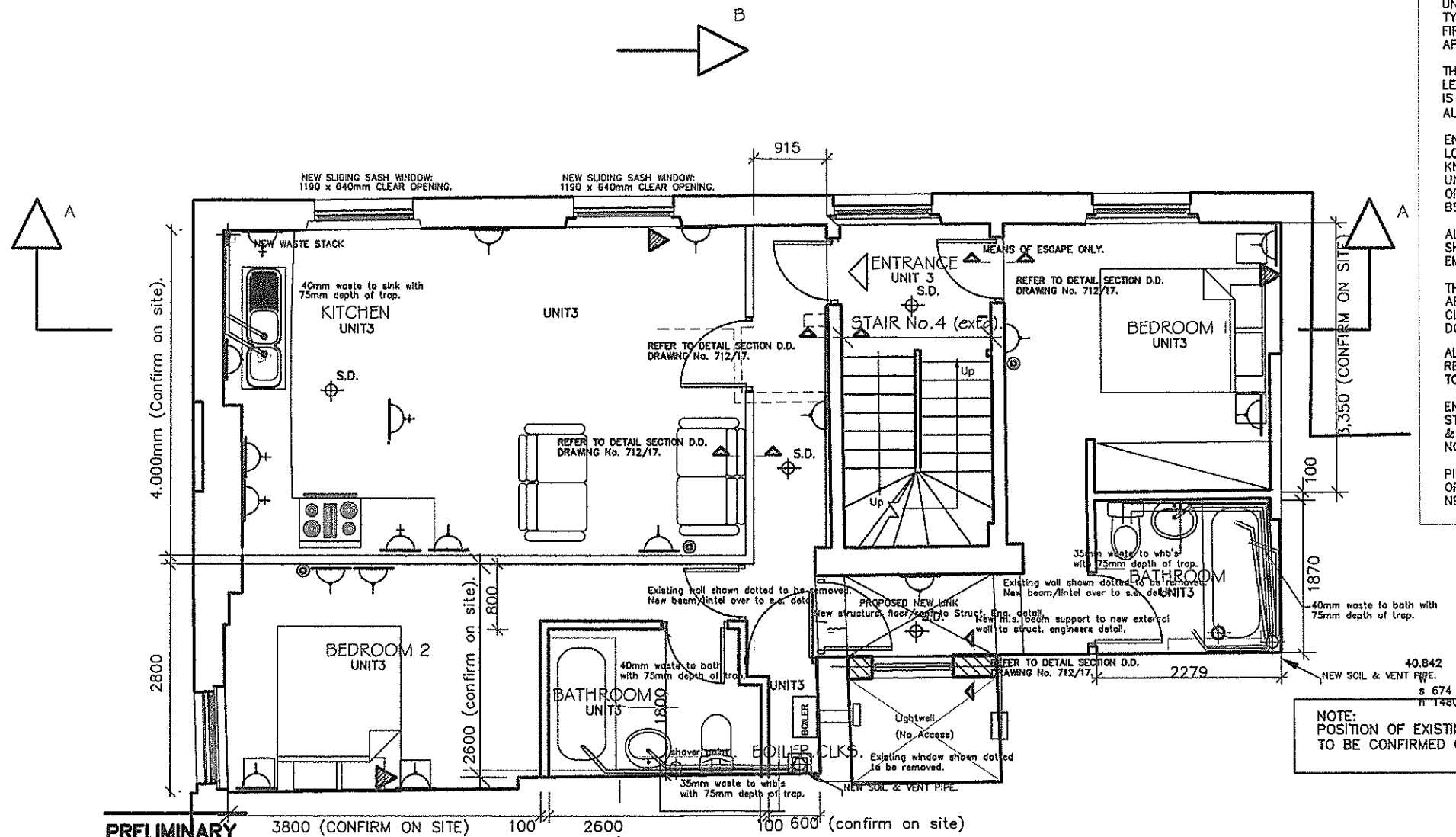

NOTE:

PROPOSED NEW PLUMBING LAYOUT IS INDICATIVE ONLY. FINAL LAYOUT IS SUBJECT TO DETAIL DRAWINGS TO BE PREPARED BY OTHERS.

LEGEND.

- NEW POWER SOCKET OUTLET. (all doubles and fitted 175mm - 200mm above f.level unless otherwise indicated).
- NEW SPUR POWER SOCKET OUTLET. 1050mm above f.level
- NEW POWER SOCKET OUTLET. (as previous but 1050mm above f.floor level).

- NEW B.TELEPHONE POINT. Extg. point shown without infill).
- NEW T.V. AERIAL POINT.
- NEW SHAVEN POINT.
- S.D. SMOKE DETECTOR
- MECHANICAL EXTRACT FAN

0m. 1m. 2m. 3m. 4m. 5m. 10m.

scale bar:.

195 ALBANY STREET LONDON NW1 4AR

SECOND FLOOR LEVEL: PROPOSED

Scale: 1:50

Drawn: LJS

Dwg. No: 5/712/BREGS/A2/15/A.

FARROW SILVERTON
CHARTERED ARCHITECTS & DESIGN CONSULTANTS

6 HALE LANE MILL HILL
LONDON NW7 3NX
tel: 0208-906 8502 fax: 0208-906 8503
e-mail: office@farsil.com