

- NOTES
- 1 The Contractor must check and confirm dimensions
  - 2 All discrepancies must be reported and resolved by the Architect before works commence
  - 3 This drawing is not to be scaled
  - 4 All work and materials to be in accordance with current applicable Statutory Legislation and to comply with all relevant Codes of Practice and British Standards.

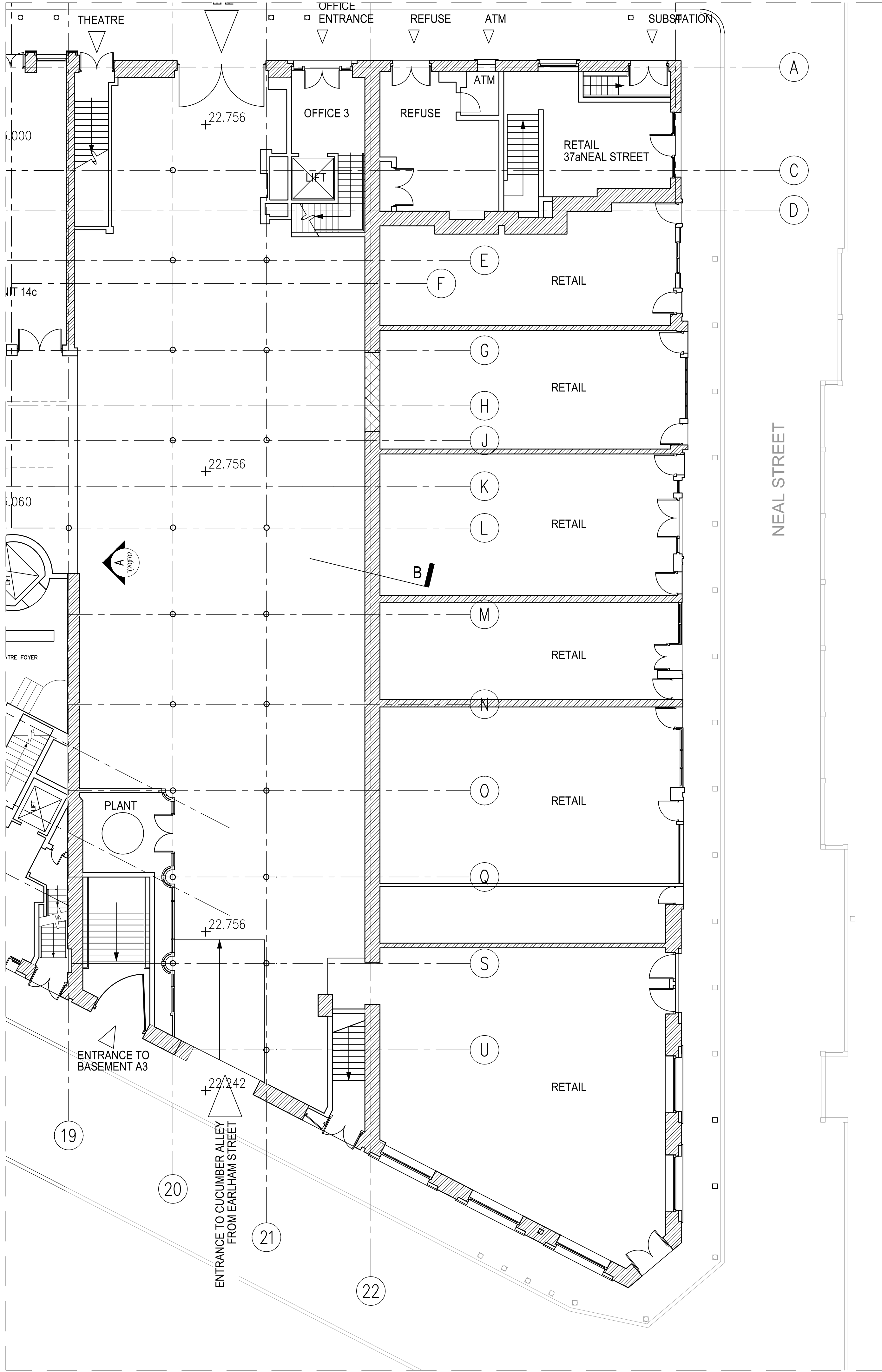
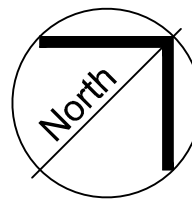

**A** PROPOSED PLAN – CUCUMBER ALLEY  
SCALE: 1:100 (A1), 1:200 (A3)

P1 PLANNING ISSUE 17/05/13  
B MINOR REVISION 28/05/12  
A FIRST ISSUE 25/05/12

Rev | Date

**Rolfe Judd**

Architecture Planning Interiors  
Old Church Court, Claylands Road, The Oval, London SW8 1NZ  
T 020 7556 1500  
www.rolfe-judd.co.uk

Client  
**SHAFTESBURY PLC**

Project  
**THOMAS NEAL'S CENTRE  
LONDON WC2**

Drawing  
**CUMCUMBER ALLEY GROUND FLOOR  
PLAN AS PROPOSED**

Scale  
**1:100 (A1)**

Date  
**MAY 13**

Drawn  
**MMR**

Drawing No  
**4621 / T(20) P100**

Revision  
**P1**

CAD Ref No  
G:\4621\T\_Series\T20\T20P100  
© Copyright Rolfe Judd Ltd

This scale is 100mm in length when printed at the size indicated in the title block.