



THE BEDFORD ESTATES

Key

 Demolitions

 Existing Structure

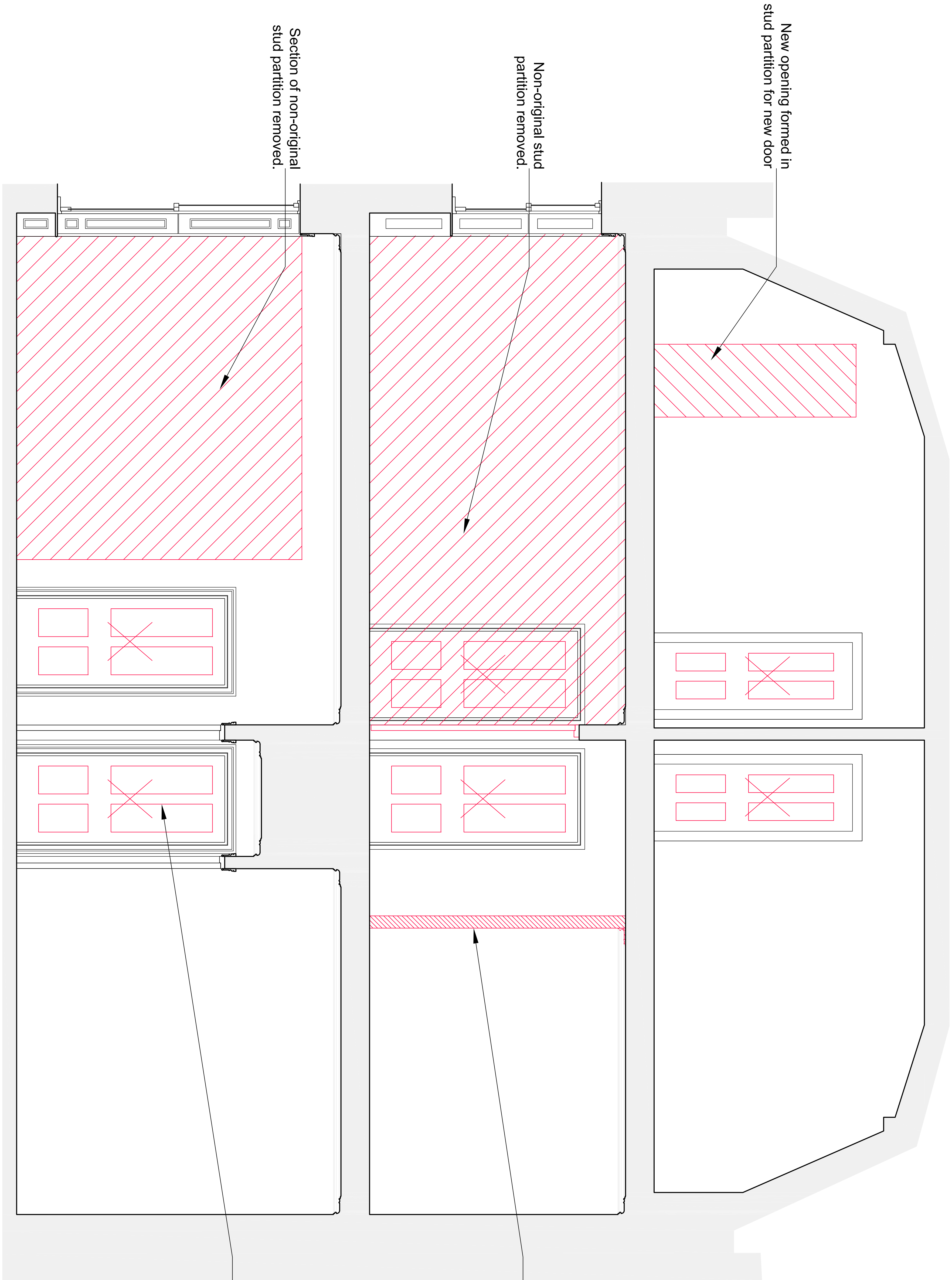

01
(01)300 Section - As Existing

REV / ISSUE DATE REVISION NOTES

GENERAL NOTES
Do not scale. All written dimensions must be checked as the building work commences on site or in shop. Figure dimensions take preference over those scaled. Discrepancies, where identified, must be reported to the Architect immediately.
Any areas indicated on this drawing are for guidance purposes only. No responsibility is taken for their accuracy.
All work must be carried out in accordance with the Building Regulations and to the satisfaction of the Local Authority.

PLANNING

CLIENT		The Bedford Estate	
Garnett+Partners LLP Holborn Hall 395 High Holborn London WC1V 7BD Tel: +44 (0)20 7404 7877 Fax: +44 (0)20 7404 6648 mail@garnettpartners.com www.garnettpartners.com architects / planners / designers		PROJECT	
27 Gower Street, London		DRAWING TITLE	
First, Second & Third Floor Section As Existing with Demolitions		SCALE	
1:20@A1		DATE	
771		May '13	
(01)300		REV /	
B			