

- Demolition Key:**
- Line Denotes Removal of Existing Structure
 - Dash Denotes Removal of Existing Structure
- Key:**
- New partition
 - Existing structure
- Abbreviations:**
- RWP - Rain Waterpipe
 - Ex. - Existing
 - MH - Manhole
 - RC - Reinforced Concrete
 - SE - Structural Engineer
 - PPC - Polyester Powder Coated

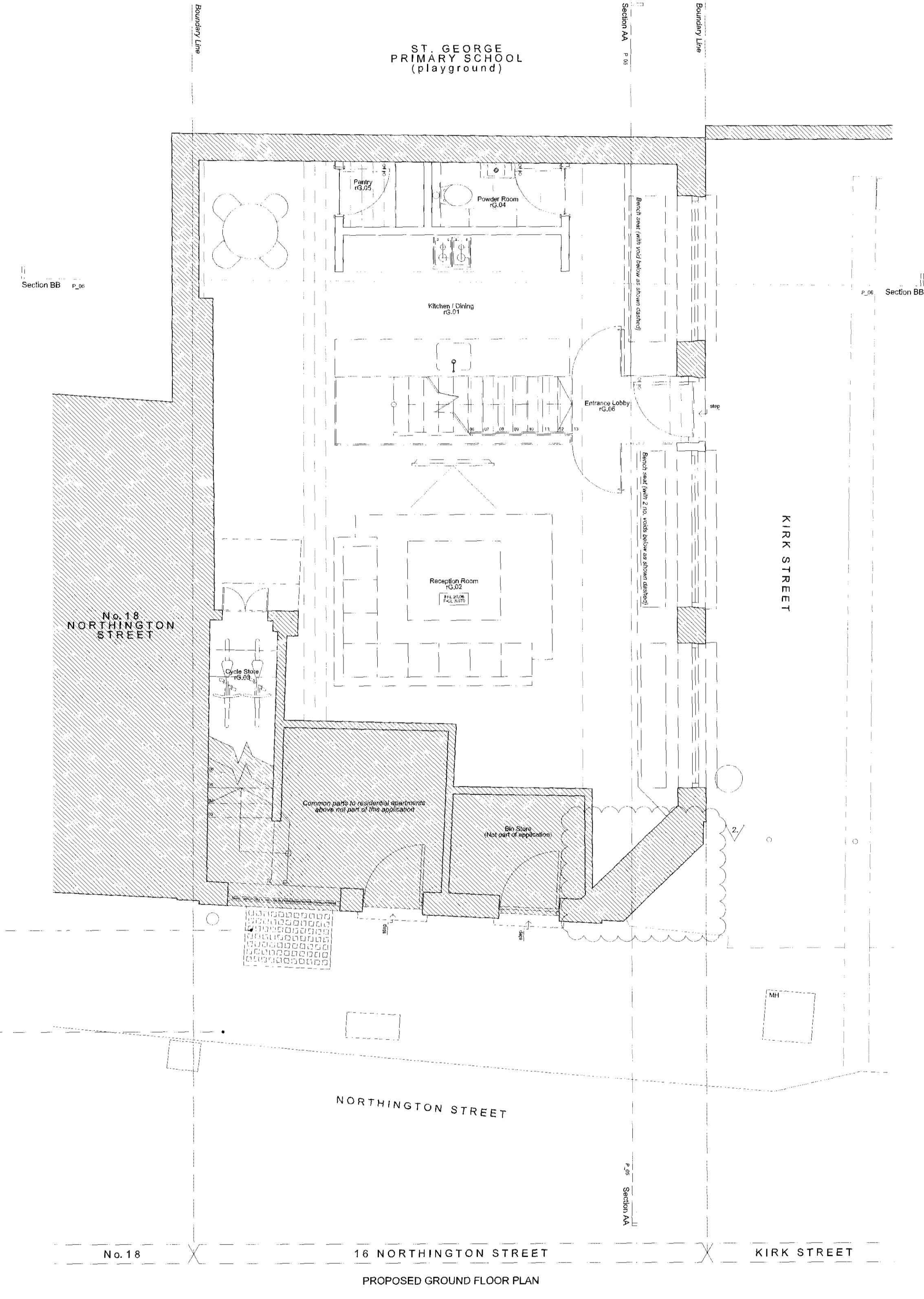
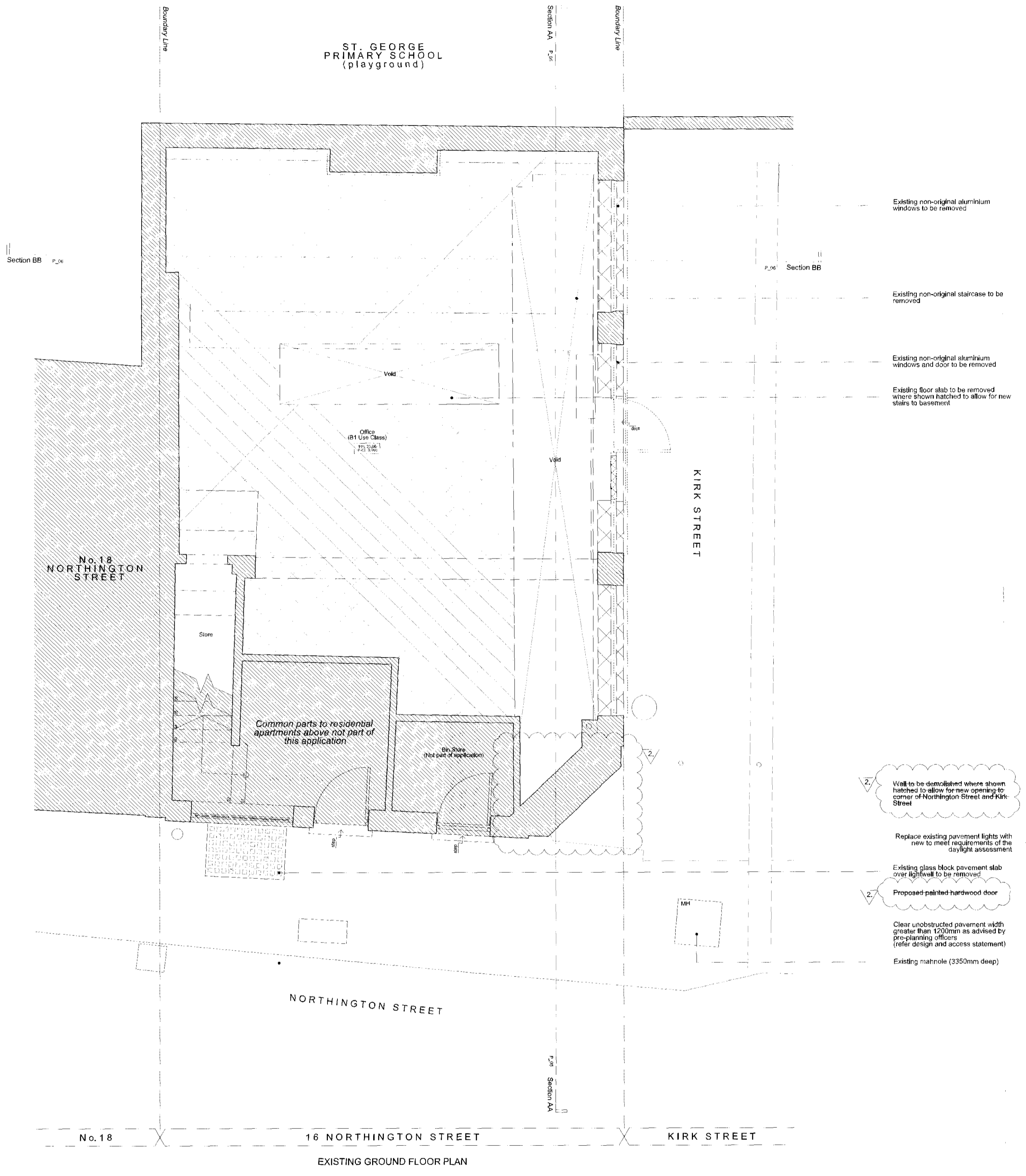
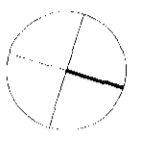

- REV C 14.06.2013 Issued for Planning Revisions bubbled and numbered below:
2. Proposed hardwood door omitted, wall reinstated. Notes amended
- REV B 05.11.2012 Issued for Planning Revisions are bubbled
1. Amendments to light well
- REV A 18.09.2012 Issued for Planning

PLANNING ISSUE

Project No. 12046

Client UK Property Specialist Ltd.

Date June 2013

Scale 1:50@A1, 1:100@A3

Project The Dickens Inn, Northington Street

Drawing Title: Existing & Proposed Ground Floor Plan

Drawing No. P_02 C

Drawn LH Approved RD Signed

Marek Wojciechowski Architects

28 Marquet Street V11X 8PZ T: 020 7465 9336 www.marekwojciechowski.co.uk

Copyright Marek Wojciechowski Architects Ltd. 2013. All rights reserved. This drawing is the property of Marek Wojciechowski Architects Ltd. It is to be used only for the project and site specified. It is not to be used for any other project or site without the written consent of Marek Wojciechowski Architects Ltd.

0 1m 2m 4m 8m