



Please note that this drawing shows proposals within the Planning Application Area Boundary, in areas of Adopted Highway. It is assumed that these indicative proposals will be subject to design approval from the Highway Authority.

- NOTES**
1. This drawing is copyright of Camlins and may not be reproduced in whole or in part without the written permission of Camlins.
  2. Do not scale from this drawing, unless otherwise shown.
  3. All levels in metres above Ordnance Datum (mAOD), unless otherwise shown.
  4. All dimensions to be checked on site and any discrepancies reported to Camlins and the CA for clarification before pricing / work proceeds.
  5. Any ambiguities or discrepancies within this drawing or between this drawing and any other information given elsewhere must be reported to Camlins and the CA for clarification before pricing / work proceeds.
  6. Drawings to be made in conjunction with other drawings and packages as appropriate.
  7. All works carried out in accordance with the latest British Standards and appropriate codes of practice as a minimum.

**Key**

BUILDINGS	HARD MATERIALS	SOFT MATERIALS	STRUCTURES
Existing buildings	Yorkstone surface	Lawn or informal grass	Climbable sculpture as per proposal to
Proposed buildings	Granite setts sawn top	Shrub / perennial planting	Shrub retaining walls, terraces etc in granite
Pedestrian entrance to commercial, public or controlled	Cobble setts as existing (Gough St only)	Existing tree to be retained (indicative areas only)	Raised planting bed
Pedestrian entrance to private	Existing and proposed backstop carriageway	Proposed tree to be retained	Fence
Vehicular entrance / exit	Clay brick paving	Proposed trees. Where in adopted highway, subject to location of underground services.	B = Ballard AB = Automatic bollard FB = Fold down bollard (Shielded type stainless steel)
	Hardwood deck		Cycle stands (Shielded type stainless steel)
	Granite flags in complementary colours		Proposed levels & gradients
	Small unit mosaic sett surface		Cast iron grates over drainage and support structure would be provided to incorporate arbor and lighting under.
	Proposed and existing kerb lines		
	Self binding gravel surface		

**Revisions**

Rev	Date	Description
P1	24.04.2013	Planning Issue
P2	31.05.2013	Planning Issue - Redline Boundary Amended

**FOR PLANNING**

**MOUNT PLEASANT - CALTHORPE STREET SITE**  
ROYAL MAIL GROUP

**Detailed Open Space Plan - The Gardens**

Drawing No: 00\_07\_007  
Revision: P2  
Scale: 1:100(A0) / 1:250(A3)  
Date: 24.04.2013

Drawn by: MD  
Checked by: FSS



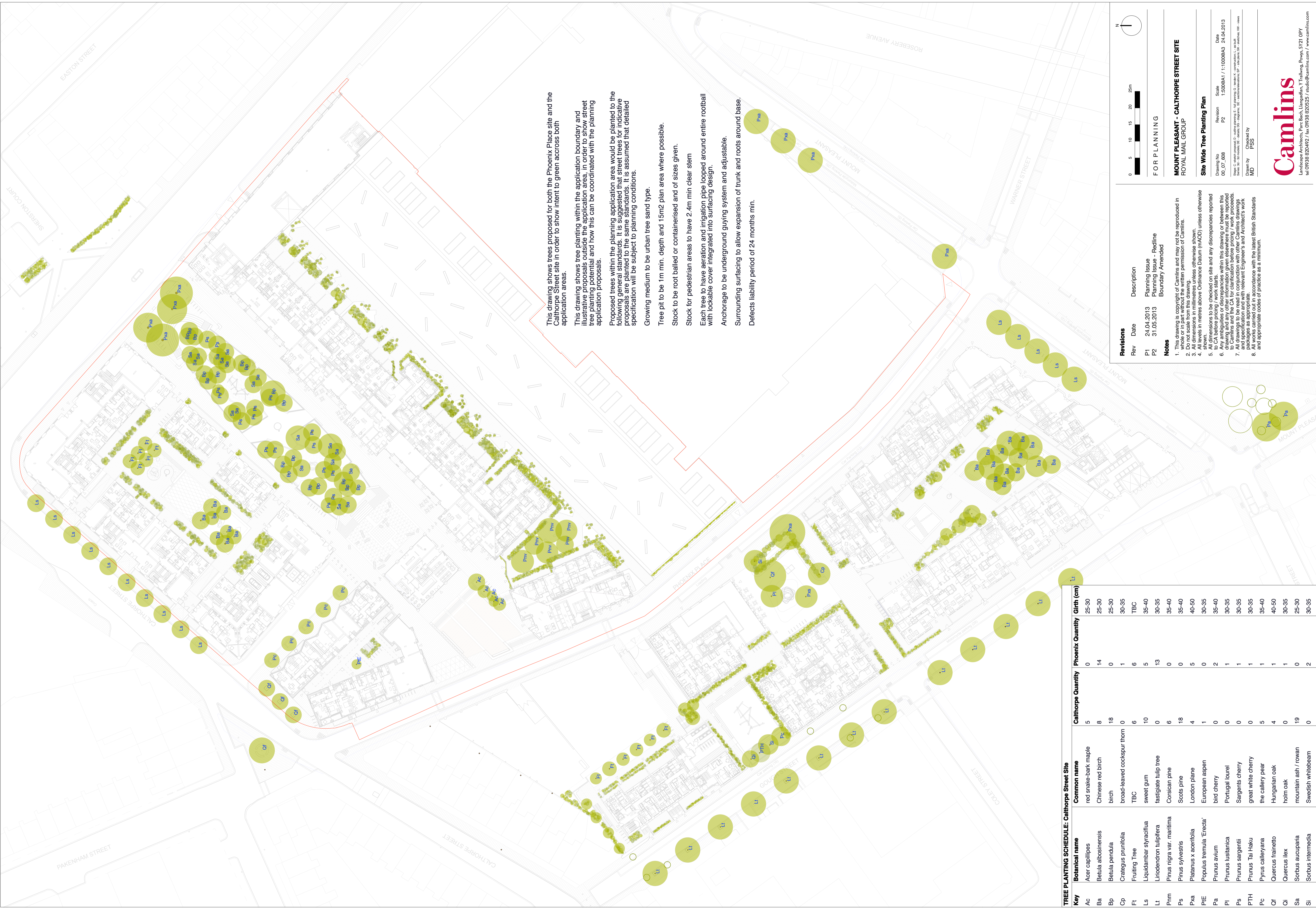

This drawing shows trees proposed for both the Phoenix Place site and the Calthorpe Street site in order to show intent to green access both application areas.

This drawing shows tree planting within the application boundary and illustrative proposals outside the application area, in order to show street tree planting potential and how this can be coordinated with the planning application proposals.

Proposed trees within the planning application area would be planted to the following general standards. It is suggested that street trees for indicative proposals are planted to the same standards. It is assumed that detailed specification will be subject to planning conditions.

Growing medium to be urban tree sand type.

Tree pit to be 1m min. depth and 15m2 plan area where possible.

Stock to be root balled or containerised and of sizes given.

Stock for pedestrian areas to have 2.4m min clear stem

Each tree to have aeration and irrigation pipe looped around entire rootball with lockable cover integrated into surfacing design.

Anchorage to be underground guying system and adjustable.

Surrounding surfacing to allow expansion of trunk and roots around base.

Defects liability period of 24 months min.

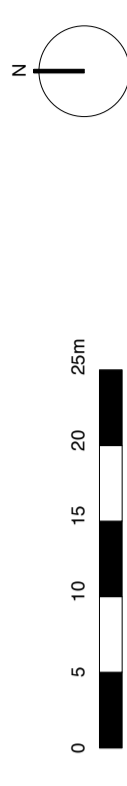

**Revisions**

Rev	Date	Description
P1	24.04.2013	Planning Issue
P2	31.05.2013	Planning Issue - Redline Boundary Amended

**Notes**

- This drawing is copyright of Camlins and may not be reproduced in whole or in part without the written permission of Camlins.
- All dimensions in millimetres unless otherwise shown.
- All dimensions in metres above Ordnance Datum (mOD) unless otherwise shown.
- All dimensions in metres below Ordnance Datum (mBD) unless otherwise shown.
- All dimensions to be checked on site and any discrepancies reported to Camlins immediately.
- Any ambiguities or discrepancies within this drawing or between this drawing and any other information given elsewhere must be reported to Camlins and the CA for clarification before pricing / work proceeds.
- Work to be carried out in accordance with the relevant British Standards packages as appropriate.
- Work to be carried out in accordance with the latest British Standards and appropriate codes of practice as a minimum.

**MOUNT PLEASANT - CALTHORPE STREET SITE**  
ROYAL MAIL GROUP

**Site Wide Tree Planting Plan**

Drawing No: 00\_07\_008  
Revision: P2  
Scale: 1:1000  
Date: 24.04.2013

Drawn by: J. [Name]  
Checked by: [Name]  
Approved by: [Name]  
Project Manager: [Name]  
Project Engineer: [Name]



**TREE PLANTING SCHEDULE: Calthorpe Street Site**

Key	Botanical name	Common name	Calthorpe Quantity	Phoenix Quantity	Girth (cm)
Ac	Acer capillipes	red snake-bark maple	5	0	25-30
Ba	Betula albosinensis	Chinese red birch	8	14	25-30
Bp	Betula pendula	birch	18	0	25-30
Cp	Crataegus prunifolia	broad-leaved cockspur thorn	0	1	30-35
Ft	Fruiting Tree	TBC	6	6	TBC
Ls	Liquidambar styraciflua	sweet gum	10	5	35-40
Lt	Liriodendron tulipifera	fastigate tulip tree	0	13	30-35
Pnm	Pinus nigra var. maritima	Corsican pine	6	0	35-40
Ps	Pinus sylvestris	Scots pine	18	0	35-40
Pxa	Platanus x acerifolia	London plane	4	5	40-50
PtE	Populus tremula 'Erecta'	European aspen	1	0	30-35
Pa	Prunus avium	bird cherry	0	2	35-40
Pl	Prunus lusitanica	Portugal laurel	0	1	30-35
Ps	Prunus sargentii	Sargent's cherry	0	1	30-35
PTH	Prunus Tai Haku	great white cherry	0	1	30-35
Pc	Pyrus calleryana	the callery pear	5	1	35-40
Qt	Quercus frainetto	Hungarian oak	4	1	40-50
Qi	Quercus ilex	holm oak	0	1	30-35
Sa	Sorbus aucuparia	mountain ash / rowan	19	0	25-30
Si	Sorbus intermedia	Swedish whitebeam	0	2	30-35



