

1 Standard Layout as at Day 1
1:50

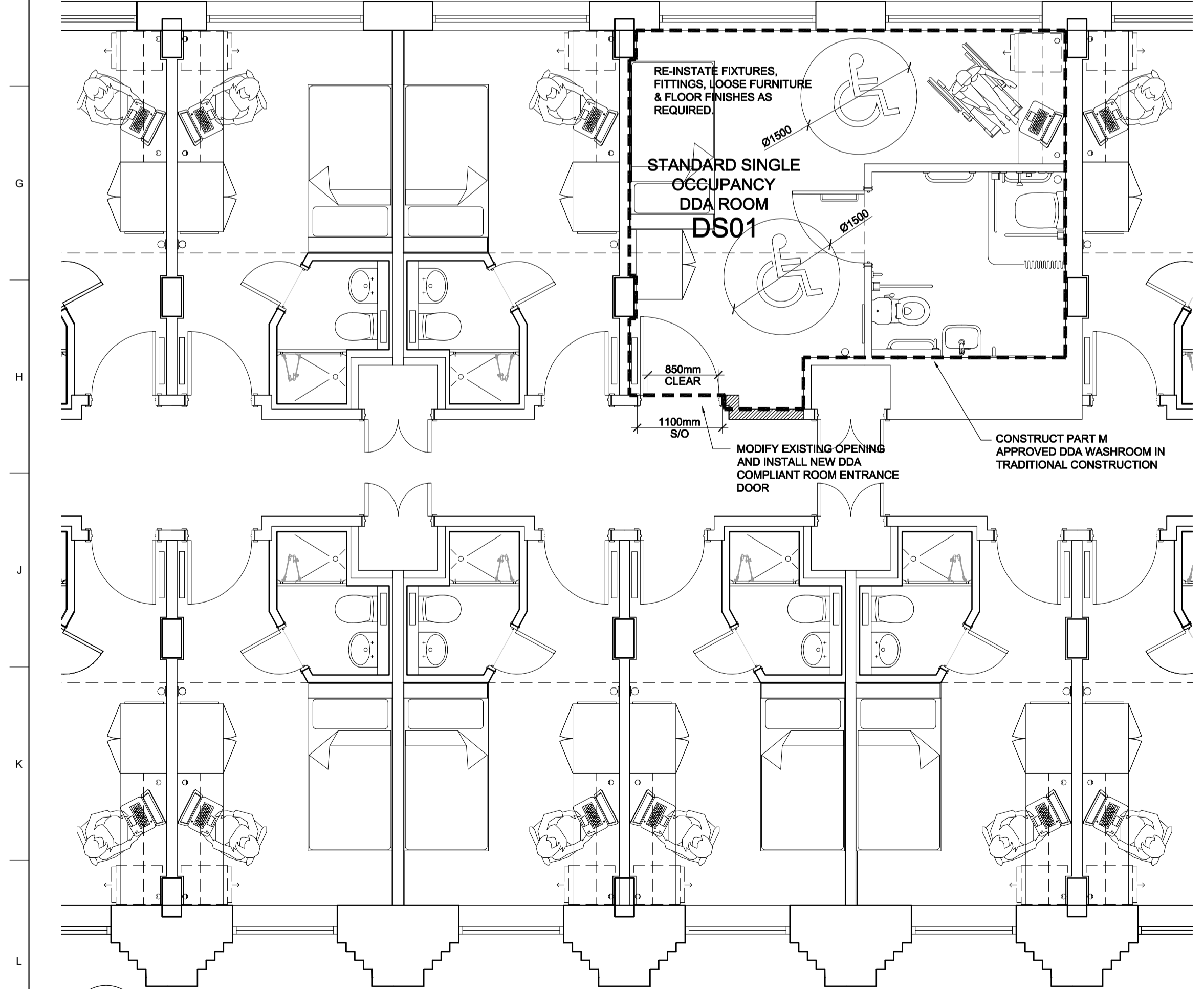

3 Standard Layout including retrofitted DDA room
1:50

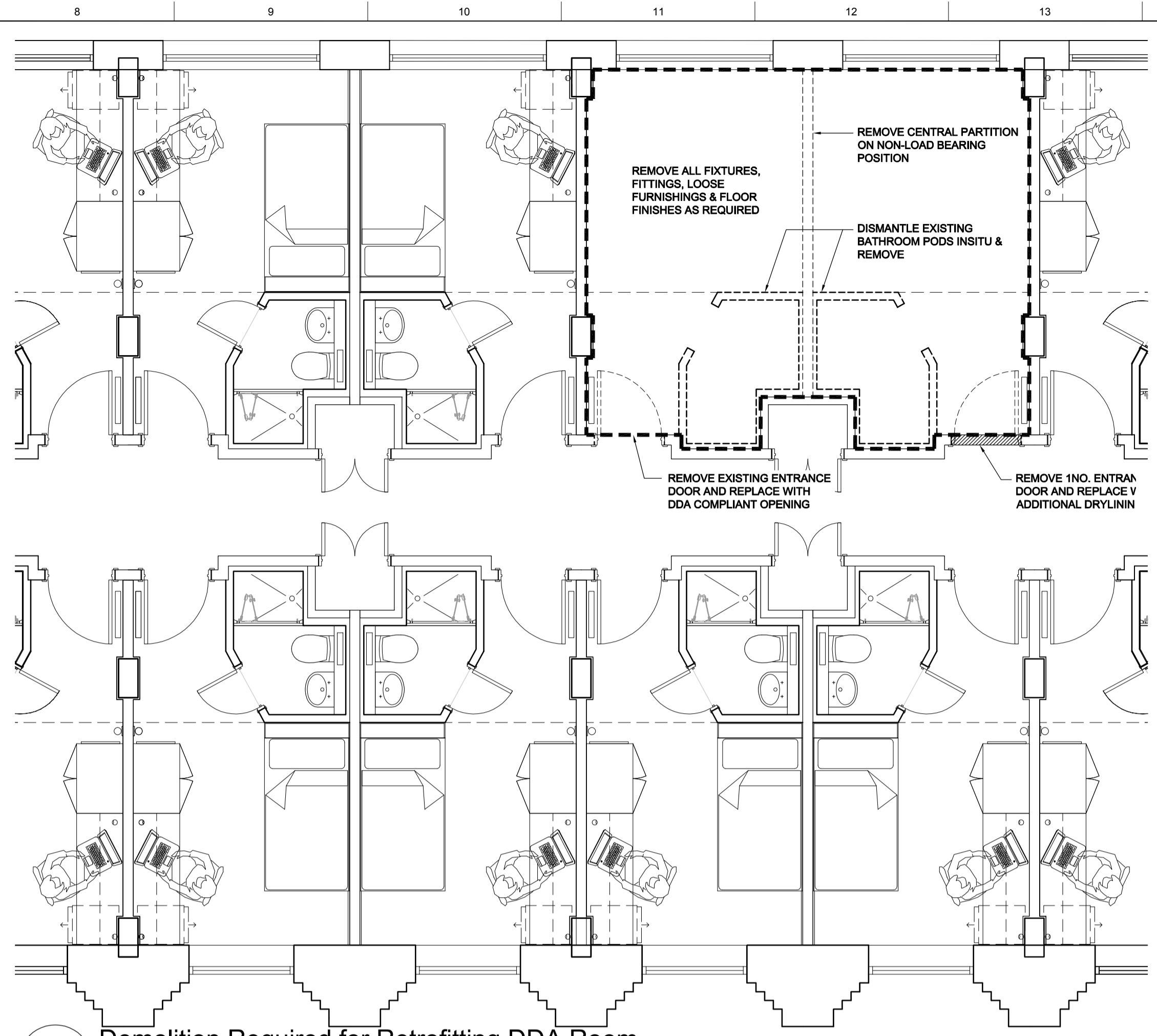

2 Demolition Required for Retrofitting DDA Room
1:50

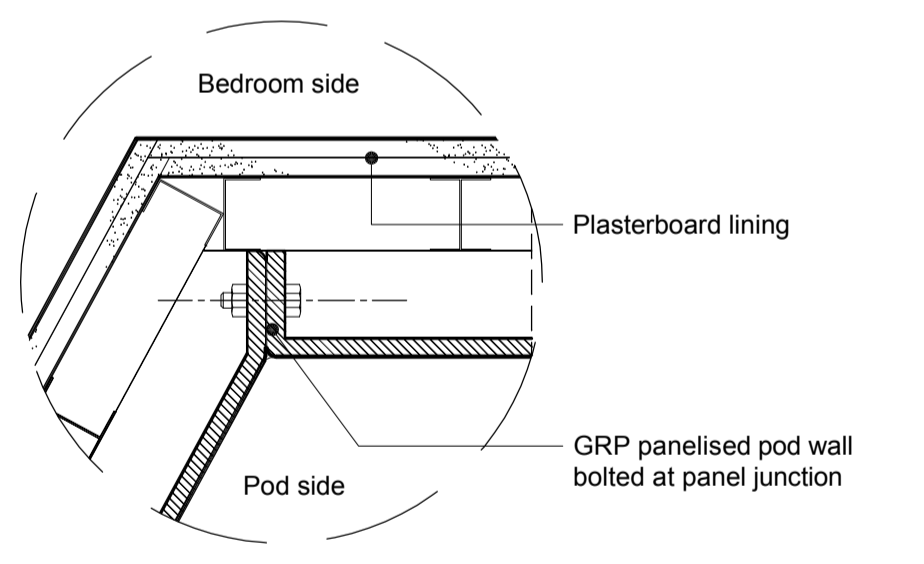

A GRP Pod Panel Connection
1:5

Notes:

The methodology for retro fitting accessible accommodation requires no structural alterations and uses the footprint of two adjoining standard rooms.

Summary of works:

- Remove all furniture, fittings and fixtures
- Remove floor tiles in the location of the new shower room.
- Remove the central dividing non load bearing stud wall and plasterboard pod lining
- Dismantle the panelised GRP pod (see detail A) to allow the wall / floor panels to be removed through existing door openings.
- Cap all drainage and water services.
- Remove existing door, adapt the existing opening and install a Part M compliant door.
- Remove and block up the second (redundant) entrance door .
- A new accessible shower room with a wet room floor is to be built insitu with a stud wall construction. The shower room will provide a Part M compliant WC, basin and shower with all associated grab rails and electrical / mechanical services e.g. alarm with pull cord.
- Make good the bedroom ceiling to the shower room walls.
- Redecorate.
- Reinstate existing bedroom carpet floor tiles and supplement where necessary
- Re fit furniture

CLIENT
UPP

STRUCTURAL ENGINEER
CUNDALL

SERVICES ENGINEER
CUNDALL

ACCESS CONSULTANT
ALL CLEAR DESIGNS

KEY PLAN

NOTES:

DO NOT SCALE. FIGURED DIMENSIONS ONLY TO BE TAKEN FROM THIS DRAWING. CHECK DIMENSIONS ON SITE AND REPORT DISCREPANCIES TO THE ARCHITECT.

THIS DRAWING IS PROTECTED BY COPYRIGHT.

ALL AREAS HAVE BEEN MEASURED FROM CURRENT DRAWINGS. THEY MAY VARY BECAUSE OF (EG) SURVEY, DESIGN DEVELOPMENT, CONSTRUCTION TOLERANCES, STATUTORY REQUIREMENTS OR RE-DEFINITION OF THE AREAS TO BE MEASURED.

P2	04.06.13	Methodology and detail A added	RM	NM
P1	09.05.13	ISSUED FOR REVIEW	EG	RM
No.	Date	Comment	Drawn	CHKD

Issue Status
PLANNING

tp bennett
architecture
interiors
planning

One America Street London SE1 ONE UK +44 (0) 20 7208 2000 www.tpbennt.com
London Moscow Abu Dhabi New York

Project
Proposed University of London Cartwright Gardens, London

Drawing Title
Proposed Plans Accessible Bedrooms Retrofitting ES01 to DDA Compliant

Drawn	Date	Scale	Alt. Ref.
EG	May 2013	1:50	-

tp bennett Project No.	Drawing Number	Rev
A10417	D 0610	P2