



Fig 14 View of 1971, looking south-east past the balustrade and stairs to Witanhurst House (London Metropolitan Archives SC/PHL/01/346. Photo No. 71/1524)



Fig 15 The Italian garden in 2008, looking west (Author)



Fig 16 The drive and Lodge looking east from the roof of the main building. The South Lodge is on the right, the North Lodge is behind the tree to the left (Author)

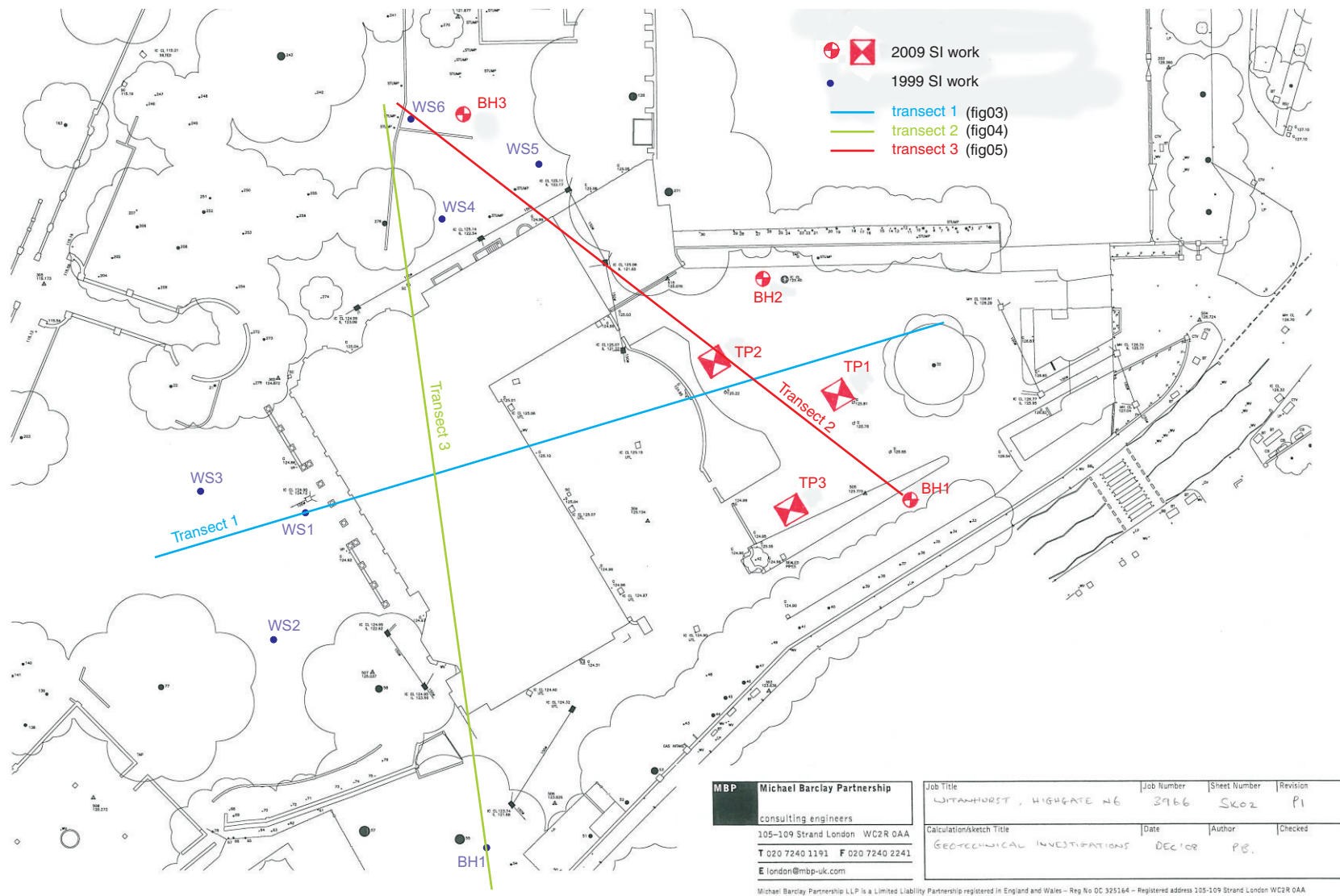

MBP Michael Barclay Partnership
 consulting engineers
 105-109 Strand London WC2R 0AA
 T 020 7240 1191 F 020 7240 2241
 E london@mbp-uk.com

Job Title	Job Number	Sheet Number	Revision
WITANHURST, HIGHGATE NG	3966	SK02	P1
Calculation/sketch Title	Date	Author	Checked
GEOTECHNICAL INVESTIGATIONS	DEC10R	PEB.	

Michael Barclay Partnership LLP is a Limited Liability Partnership registered in England and Wales - Reg No OC 325164 - Registered address 105-109 Strand London WC2R 0AA

Fig 17 Location of interventions and transects

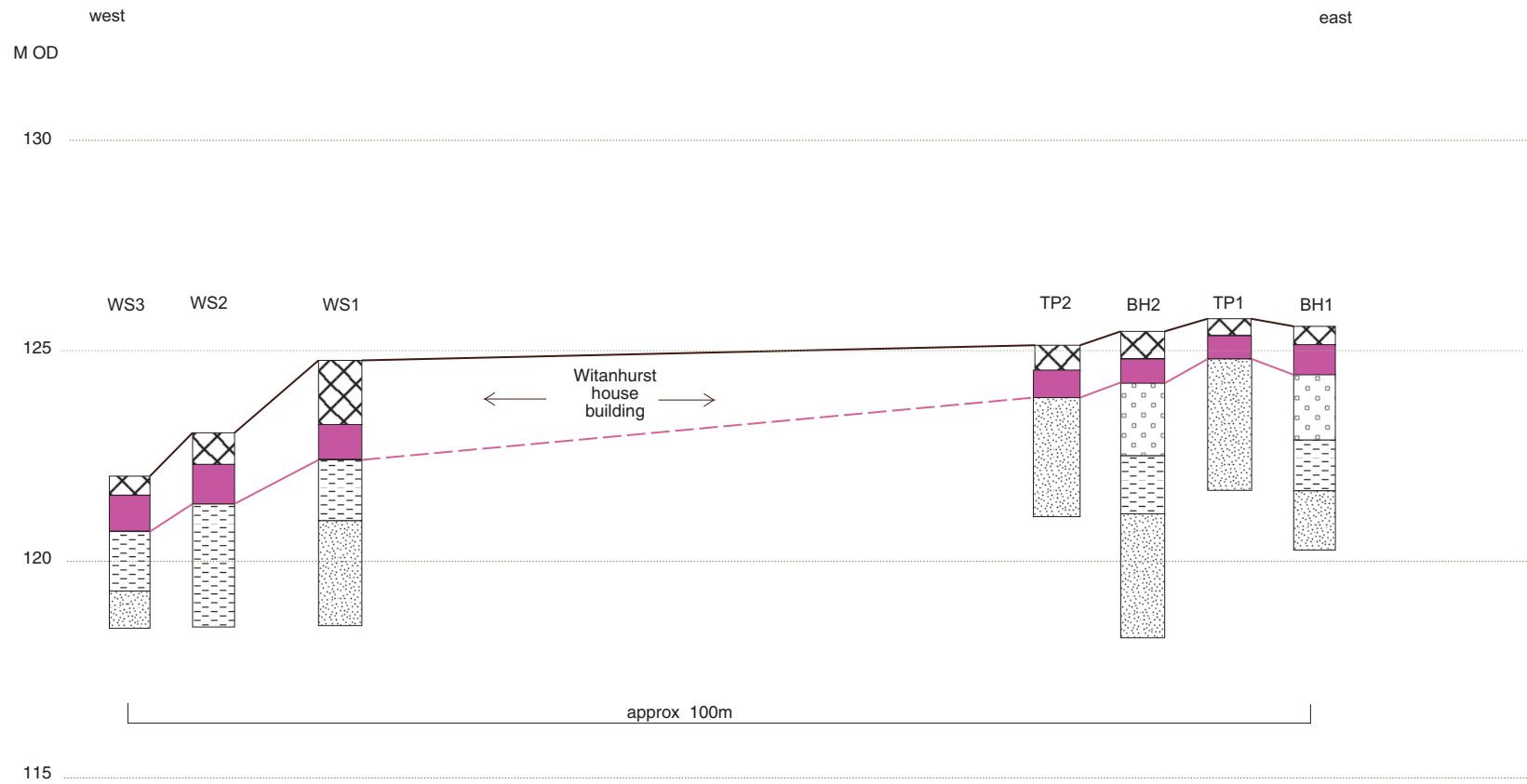

KEY

	predominantly gravels	} Eocene deposits of the Thames Group		modern made ground	— approximation of modern ground level - - - bottom line for deposits of possible archaeological interest
	predominantly clay			deposits of possible archaeological potential	
	predominantly sand			slope deposits of possible archaeological potential	

CAMD1162GEO09#03

HTW091 Geoaerchaeological/Geotechnical report © MOL Archaeology 2009

Fig 18 Schematic west to east transect (Transect 1)

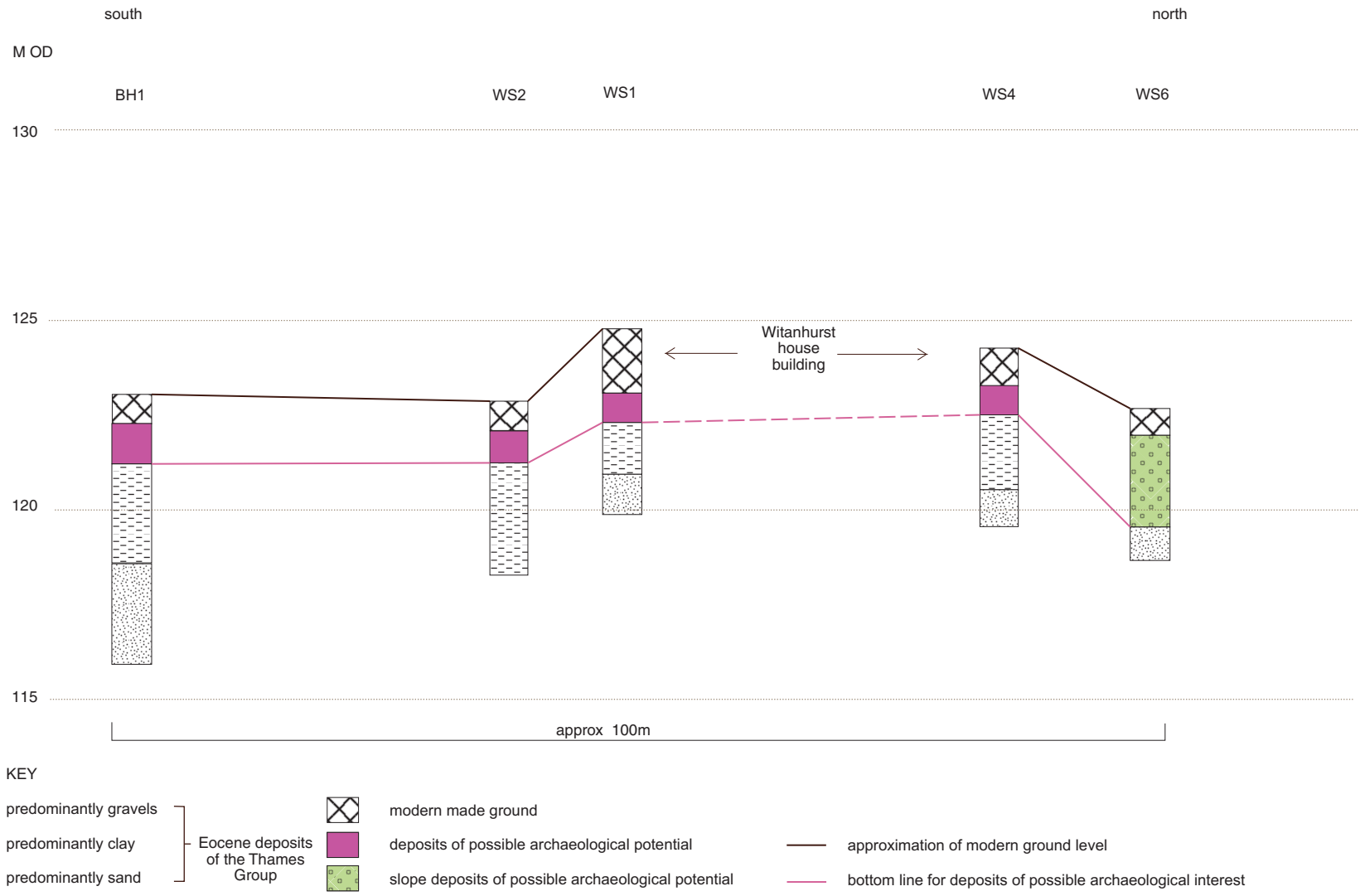

CAMD1162GEO09#05

Fig 20 Schematic south to north transect (Transect 3)