

LEGEND.

1. Existing roof tiles.
2. Existing red brick.
3. Existing painted timber framed windows.
4. Existing stucco rendered extension.
5. Existing aluminium window.



date rev revisions

- - -

key plan

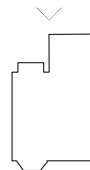

notes

DMFK Architects Ltd take no responsibility for dimensions obtained by scaling from this drawing. If no dimension is shown the recipient must ascertain the dimension specifically from the architect or by site measurement and may not rely on the drawing. Supply of the drawing in digital form is solely for convenience and no reliance may be placed on any data in digital form. All data must be checked against hard copy. This drawing is issued for design intent only and should not be used for construction unless stated.

copyright

This drawing is the property of dMFK Architects Ltd. No disclosure or copy of it may be made without the written permission of dMFK Architects Ltd.



DE METZ FORBES KNIGHT ARCHITECTS

the old library 119 cholmley gardens london nw6 1aa t 020 7435 1144 f 020 7435 0884 mail info@dmfk.co.uk
 project drawing title

72 Shoot-Up Hill EXISTING REAR ELEVATION

| client | scale at A1 | scale at A3 | drawn | date |
|-------------------|-------------|-------------|----------|---------|
| 64 Chalk Hill Ltd | 1:50 | 1:100 | CB | JUNE 13 |
| | project no. | drawing no. | revision | |
| | 1881 | A111 | - | |