

REVISIONS

Rev. Date By  
A\_Adjoining properties removed. Front boundary wall shown. 11.07.13 LV

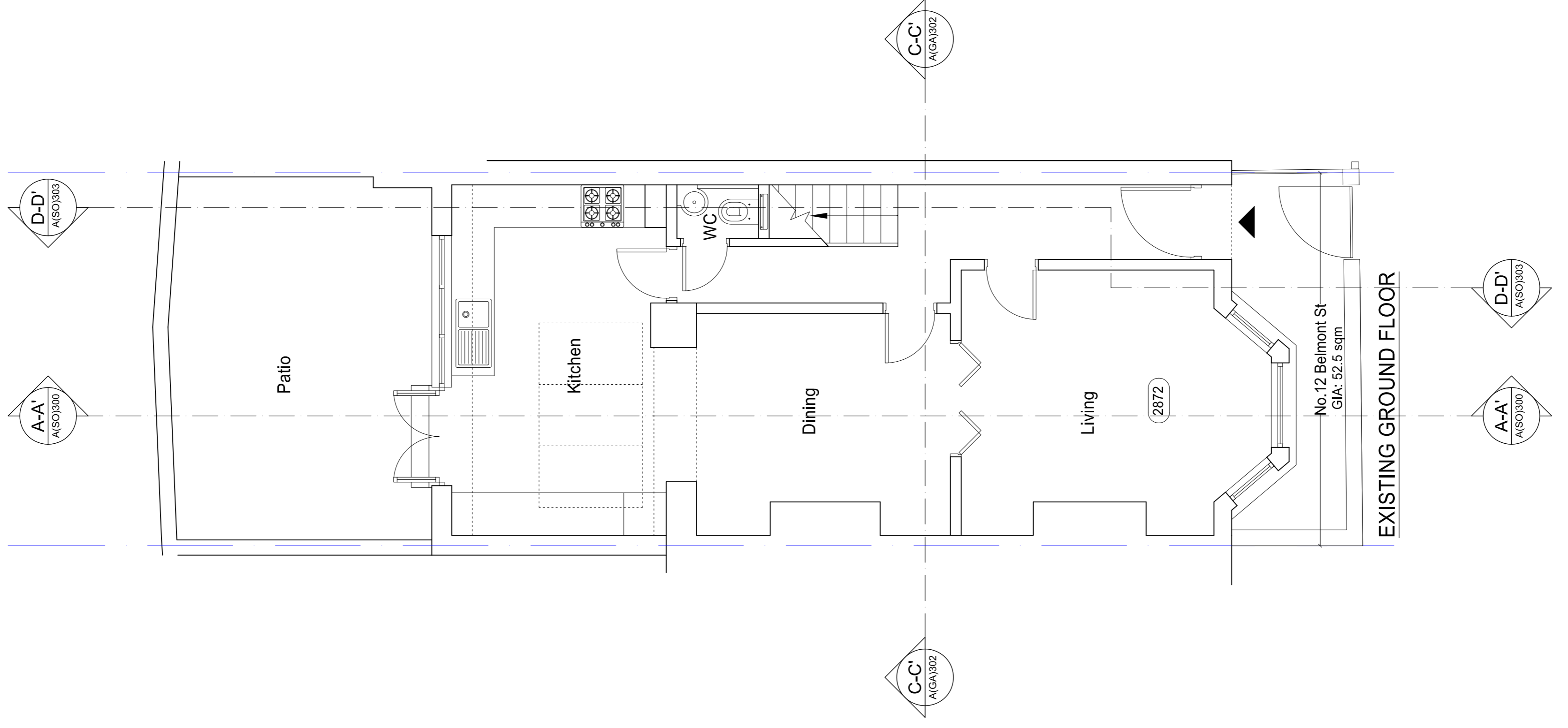

PLANNING APPLICATION

ALL DIMENSIONS TO BE CHECKED ON SITE  
WORK TO FINISHED DIMENSIONS ONLY  
REPAIRS TO EXISTING STRUCTURE TO BE COMPLETED  
AT ONCE BEFORE PROCEEDING

Contemporary Design Solutions



46 Great Marlborough Street  
London  
W1F 7JW  
Telephone: 020 7464 6000 Fax: 020 7464 4844

Client

WARMHAZE LTD

Project Title

Basement extension  
12 Belmont Street,  
LONDON NW1 5BH

Drawing Title

Existing Ground Floor Plan

Scale: 1:50@A1, 1:100@A3 Date: March 2013  
Drawn: LV Checked: DL  
Drawing No. Rev.:

120520-A(SO)100 A

CAD file: d13c\_11 Jul 2013 - 05:48pm

