

SITE PLAN

Hatched thus denotes existing area to be retained

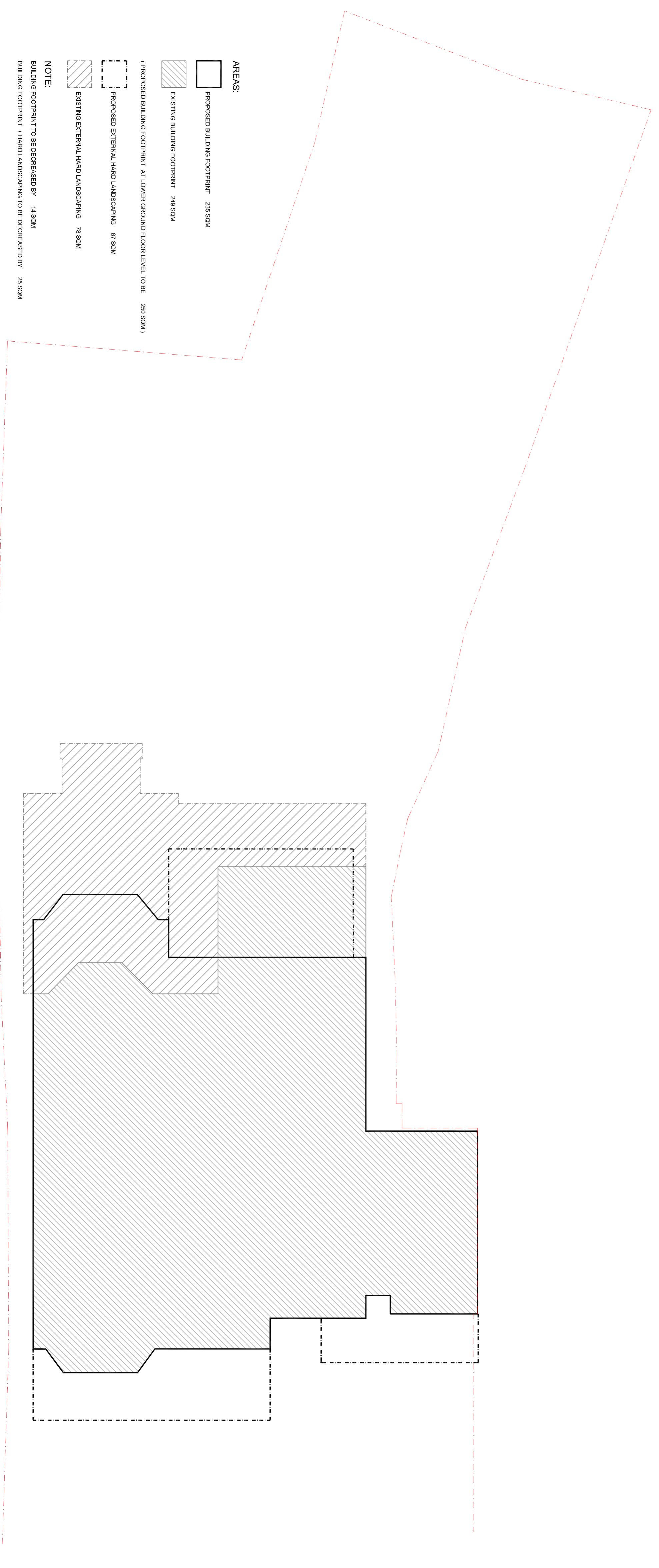

GROUND FLOOR - EXISTING AND PROPOSED FOOTPRINT

AREAS:

- PROPOSED BUILDING FOOTPRINT - 28x30M
- EXISTING BUILDING FOOTPRINT - 24x30M
- PROPOSED BUILDING FOOTPRINT AT LOWER GROUND FLOOR LEVEL TO BE - 28x30M
- PROPOSED EXTERNAL HARD LANDSCAPING - 67x30M
- EXISTING EXTERNAL HARD LANDSCAPING - 78x30M

NOTE:
BUILDING FOOTPRINT TO BE DECREASED BY 14.50M
BUILDING FOOTPRINT + HARD LANDSCAPING TO BE DECREASED BY 28.50M

rev.	date	description	NI
A	2013.08.02	Revisions as per Pre-Planning Consultation	NI

Project	PROPOSED SITE PLAN
Drawn by	RS/BC
Checked by	RS/BC
Scale	1:100 @ A1

Do not scale from this drawing. This drawing is copyright.

Upton Plant Architects

billington Green Studios
81-83 Essex Road
billington 1 2SF
London NW3 7PE

T +44 (0)20 7288 1333 E mail@uptonplant.co.uk
F +44 (0)20 7288 0333 W www.uptonplant.co.uk

client: London
project: 44 Ferncroft Avenue
London NW3 7PE

Scale	1:200 @ A3	1:100 @ A1
Drawn by	RS/BC	RS/BC
Checked by	RS/BC	RS/BC
Scale	1:100 @ A1	1:100 @ A1