

rev	details	by	date
T06	Application for planning approval	JA	27.11.12
T07	Construction - Draft	JA	29.11.12
T08	For Construction	OD	11.12.12
T09	For Construction	OD	20.05.13

Notes

1.0 All dimensions in millimeters.

1.1 All dimensions are indicative and need to be confirmed by engineers

1.2 All structural elements are subject to further design by engineers. Drawings are indicative to show general aspirations of External Works surface treatments.

Key

	Perennials / Grass Plant Mix for planters
	Herbaceous/ Perennials/ Grasses
	Buxus hedge - 200(w) x 300mm (h)

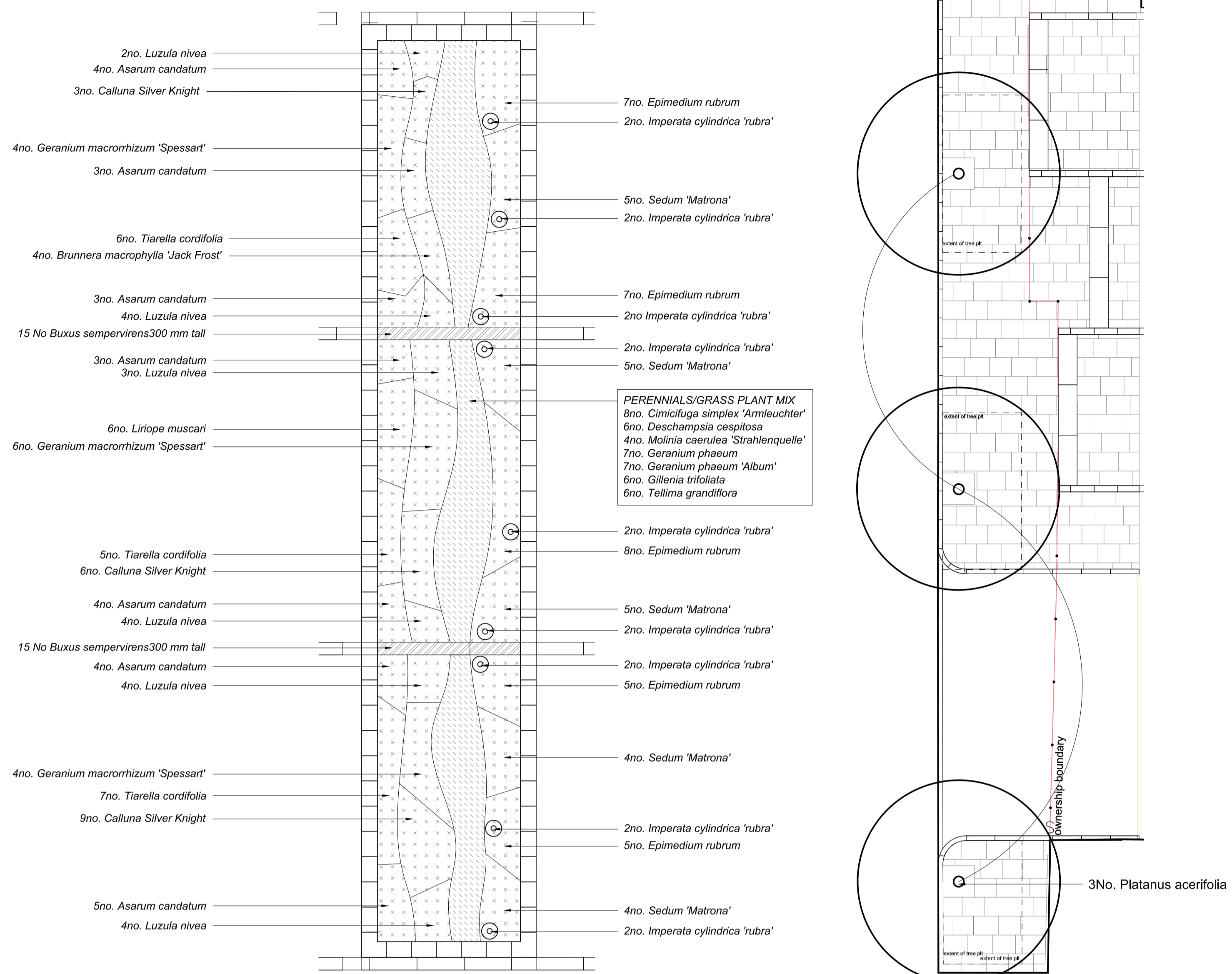

1 Planting Plan
Scale: 1:50 @ A1

2 Planting Plan - Trees
Scale: 1:100 @ A1

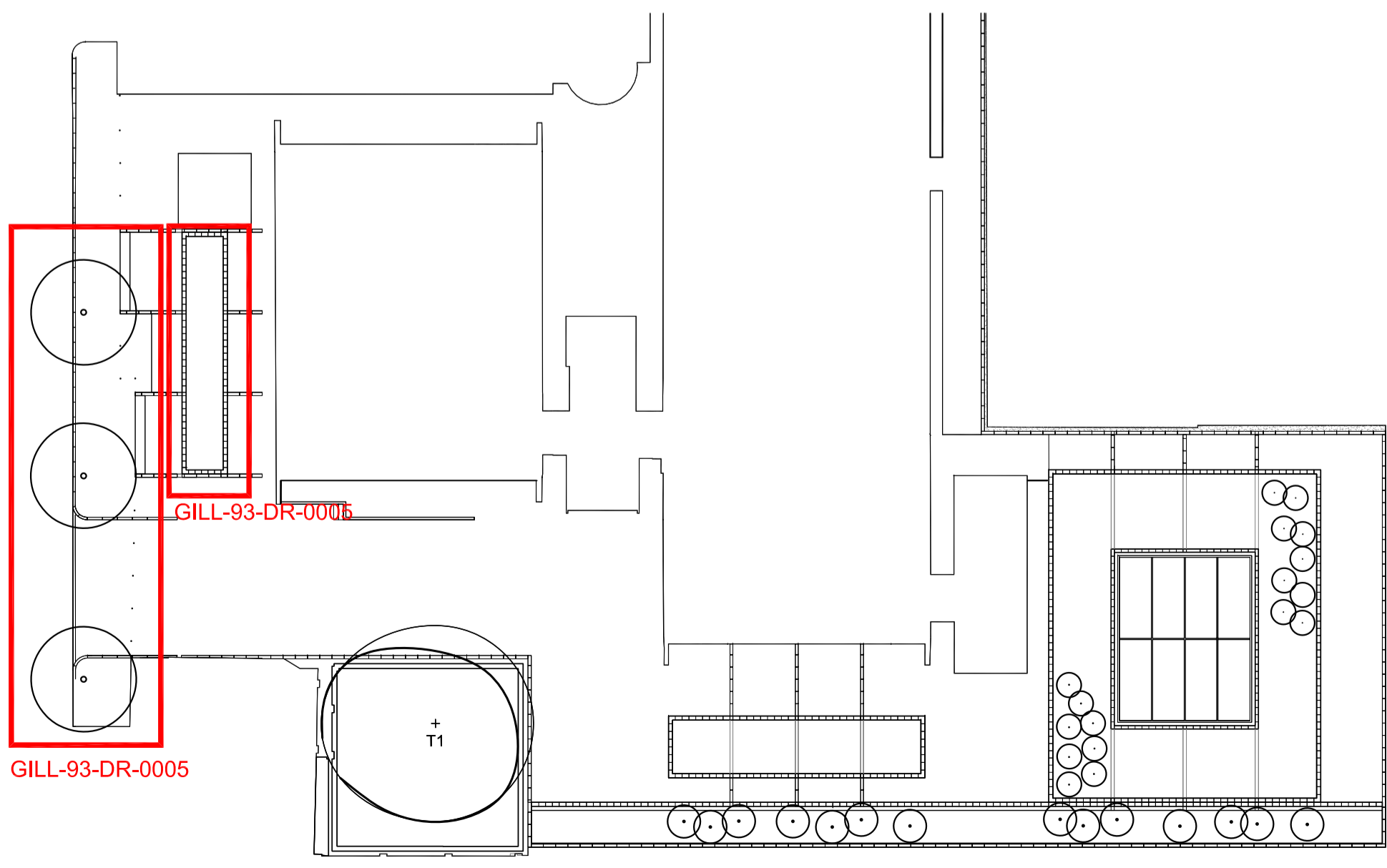

2 Key plan - Planting Plans
NTS

* Buxus sempervirens: Plant stock to be held in isolation for a minimum of three weeks to confirm they are free of 'Box Blight' infection before planting out. Commercial nurseries may use fungicides which suppress but do not kill the fungus and this isolation technique will allow time for any suppressed disease to become visible.

NOTES:

- THIS SCHEDULE TO BE READ IN CONJUNCTION WITH GENERAL ARRANGEMENT PLAN (GILL-90-DR-0001), PLANTING PLANS (GILL-93-DR-005-008).
- ANY SPECIES SUBSTITUTIONS ARE TO BE AGREED WITH THE LANDSCAPE ARCHITECT.
- ANY CHANGES TO PLANT / POT SIZE IS TO BE AGREED WITH THE LANDSCAPE ARCHITECT
- NURSERY STOCK TO BE INSPECTED BY THE LANDSCAPE ARCHITECT TO ENSURE HEALTH, GOOD GROWTH, HABIT & ACCORDANCE WITH SPECIFIED SIZES AND SPECIES.

SPECIES	LATIN NAME	eventual height	colour	flowering time	evergreen / decid	% of mix	COMMON NAME	specification/ pot size	specification/ height	specification/ form	NO. PER METRE SQUARE (unless other measurement stated)	Location/notes
TREES												
	Anelanchier 'Robin Hill'		white	4-5	D		June berry	14-16cms girth	2.5-3.0m high RB 50cm dia, 45cm (h)	Straight, clear stem (1.5m) containerised	Total number: 14 specimen, as shown	Long planter, specimen as plans
	Betula utilis 'Jacquemontii'				D		Birch	14-16cms girth	3m High	Straight, clear stem, containerised	Total number: 17 specimen, as shown	Atrium planter
	Platanus acerifolia				D		London Plane	35-40cm girth	7m, 2.5m clear stem	Straight leader, full & balanced canopy	Total number: 3 specimen, as shown	Montague Place public realm, specimen as plans

HEDGES												
	Buxus sempervirens				E		Common box		200mm x 300mm (h)	bushy, grown as hedge, final clipping onsite following	Pregrown as hedging	Montague Place planter and roof light planter
	Buxus sempervirens				E		Common box		175mm (w) x 300mm (h)	bushy, grown as hedge, final clipping onsite following	Pregrown as hedging	Gallery planter
	Buxus sempervirens				E		Common box		400mm (w) x 450mm (h)	bushy, grown as hedge, final clipping onsite following	Pregrown as hedging	Bedford Square boundary
	Buxus sempervirens				E		Common box		400mm (w) x 600mm (h)	bushy, grown as hedge, final clipping onsite following	Pregrown as hedging	Bedford Square boundary

HERBACEOUS PERENNIALS/GRASSES												planting dist
	Anemone 'Honore Jobert'	perennial	80	White	8-10	D	anemone	2L container		strong root		6
	Asarum candatum	perennial	10	Pink	3-4	E	wild ginger	2L container		strong root		8
	Bergenia 'Baby Doll'	perennial	30-40	Blue	4-5	E	elephants ears	2L container		strong root		6
	Brunnera macrophylla 'Jack Frost'	perennial	25	Blue	5-6	D	siberian bugloss	2L container		strong root		7
	Calluna 'Silver Knight'	heath	30	White	8-9	E	heather	2L container	150-200	strong root		8
	Epimedium rubrum	perennial	30	Red	4-5	E	bishops hat	2L container	150-200	strong root		7
	Geranium macrorrhizum 'Spessart'	perennial	30-40	White	6-7	E	cranesbill	2L container		strong root		5
	Glaum borasi	perennial	40-50	Orange	6-9	E	avens	2L container		strong root		5
	Imperata cylindrica 'rubra'	grass	40	Red	6-8	D	blood grass	2L container		strong root		6
	Liriope muscari	perennial	40	Purple	8-9	E	lily turf	2L container		strong root		8
	Luzula nivea	grass	60	White	6-7	E	snowy woodrush	2L container		strong root		7
	Sedum 'Matrona'	perennial	70-80	Pink	8-10	D	stonecrop	2L container		strong root		6
	Tiarella cordifolia	perennial	25	White	5-6	E	foam flower	2L container		strong root		8

PERENNIALS/GRASS plant mix for planters												planting dist
	Cimicifuga simplex 'Armluechter'	perennial	80-100	White	8-10	D	bugbane	2L container		strong root		5
	Deschampsia cespitosa	grass	50-80	Cream	6-9	E	tufted hair grass	2L container	150-200	strong root		4
	Molinia caerulea 'Strahlenquelle'	grass	80-100	purple	7-9	E	moor grass	2L container	150-200	strong root		5
	Geranium phaeum	perennial	40-60	Purple	5-6	D	duky cranesbill	2L container		strong root		6
	Geranium phaeum 'Album'	perennial	40-60	White	5-6	D	duky cranesbill	2L container		strong root		6
	Gillenia trifoliata	perennial	100	White	6	D	bowmans root	2L container		strong root		7
	Telima grandiflora	perennial	40-60	White	5-6	E	ringcupa	2L container		strong root		6
												100

GROUND COVER MIXES												planting dist
GROUND COVER MIX A												
	Vinca minor	200	Blue		E	20	lesser periwinkle	2L container	150-200	M/S 3 breaks		8 per m2
	Asarum caudatum	200			E	20	wild ginger	2L container	150-200	strong root		Refer to plan
	Epimedium rubrum	250			E	30	bishops hat	2L container	150-200	strong root		Refer to plan
	Fuchsia terminalis	250	White		E	30	japanese spurge	2L container	150-200	bushy		Refer to plan
												100
GROUND COVER MIX B												
	Gaithera shallon	250			E	25	wintergreen	2L container	150-200	bushy		8 per m2
	Vinca minor	200	Blue		E	25	lesser periwinkle	2L container	150-200	M/S 3 breaks		Refer to plan
	Geranium macrorrhizum 'Spessart'	250	White		E	15	cranesbill	2L container	150-200	strong root		Refer to plan
	Geranium phaeum 'Album'	300	White		D	10	duky cranesbill	2L container	150-200	strong root		Refer to plan
	Epimedium rubrum	250			E	25	bishops hat	2L container	150-200	strong root, bushy		Refer to plan
												100
GROUND COVER MIX C												
	Hedera helix 'hibernica'	200			E	40	ivy	2L container	150-200	M/S 3 breaks		8 per m2
	Vinca minor	200	Blue		E	30	lesser periwinkle	2L container	150-200	M/S 3 breaks		Refer to plan
	Euonymus 'Dart's blanket'	250			E	30	bittersweet	2L container	150-200	bushy		Refer to plan
												100

BULB PLANTING												planting dist
	Allium hollandicum 'Purple Sensation'	80	Purple	5	D							25
	Tulipa 'Ballarina'	60	Orange	4-5	D							50
	Tulipa 'Spring Green'	40-50	Wgreen	4-5	D							50

2 Planting Schedule- covering ALL PLANTING PLANS

Architects
RSH+P
Thames Wharf
Rainville Road
London
W6 9HA

Engineers
Anup
13 Fitzroy Street
London
W1T 4BQ

Engineers
Ramboll Whitby Bird
60 Newman Street
London
W1T 3DA

British Museum WCEC

Project title

Planting Plans: Sheet 1 of 4
Montague Place

Drawing title

CONSTRUCTION	Drawing status	Scale	Drawn
	1:200 @ A1	CF	
	Date	Checked	
	12.10.2010	SR	
	Drawing number	Revision	
GILL-93-DR-0005		T09	
		Client	

World Conservation and Exhibitions Centre