

**APPENDIX D**

**SITE PHOTOGRAPHS**

**La Sainte Union School (25.04.13)**



**Main access route to north of senior block**



**Ash (T18)**

**La Sainte Union School (25.04.13)**



**Existing access road (Ash - T18, to left of picture)**



**Sycamore (T16) and Ash (T17) to RHS of existing road**

**La Sainte Union School (25.04.13)**



**Existing road in relation to T16 and T17**

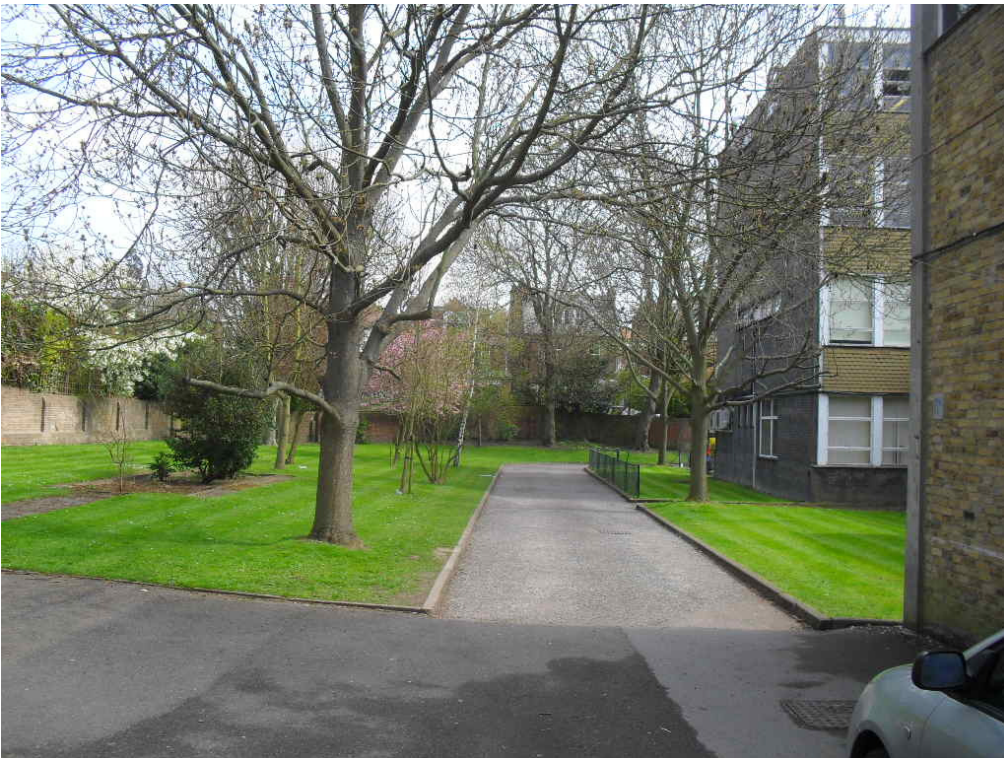

**Access road to the north of the block (T20 in foreground)**

**La Sainte Union School (25.04.13)**



**Newly planted trees to the north of the access road**



**Car park area leading up to site**

**La Sainte Union School (25.04.13)**



**Cherry (T12)**



**Ash (T1)**

# APPENDIX E

## DETAIL OF TREE PROTECTION BARRIER

**BRITISH STANDARD 5837:2012**

**Trees in relation to design, demolition and construction - Recommendations**

Figure 2 Default specification for protective barrier

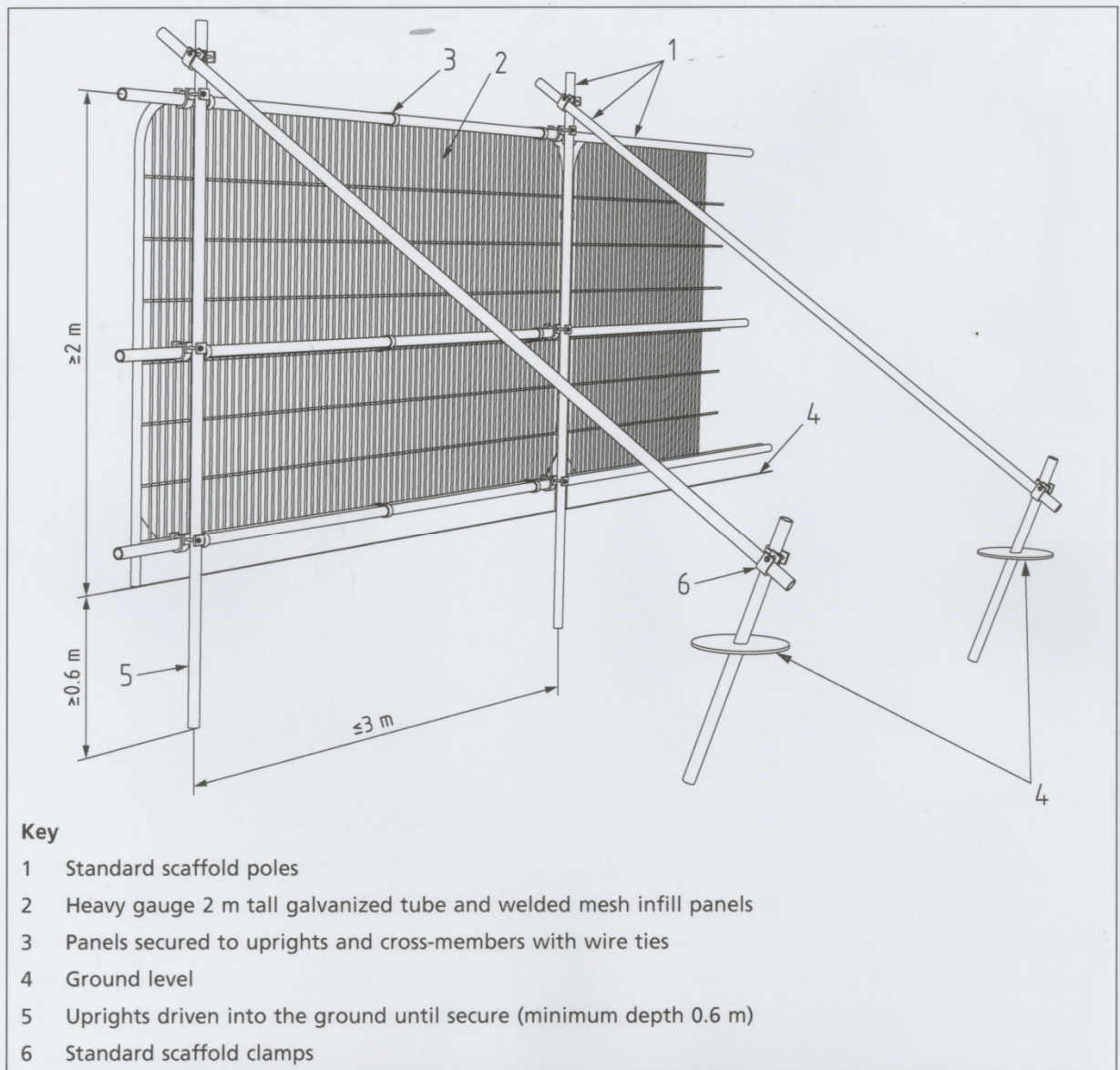



**BRITISH STANDARD 5837:2012**

**Trees in relation to design, demolition and construction - Recommendations**

Figure 3 Examples of above-ground stabilizing systems

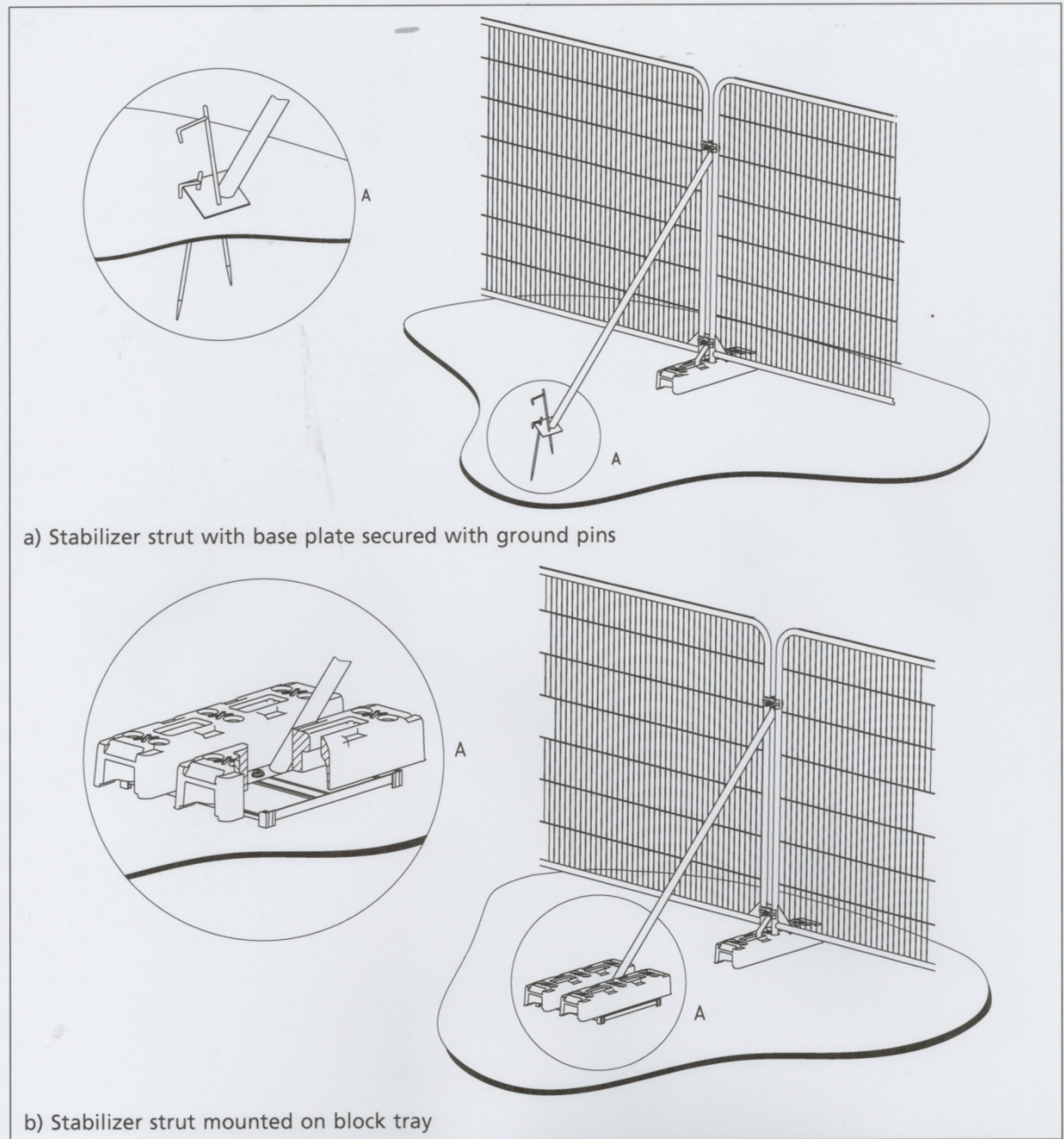

## **APPENDIX F**

# **SITE SUPERVISION CHECKLIST**



## **BS 5837:2012 – Trees in Relation to Design, Demolition and Construction – Recommendations**

### **ARBORICULTURAL SITE SUPERVISION - SUMMARY**

1. Once retained as Arboricultural Consultants for a specific development site, all site monitoring will be undertaken by a suitably qualified and experienced Arboriculturalist.
2. Our Arboriculturalist will be present throughout the key operations to ensure compliance with the Arboricultural Method Statement and Tree Protection Plan. Key operational points will be agreed in writing with the client and LPA prior to commencement of works. Typically these will include;
  - Remedial tree works
  - Installation of protective measures (fences and ground)
  - Installation of site facilities
  - Demolition works
  - Installation of services
  - Landscaping within RPA's
  - Site completion
3. Monitoring will be undertaken on a fortnightly basis as well as ongoing communications with the Client, Site Manager and LPA. A checklist will be completed (*appendix a*) and a copy will be retained by the Site Manager with a copy sent to the LPA.
4. Monitoring visits will generally be unannounced. Upon arrival the Arboriculturalist will check in at the site office and inspect the tree protection measures in conjunction with the Site Manager. The Arboriculturalist will also visit the site at pre-determined dates to view specific operational issues (see above).
5. Any defects requiring attention will be notified to the Site Manager and Client (copied to the LPA by e-mail). Any emergencies will be notified to the Client and LPA by phone.
6. Day to day site supervision will be the responsibility of the Site Manager. They will be aware of the tree protection measures and significant steps in the development process which have arboricultural implications. To ensure compliance the Site Manager will undertake a site briefing with the retained Arboriculturalist before the commencement of works.
7. A final sign off visit will be carried out at the end of the development and a formal letter sent both to the client and the LPA to indicate the end of the monitoring period.



**Arboricultural Monitoring Report Sheet**

(BS 5837:2012 Trees in Relation to Design, Demolition and Construction - Recommendations)

<b>Client</b>		<b>Planning Ref:</b>	
<b>Planning Authority</b>		<b>Date of inspection</b>	

<b>Site Address</b>	

<b>Site Checklist</b>	
<b>Protective fencing in place</b>	
<b>Protective fencing to specification</b>	
<b>Ground protection in place (if applicable)</b>	
<b>Site Foreman briefed</b>	
<b>Tree(s) damaged?</b>	
<b>Remedial works required</b>	

**General Comments:**

**Recommendations:**

**Report sent to LPA:**

**Inspection by:**



**APPENDIX G**

**PROTECTIVE FENCE  
WARNING SIGNS**



**PROTECTIVE FENCING. THIS FENCING MUST BE MAINTAINED IN ACCORDANCE WITH THE APPROVED PLANS AND DRAWINGS FOR THIS DEVELOPMENT.**



**TREE PROTECTION AREA  
KEEP OUT !**

**(TOWN & COUNTRY PLANNING ACT 1990)  
TREES ENCLOSED BY THIS FENCE ARE PROTECTED BY PLANNING CONDITIONS AND/OR ARE THE SUBJECTS OF A TREE PRESERVATION ORDER.  
CONTRAVENTION OF A TREE PRESERVATION ORDER MAY LEAD TO CRIMINAL PROSECUTION**

**ANY INCURSION INTO THE PROTECTED AREA MUST BE WITH THE WRITTEN PERMISSION OF THE LOCAL PLANNING AUTHORITY**

# Ground Protection Measures Light Pedestrian Traffic Only

