

A-4.0

NOTE:
ALL DIMENSIONS TO BE CHECKED ON SITE PRIOR TO ANY WORK COMMENCING DRAWINGS TO BE READ IN CONJUNCTION WITH ALL REFERENCED DRAWINGS, MATERIALS AND FINISHES TO BE CONFIRMED

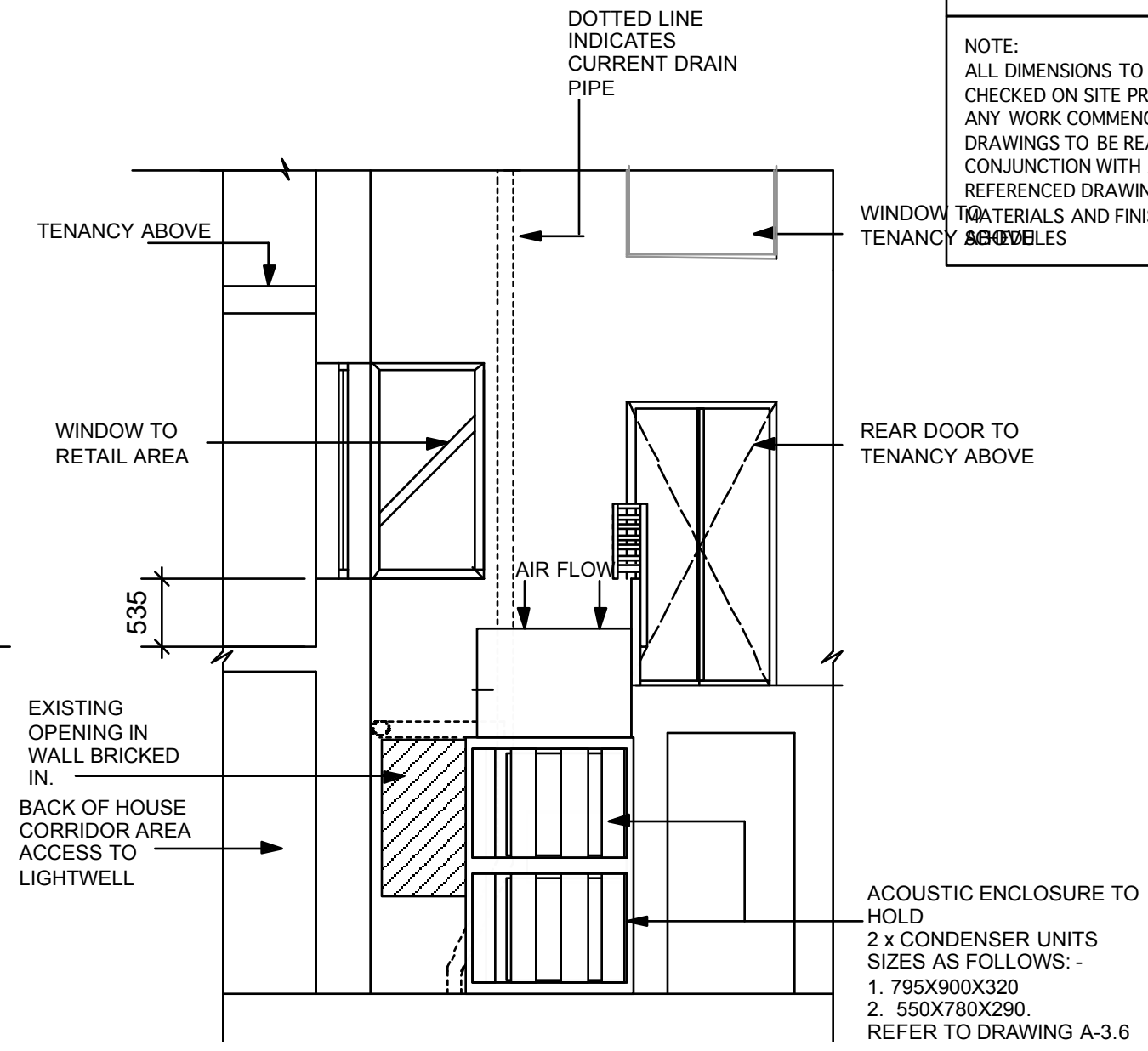
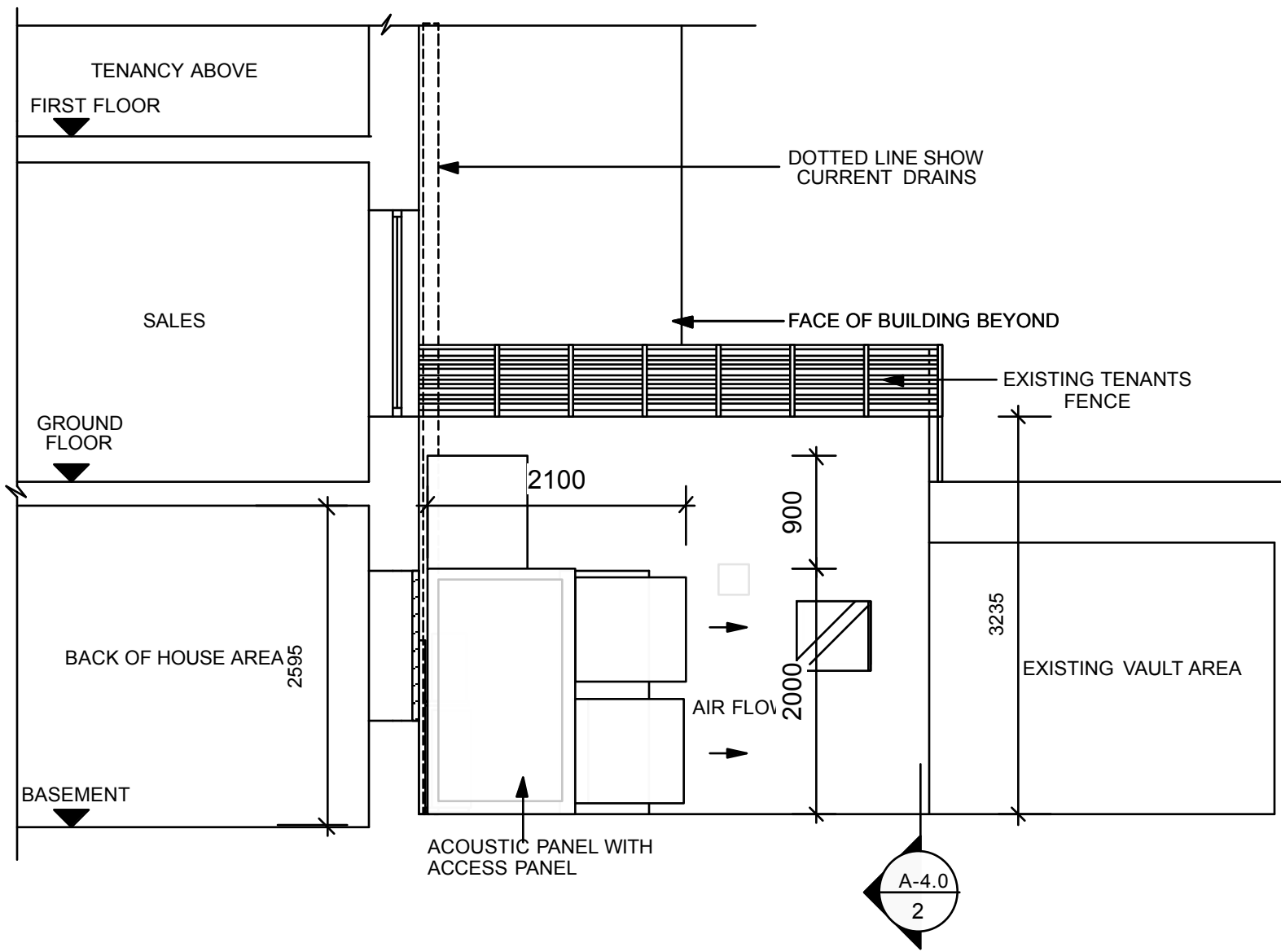

1 PROPOSED LIGHTWELL SECTION
SCALE: 1 : 50 @ A3

2 PROPOSED LIGHTWELL SECTION
SCALE: 1 : 50 @ A3

DRAWING ISSUE FOR PLANNING

Portland Design Associates Ltd First Floor 63 Gee Street London EC1V 3RS T +44(0)20 7017 8780 F +44(0)20 7017 8781			
Revision	Date	Amendment	Signature
Rev A	2.9.13	Attenuator cladding added	CJ
Client: JCREW			
Project: 38 LAMBS CONDUIT STREET, LONDON, WC1N 3LD			
Drawing Title: EXISTING & PROPOSED LIGHTWELL SECTIONS			
Date	Scale	Signature	
01.07.13	1:50 @ A3	CJ	
Job Number	Drawing Number		
04037	A-4.0		
Copyright © 2009 Portland Design Associates Limited All rights reserved			
No part of this design work may be reproduced without prior permission of the copyright owners.			
All dimensions and site levels on this drawing to be checked on site and any discrepancies reported to the designer prior to commencement of the work.			
No dimensions to be scaled from this drawing. If in doubt ask.			