



# Goodge Street

FITZROVIA, W1T

**£450 per week**

Foxtons Park Lane Lettings





## Goodge Street

Fitzrovia, W1T

£450 per week

Located in the heart of the West End, this excellent one bedroomed flat offers well proportioned living space and bright, neutral interiors throughout. The property comprises reception room, modern kitchen, double bedroom and shower room. Goodge Street is home to a wealth of excellent restaurants, eateries and bars and is close to the comprehensive amenities of Oxford Street as well as the attractions of Soho, Covent Garden and Bloomsbury. Transport links include Goodge Street Underground Station (Northern line).

### Third floor

Reception Room 13'6 x 9'8

Kitchen 12' x 10'10

Bedroom 13'6 x 7'6

Shower Room 7'9 x 2'8

Local Authority: *The City of Westminster*

Council Tax: *To be confirmed*

Approx Floor Area: 372 Sq Ft / 34 Sq M

Full details at [Foxtons.co.uk/23629280](http://Foxtons.co.uk/23629280)



**Foxtons Park Lane Lettings**

92 Park Lane, London W1K 7TA

T: 020 7973 2000 F: 020 7973 2001 E: [ParkLane@foxtons.co.uk](mailto:ParkLane@foxtons.co.uk)

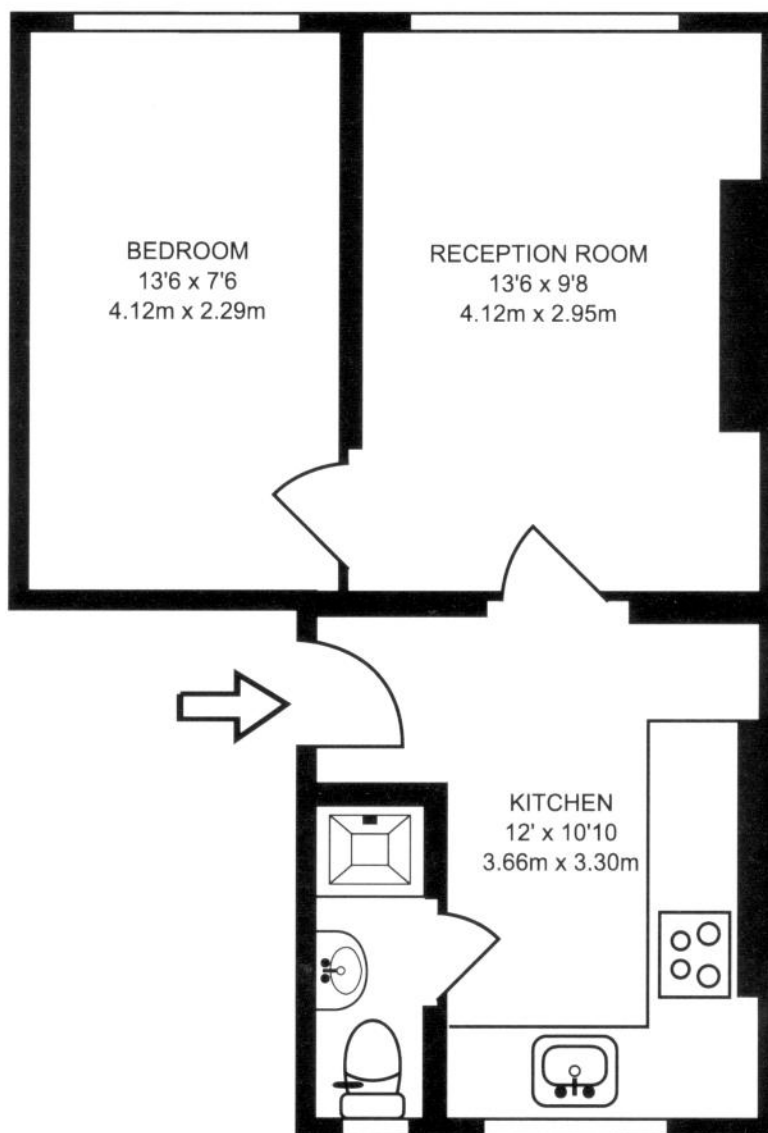

THIRD FLOOR GROSS INTERNAL FLOOR AREA  
372 SQ FT/34.55 SQ M

Representation of current layout, floor area approx 372 Sq Ft (34 Sq M)

#### Foxtons Park Lane Lettings

92 Park Lane, London W1K 7TA

T: 020 7973 2000 F: 020 7973 2001 E: ParkLane@foxtons.co.uk

#### IMPORTANT NOTICE

In accordance with the Property Misdescriptions Act (1991) we have prepared these property particulars as a general guide to a broad description of the property. They are not intended to constitute part of an offer or contract. We have not carried out a structural survey and the services, appliances and specific fittings have not been tested. All photographs, measurements, floorplans and distances referred to are given as a guide only and should not be relied upon for the purchase of carpets or any other fixtures or fittings. Lease details, service charges and ground rent (where applicable) and council tax are given as a guide only and should be checked and confirmed by your Solicitor prior to exchange of contracts. The copyright of all details, photographs and floorplans remain exclusive to Foxtons. (1.15.17799)