

refer to the proposed drawings for the location of all new doors,  
where notes indicate doors to be removed all historic architraves are to be retained  
GROUND FLOOR DOOR KEY (DGxx)

DG01:  
Georgian style decorative fanlight  
with some historic glass,  
may be a later addition (see  
"London's Georgian Houses" by  
Andrew Byrne)

DG02:  
6 panelled timber door hall side,  
inner flush door,  
decorative architrave with Acanthus  
leaf mouldings to frieze on hall side,  
**hardboard pediment to be removed**

DG03: **door & frame to be moved**  
6 panelled timber door,  
modern architrave

DG04:  
6 panelled timber face hall side,  
modern flush face office side,  
profiled architrave on office side,  
decorative architrave with lion  
head motifs on hall side

DG05:  
modern flush door,  
profiled architrave office side

**DG06: to be removed**  
modern wood vertically boarded  
door matching panelling in stairs

**DG07: to be removed**  
modern door with  
obscure glazed vision panel  
to be replaced with new handed  
timber framed fully glazed door

**DG08: to be removed**  
modern flush timber door,  
clear fanlight above

**DG09: to be removed**  
modern flush timber door,  
clear fanlight above

**DG10: to be removed**  
modern flush timber door,  
clear fanlight above

**DG11: to be removed**  
modern 6 panelled timber door

**DG12:**  
new door

GROUND FLOOR  
ROOFLIGHT KEY (RLxx)

**RL01: to be removed**  
modern rooflight

**RL02: to be removed**  
modern rooflight

**RL03: to be removed**  
modern rooflight

**RL04: to be removed**  
modern rooflight

**RL05: to be removed**  
modern rooflight  
BASEMENT DOOR KEY (DBxx)

DB01:  
4 panelled (2 glazed lights) door

DB02:  
modern wood vertically boarded  
door matched to panelling in stairs

DB03:  
modern timber glazed door

**DB04: to be removed**  
modern flush timber door

**DB05: to be removed**  
4 panelled (1 obscure glazed light) door  
to be replaced with new timber framed  
fully glazed door

**DB06: to be removed**  
4 panelled (1 obscure glazed light) door

**DB07: to be removed**  
timber glazed door

DB08:  
metal door

DB09: **to open into courtyard**  
metal door

**DB10:**  
new door

**DB11:**  
new door

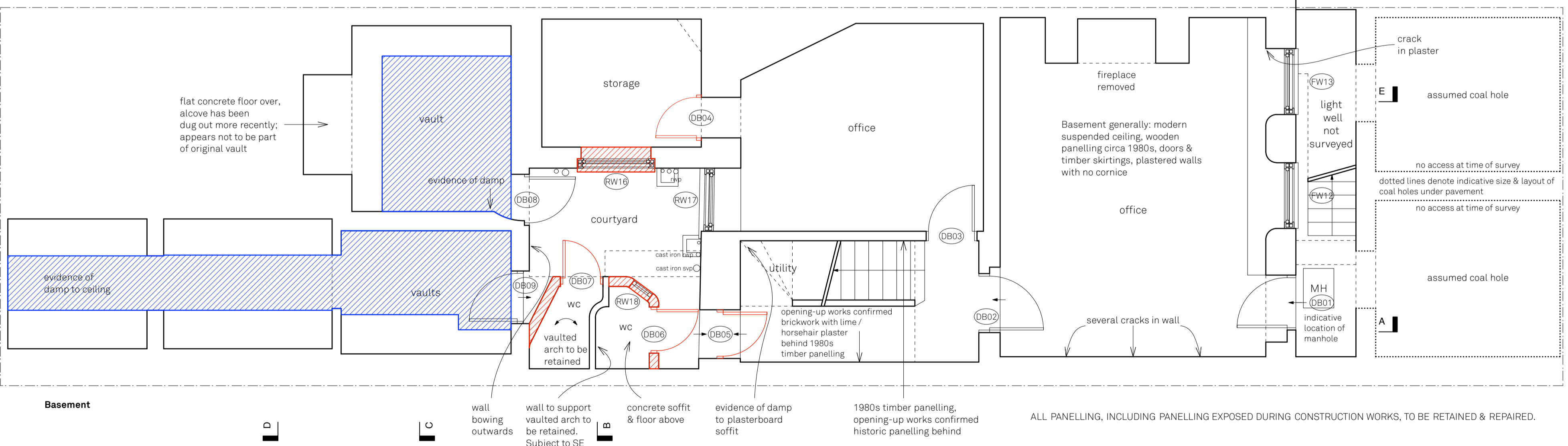
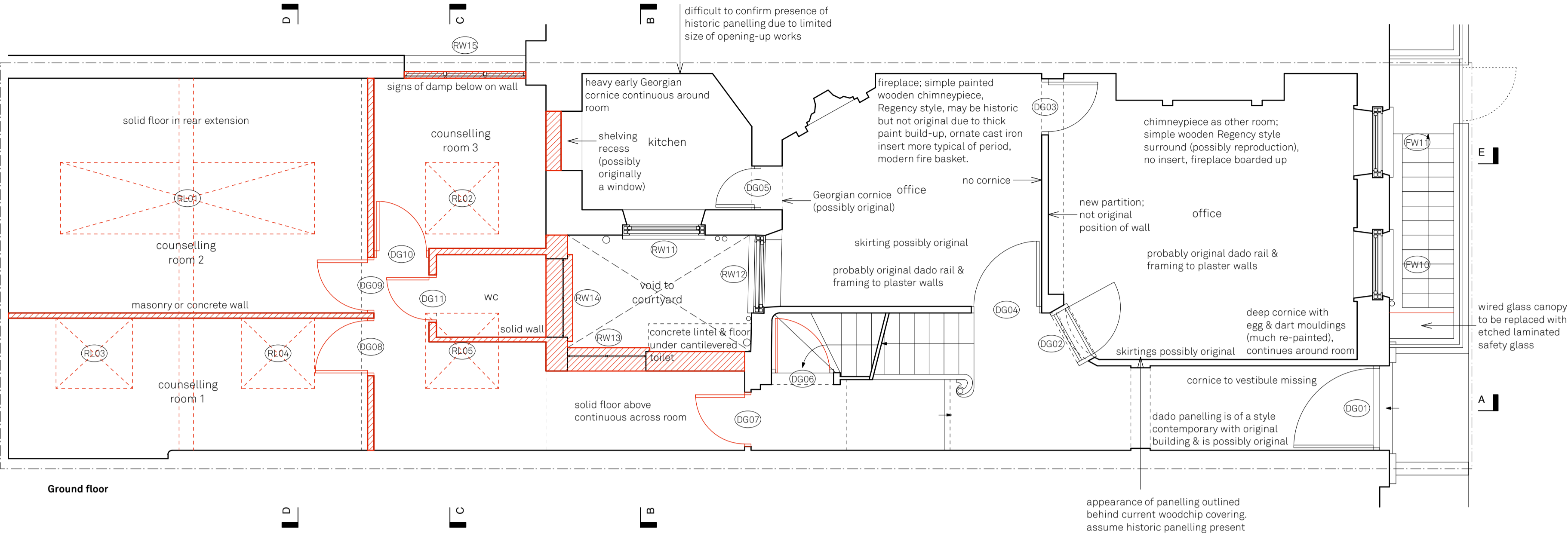

Refer to SE reports dated March & June 2013

Ground floor: Existing joists span direction assumed to be the same as above. Floor occupied at time of SE site visit

Basement: Floor build-up likely to be of stone / concrete construction. Floor occupied at time of SE site visit

line denotes existing solid timber trimmer beam supporting joists

0 1 2 3 4 5M

DEMOLITIONS KEY

hatch denotes walls to be demolished

hatch denotes spoil to be removed

Existing Basement & Ground Floor Demolition Plans

34 Great James Street

Drawn By JKS

Scale 1:50@A2

Status planning

Paul Archer Design Ltd

Issue A Notes planning comments included

Issue B Notes conservation comments included

Date 18.06.13

Date 05.09.13

103 Farringdon Road London EC1R 3BS Tel. 020 3668 2668

www.paularcherdesign.co.uk

563.001/b

paul archer design