

1 2 3 4 5 6 7 8 9 10m

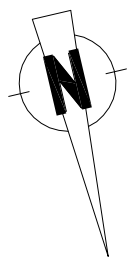

B

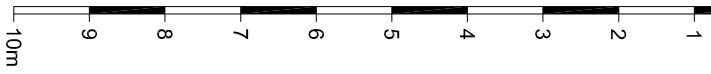
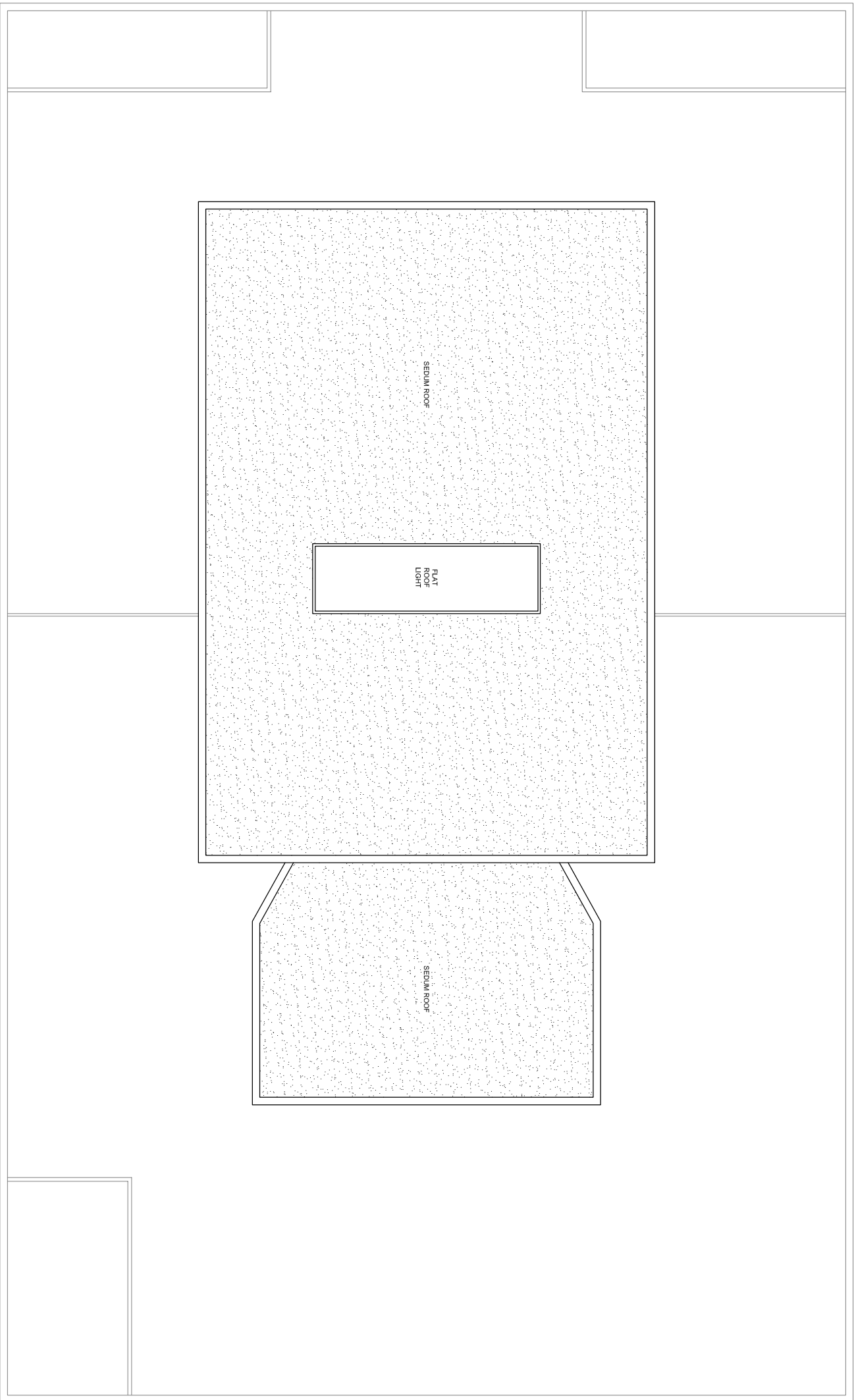

A

A

B



JIM GARLAND ARCHITECTS LTD
ONE DOLPHIN QUAY
EMSWORTH PO10 7BU
01243 370502
01243 378127
email: info@garland.org.uk

Client: Pitton Ltd, 32 Bloomsbury Street, London

2017B Kings College Court, London NW3 3EA

Project: Roof plan proposed

Scale	Date	Drawn	Checked
1:100	03/10/13	JAG	-
Drawing Number	Revision	Sheet Size	
0903/1112	P2	A3	