

Notes:

Legend:

Revision	Description	By	App'd
PT	30-09-13 PLANNING APPLICATION ISSUE	SH	IM

Location Plan:



FOWLER MARTIN
ARCHITECTS ENGINEERS

1-9 Gange Court, The Works
Ingoldshaydon, London WC1E 6BT
T: 02073 358 803
F: 02073 358 804
www.fowlermartin.com

Client: UNIVERSITY COLLEGE LONDON
ESTATES, 1-19 TORRINGTON PLACE
LONDON WC1E 6BT

Project: 1-19 TORRINGTON PLACE
TACTICAL DATA CENTRE

PROPOSED BASEMENT PLAN
LOCATION PLAN

Date:	30-09-13	Designed by:	SH
Page Size:	A0	Approved by:	IM
Scale:	1:100	Drawn by:	SH
File Ref:	1319-PD-002 P1		

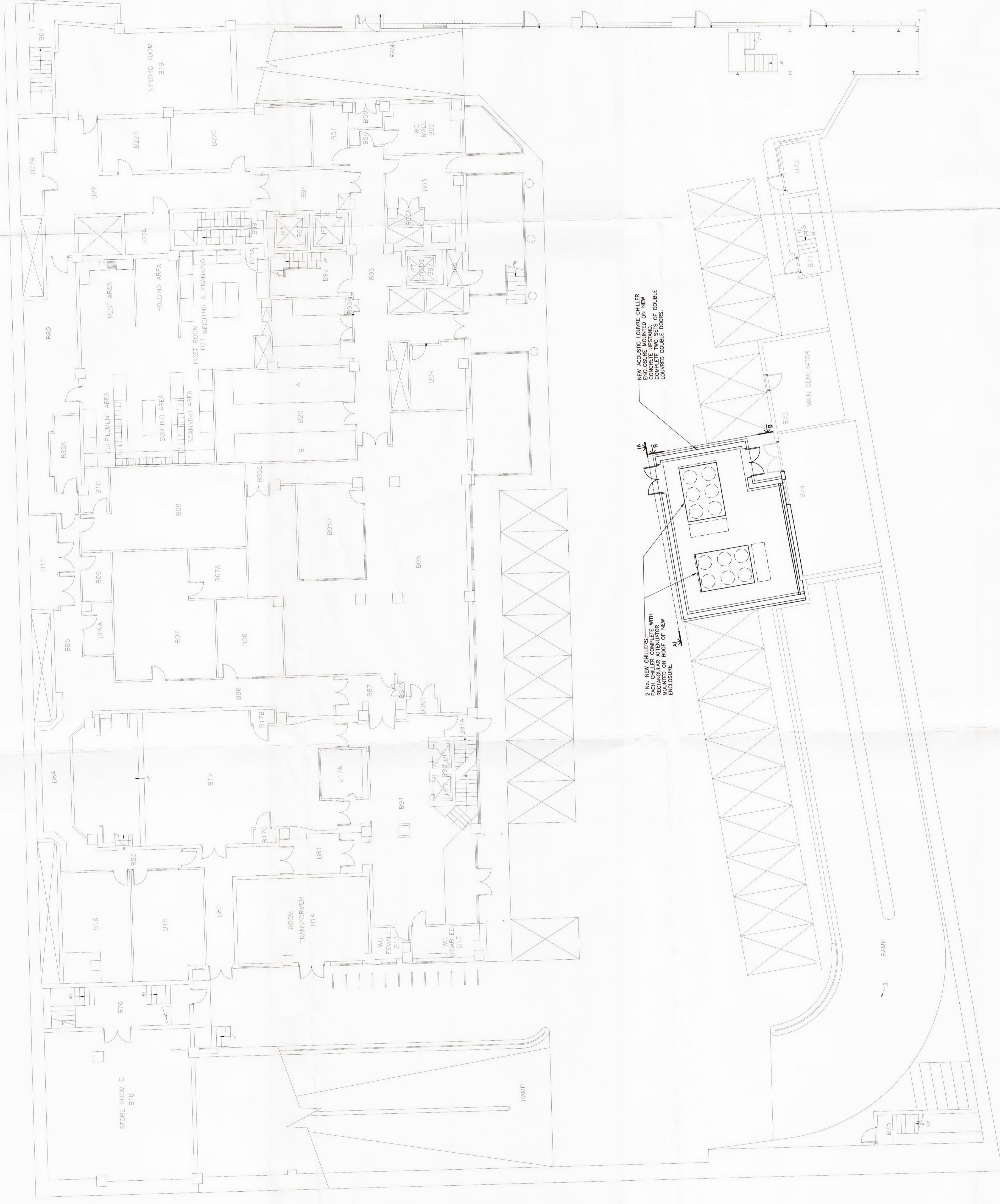

2 No. NEW CHILLERS TO BE WITH RECTANGULAR AIRWAYS LOCATED ON ROOF OF NEW ENCLOSURE.

NEW ACoustic LOUVER CHILLER ENCLOSURE MOUNTED ON NEW COMPLETE TWO SETS OF DOUBLE LOUVER DOUBLE DOORS.

