

SITE PLAN

Hatched thus denotes existing area to be retained

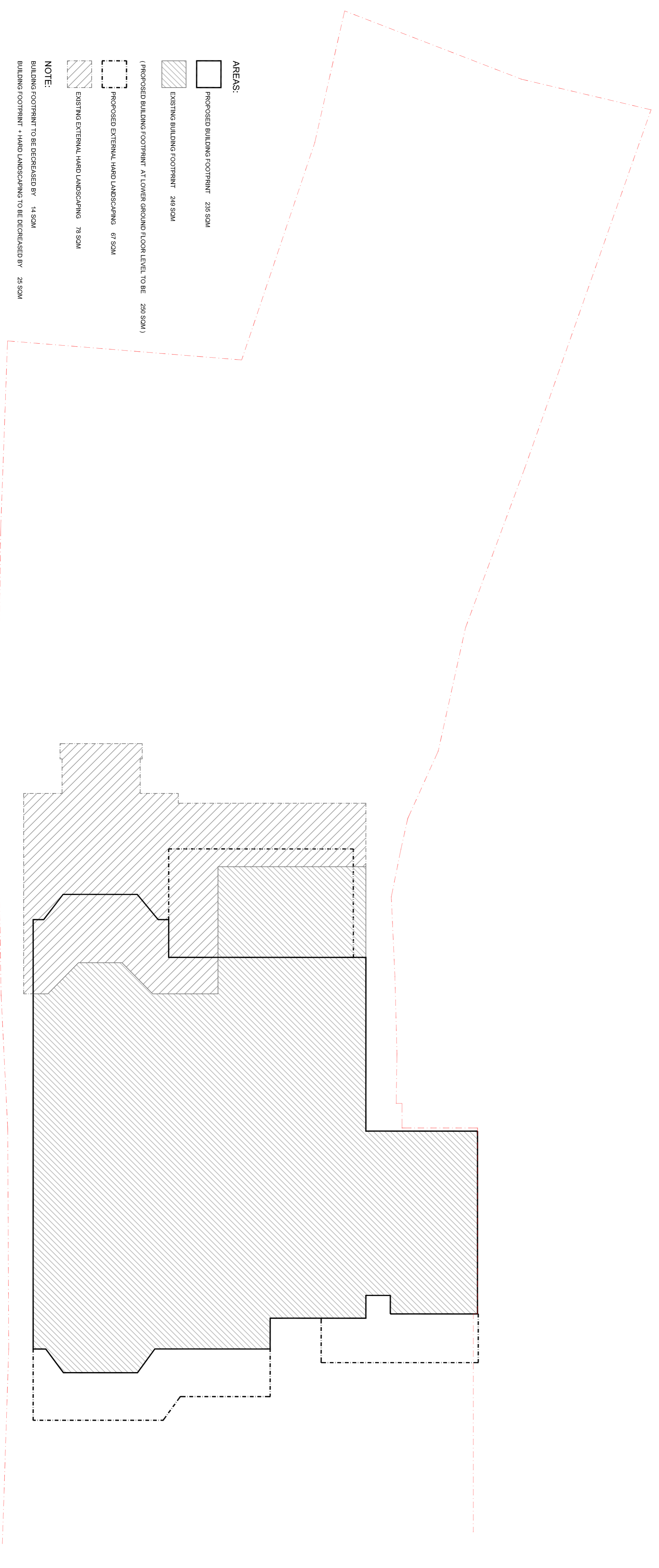

GROUND FLOOR - EXISTING AND PROPOSED FOOTPRINT

AREAS:

PROPOSED BUILDING FOOTPRINT - 285 SQM

EXISTING BUILDING FOOTPRINT - 249 SQM

PROPOSED BUILDING FOOTPRINT AT LOWER GROUND FLOOR LEVEL TO BE - 293 SQM

PROPOSED EXTERNAL HARD LANDSCAPING - 67 SQM

EXISTING EXTERNAL HARD LANDSCAPING - 78 SQM

NOTE:

BUILDING FOOTPRINT TO BE DECREASED BY - 14 SQM

BUILDING FOOTPRINT + HARD LANDSCAPING TO BE DECREASED BY - 28 SQM

rev.	date	description	NI
B	2013.10.25	Revisions as per Planning Comments	NI
A	2013.08.02	Revisions as per Pre-Planning Consultation	NI

DATE	DESCRIPTION	BY	REVISION
2013	PROPOSED SITE PLAN	RS/BC	B

Do not scale from this drawing. This drawing is copyright.

**Upton Plant Architects**

billington Green Studios  
81-83 Essex Road  
billington London N1 2SF  
t +44 (0)20 7298 0333 e mail@uptonplant.co.uk  
f +44 (0)20 7298 0333 w www.uptonplant.co.uk

client: London  
project: 44 Ferncroft Avenue  
London NW3 7PE

SCALE	DRAWN BY	CHECKED BY	DRAWING NO.	REVISION
1:200 @ A3	RS/BC	RS/BC	258 (1) 1.000	B
1:100 @ A1				