

Information contained within this drawing is the sole copyright of 21st Architecture Ltd. and is not to be reproduced without express permission. No part of this drawing is to be used for any other or unrelated purposes. Do not scale from this drawing. All dimensions & levels are to be checked on site by the architect. Issues for purposes indicated only. Drawing errors and omissions to be reported to the architect.

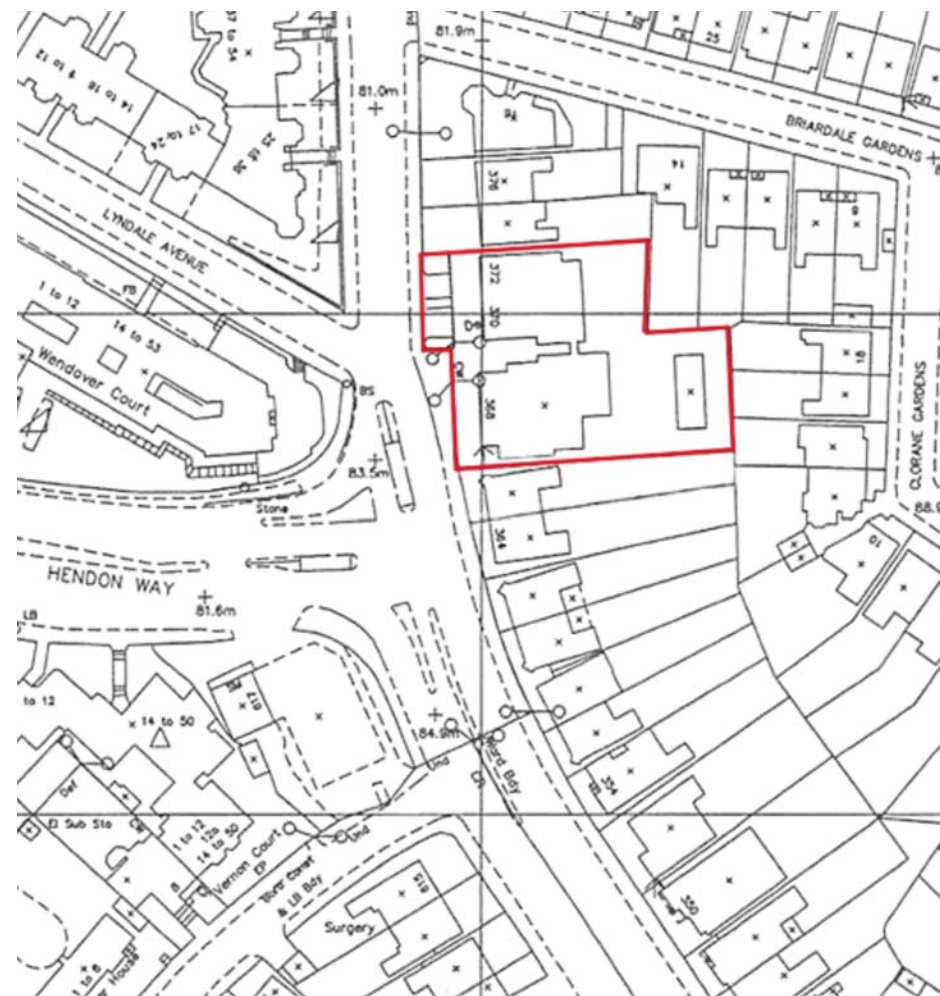

P1 Issued for Planning 02.03.12 SG

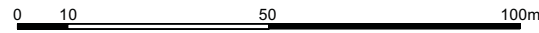
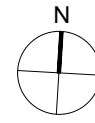

Twenty First Architecture Ltd.
30 Underwood Street
London
N17 1JQ
Tel: +44(0)20 7324 2662
www.21starchitecture.com

Client Jewish Care

Project Kay Court
368-372 Finchley Road

Drawing Title Kay Court
Site Plan

Drawn	Checked
Planning	ZA
	PK
Scale	Date
1:1000@A3	Aug 2011

APPROVED DRAWING