

Information contained within this drawing is the sole copyright of 21st Architecture Ltd. and is not to be reproduced without express permission. No implied licence exists. This drawing not to be used for land transfer or valuation purposes. Do not scale from this drawing. All dimensions & levels are to be checked on site by the contractor. Issued for purposes indicated only. Drawing errors and omissions to be reported to the architect.

Notes

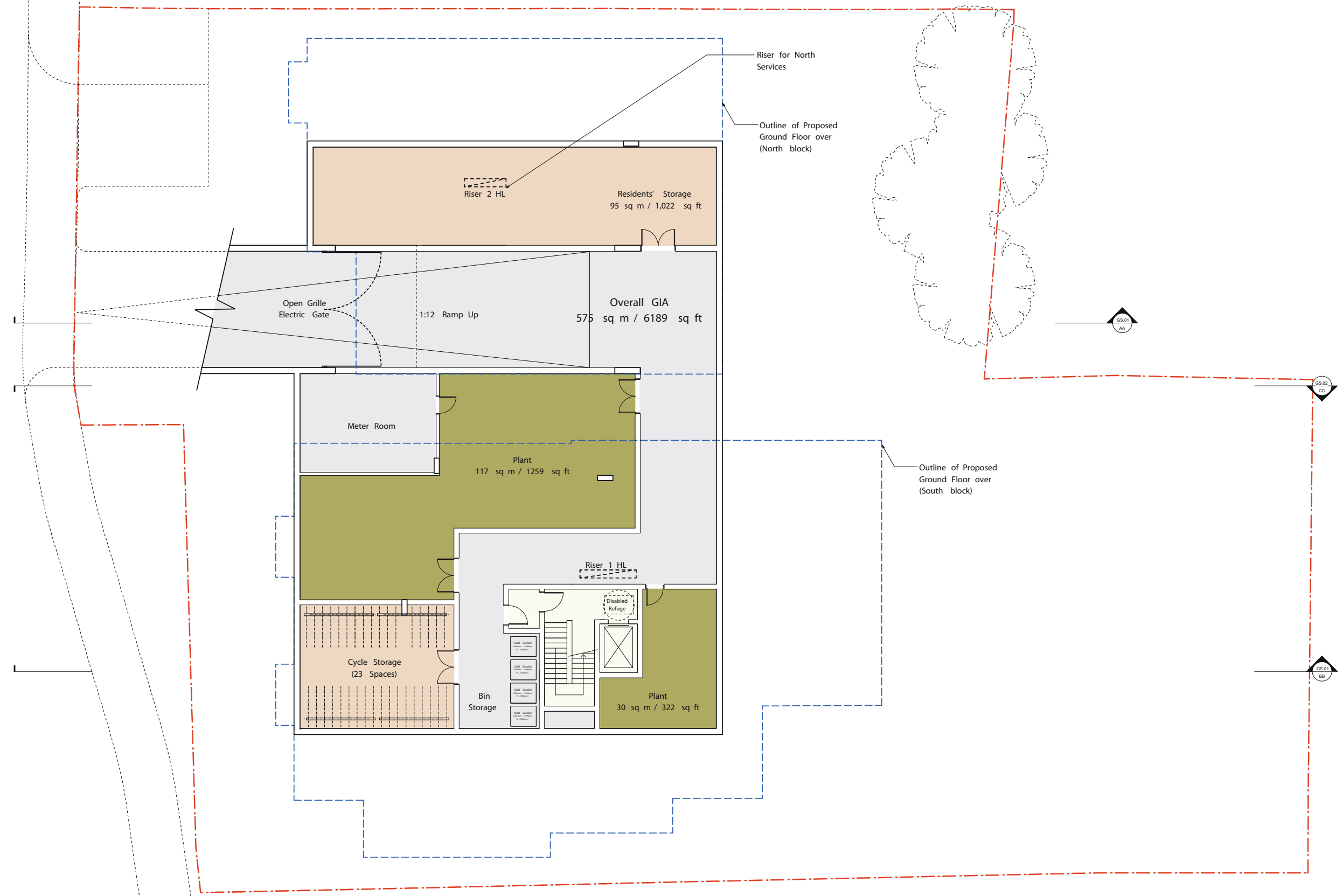
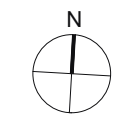

Revision	Description	Date	By
P4	Ramp amended to 1:12 on advice from Planning Officers	30.07.12	AH
P3	Basement area reduced, parking omitted and vents removed on advice from Planning	01.07.12	AH
P2	Issued for Planning	02.03.12	SG
P1	Issued for Comment	09.02.12	ZA

**21st Architecture Ltd**

Twenty First Architecture Ltd,  
314 Goswell Road  
London, EC1V 7AF  
Tel: +44(0)20 7952 0252  
www.21starchitecture.com

Client: Jewish Care

Project: Proposed Residential Development at Kay Court, 368-372 Finchley Road

Drawing Title: Kay Court Basement Floor Car Park

Status	Drawn	Checked
Planning	ZA	PK

Scale: 1:100@A1 1:200@A3 Date: February 2012

APPROVED BASEMENT DRAWING