

No.17 Monmouth Street

Do not scale from this drawing, except for town planning purposes.
 Work to figured dimensions only.
 This drawing is the property of Brimelow McSweeney Architects and copyright is reserved by them.
 This drawing is issued on condition that it is not copied, used or disclosed by or to any unauthorised person without the prior written consent of Brimelow McSweeney Architects.
 The areas on the drawing have been measured directly from a CAD drawing and have no tolerances added or subtracted.
 The areas have been calculated in accordance with the Code of Measuring Practice, 6th Edition (2007) using the stated options NIA, GIA, GEA. They are approximate and relate to the likely areas of the building at the current state of the design. Any decisions to be made on the basis of these predictions, whether as to project viability, pre-letting, lease agreements and the like, should make allowance for the following:
 - Design development
 - Accurate site survey, site levels and dimensions need to be fully evaluated
 - Allowance for construction methods and building tolerances.
 - Local authority consents
 rev date drawn by checked description
 / 05.12.13 DPF SE PLANNING ISSUE

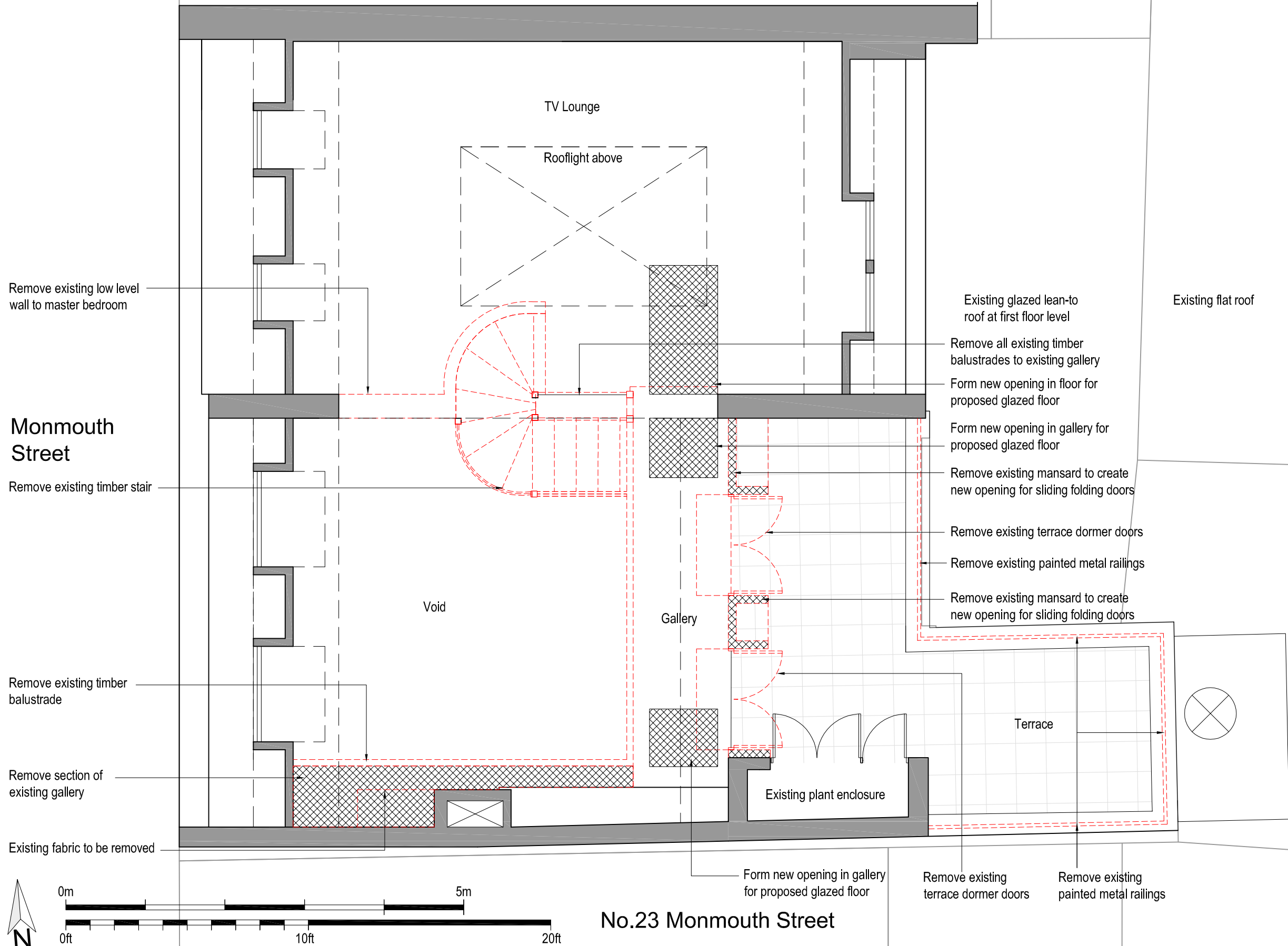

Existing flat roof

Remove existing low level wall to master bedroom

Monmouth Street

Remove existing timber stair

Remove existing timber balustrade

Remove section of existing gallery

Existing fabric to be removed

TV Lounge

Rooflight above

Void

Gallery

Existing plant enclosure

Existing glazed lean-to roof at first floor level

Remove all existing timber balustrades to existing gallery

Form new opening in floor for proposed glazed floor

Form new opening in gallery for proposed glazed floor

Remove existing mansard to create new opening for sliding folding doors

Remove existing terrace dormer doors

Remove existing painted metal railings

Remove existing mansard to create new opening for sliding folding doors

Terrace

Form new opening in gallery for proposed glazed floor

Remove existing terrace dormer doors

Remove existing painted metal railings

No.23 Monmouth Street

Demolition Key

- Fabric to be removed
- Formation of new opening
- Fabric to be reinstated

status **FOR PLANNING**

BRIMELOW McSWEENEY ARCHITECTS

28 Great Queen Street, Covent Garden, London WC2B 5SL
 tel: 020 7831 7835 - fax: 020 7831 7839 - email: admin@brim-architects.co.uk

project
 19-21 Monmouth Street
 WC2H 9DD

title
 Fourth Floor Plan
 Demolition

scale 1:50@A3 date 05-12-13 drawn DPF

drawing no. 1341-0901 revision /