

Notes: Do not scale from this drawing. Contractor to take and check all dimensions on site before work commences. Discrepancies to be reported to architect. Subcontractors to verify all dimensions on site before making shop drawings or commencing manufacture. This drawing is copyright.

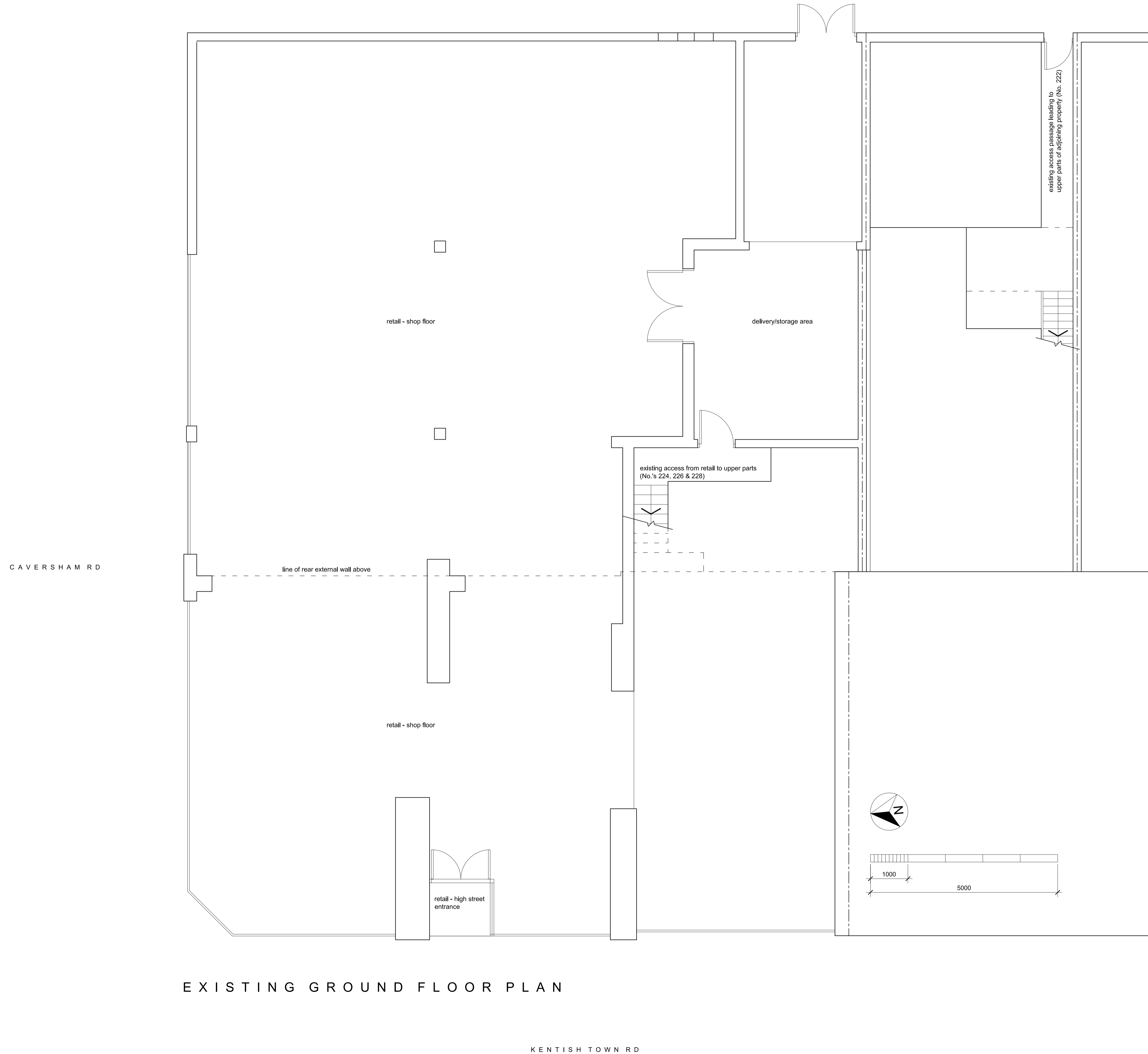

EXISTING GROUND FLOOR PLAN

Rev	Description	Date	Initial
A			

Prime Meridian
Architects and Structural Engineers

Sutherland House 5-6 Argyl St London W1F 7TE architects@prime-meridian.co.uk T 020 7494 3522 F 020 7494 3533

The Priory, Draycott Rd Shipton Mallet Somerset BA4 5HS www.primemeridian.co.uk T 01749 34 66 99 F 01749 34 66 77

- Preliminary
- Planning
- For Information
- Tender
- Contract
- Construction
- Drawn: DB
- Checked:
- Scale: 1:50 @ A1
- Created: FEB, 2013
- Plot Date:

Client: **KENNY PROPERTIES LTD.**

Project: **222-228 KENTISH TOWN RD. LONDON NW5 2AD**

Title: **EXISTING GROUND FLOOR PLAN**