

Notes

*It should be noted that this drawing has been interpreted from survey information supplied by Plowman Craven.*

**FOR UPDATED BACKGROUND INFORMATION REFER TO GA ELEVATIONS**

To be read in conjunction with 1012(SP)001, 002, 004, 007, 013; (FS) Series; (20) Series for updated backgrounds and ARUP Facades specification.

- Cladding Type 1  
Refer to ARUP Facades specification
- Cladding Type 2  
Refer to ARUP Facades specification
- Cladding Type 3  
Refer to ARUP Facades specification
- Cladding Type 4  
Refer to ARUP Facades specification
- Cladding Type 5  
Refer to ARUP Facades specification
- Cladding Type 6 (Louvre)  
Refer to ARUP Facades specification
- Louvre Panel System  
Refer to L10/650
- Brickwork  
Refer to F10/110
- Rainscreen  
Refer to H31/127
- External Door/Gate  
Refer to (31) Series.
- Existing concrete panel - To be removed and replaced by new concrete panel (to match existing).
- Existing Concrete Panel - To be cut and retained.
- Halo louvred panels

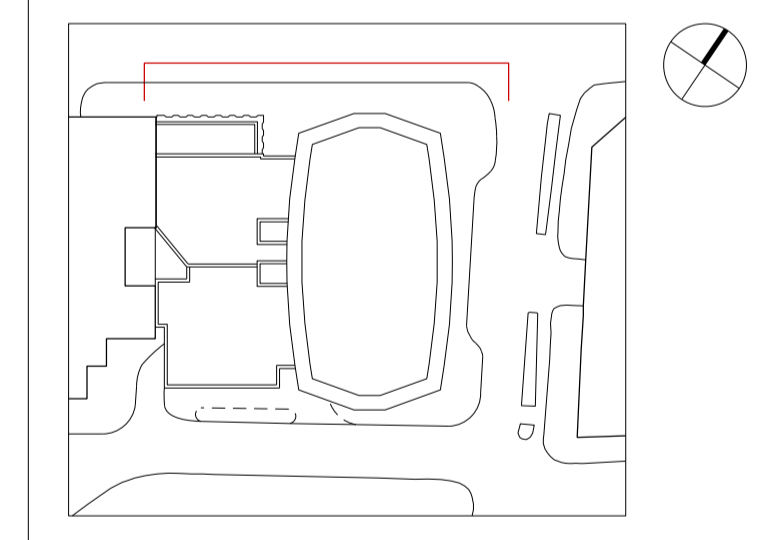

**Bennetts Associates Architects**

1 Rawstorne Place London EC1V 7NL  
 T +44 (0)20 7520 3300 F +44 (0)20 7520 3333  
 E mail@bennettsassociates.com

For Bennetts Associates' electronic information issue disclaimer -  
 www.bennettsassociates.com/informationanddisciplinair

Project Project No. 1012

**One Mabledon Place**  
 Stanhope Plc

Drawing Title  
 Proposed  
 Building Elevation  
 North  
 Cladding Types

Drawing Number	Revision
1012_F21_E01	A

Scale @ A3	Scale @A1	Revision Date
1 : 200	1 : 100	130913