

**The Ancient House,**  
2 Church Lane,  
Walthamstow,  
London, E17 9RW  
Tel: 020 8524 7800  
Email: [info@mattheweylesarchitects.com](mailto:info@mattheweylesarchitects.com)  
Web: [www.mattheweylesarchitects.com](http://www.mattheweylesarchitects.com)

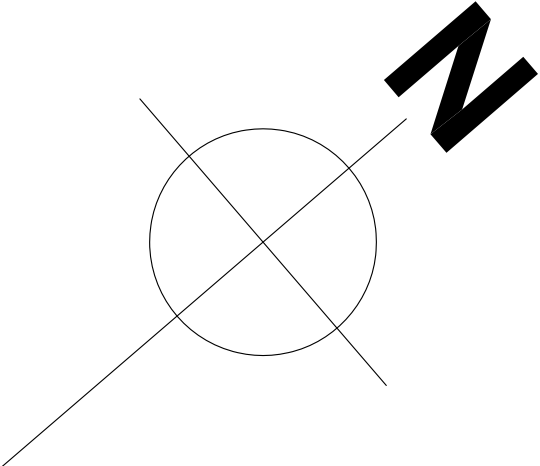

NOTES

Note: All areas in square metres. All areas stated are approximate.

Note: All dimensions in millimetres. All dimensions given are approximate and maximum. Subject to brick/block dimensions and existing site dimensions.

Any discrepancy between site dimensions and the dimensions noted here to be referred to the Architect before construction commences

This drawing is prepared solely for design and planning submission purposes. It is not intended or suitable for either Building Regulations or Construction purposes and should not be used for such.

scale

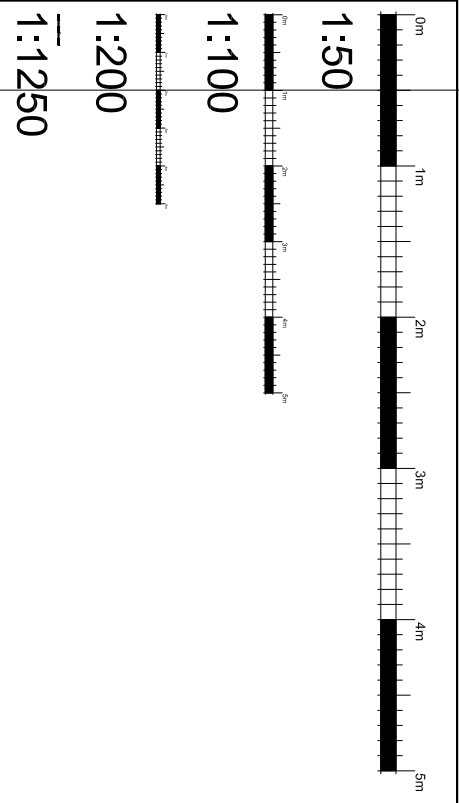

Revision A-(11/12/13): Planning requirements

SCALE: Stated scales will be accurate when printed at A1 from original AutoCAD file.

PLANNING APPLICATION

project	Wellington House, 30 Elton Road, London, NW3 4SY
client	Wellington House (Elton Road) Limited
title	Existing and proposed ground floor plans
scale:	1:100 date: Dec 13 drawn:HH/QM checked: MJE
job:	12127 drawing: 203 revision: B

NOTES:  
Do not scale from this drawing.  
It is recommended to check all planning dimensions and areas on the site before commencing any work or making any site drawings.  
This drawing to be read in conjunction with structural, mechanical and electrical drawings and other relevant information and any other drawings submitted with the planning application.  
Work and materials to be in accordance with the British Standards.  
This drawing has been prepared by Matthew Eyles.  
This drawing is whole or in part without permission.

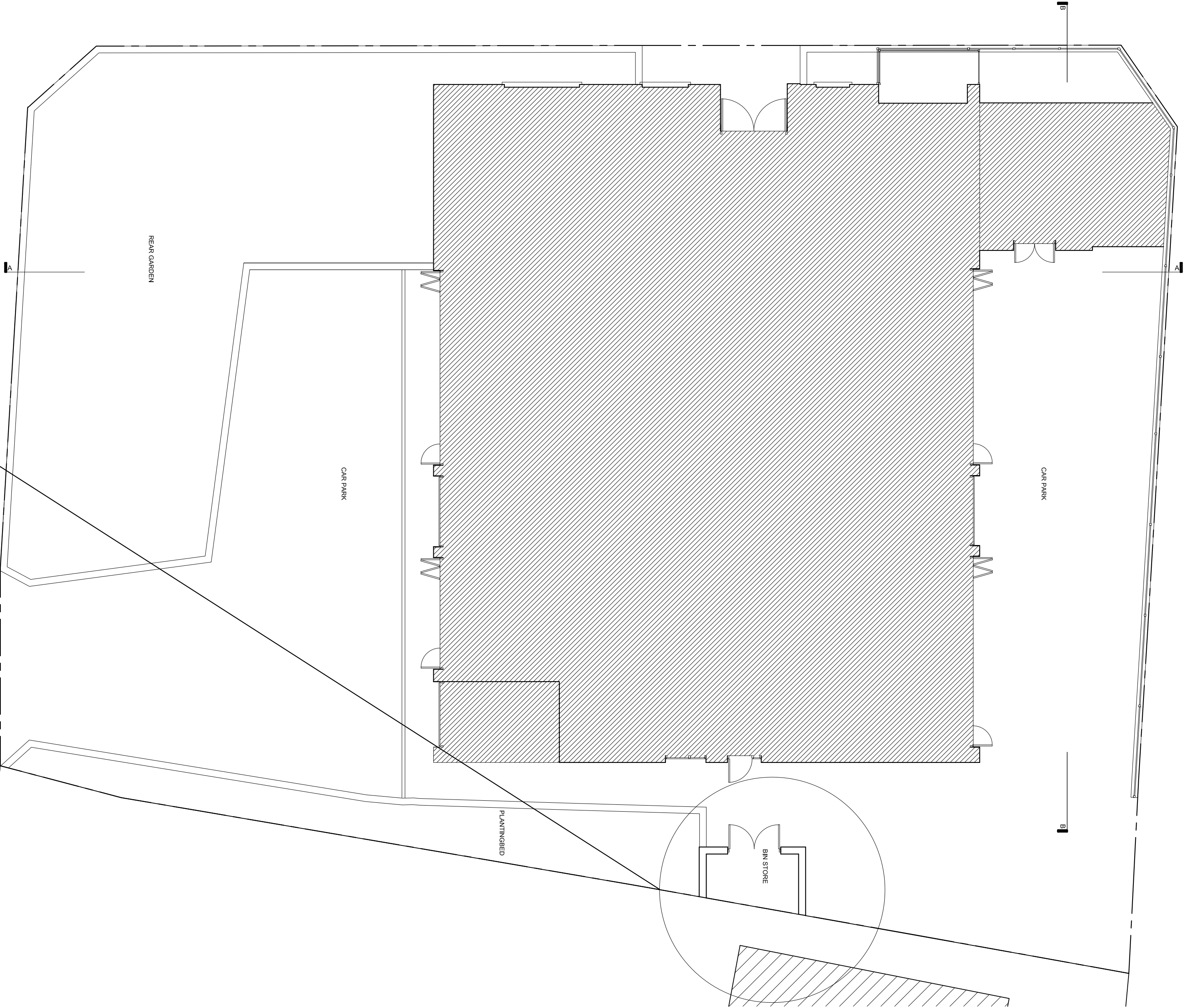

PROPOSED GROUND FLOOR PLAN - 1:100

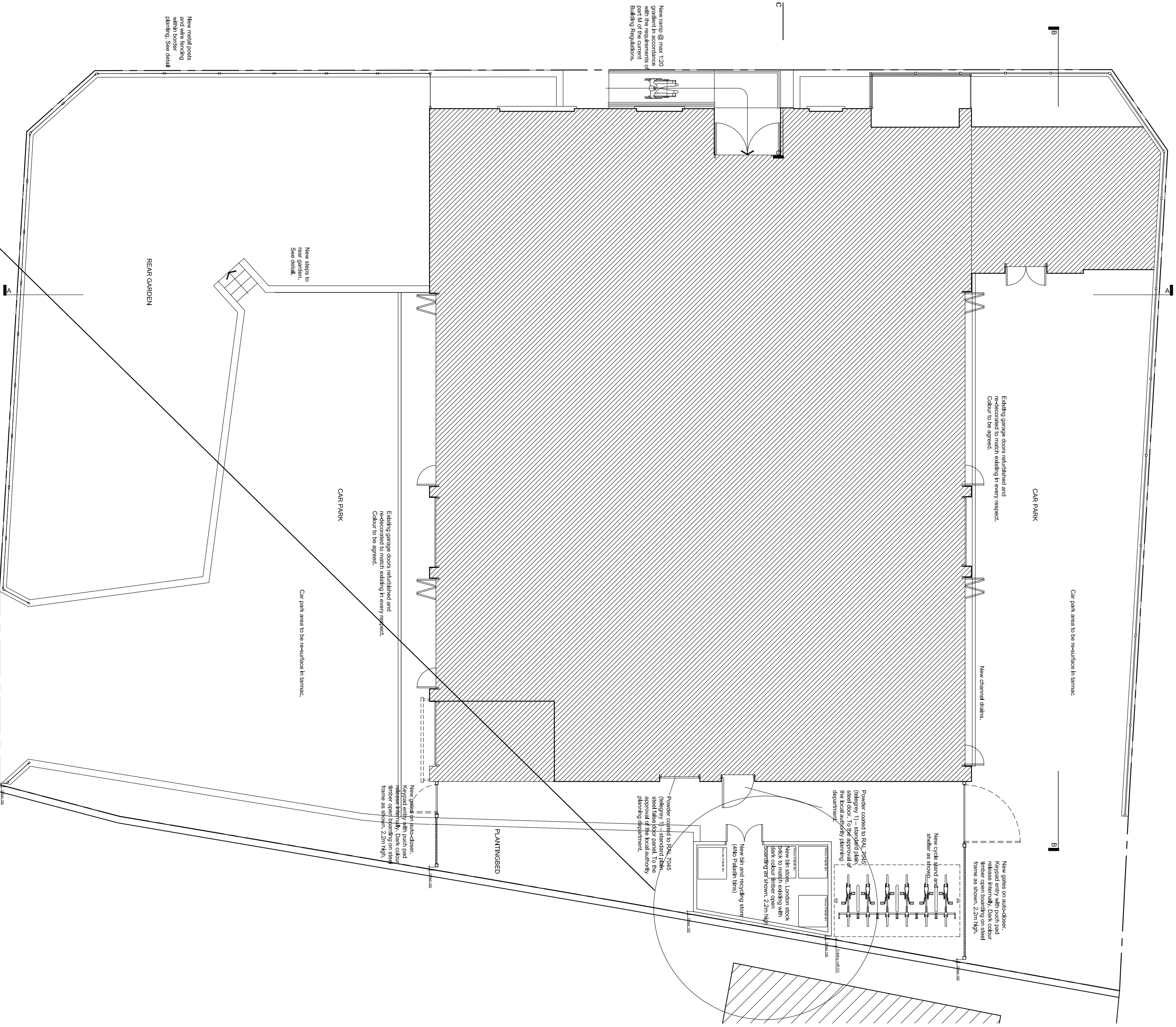

EXISTING GROUND FLOOR PLAN - 1:100

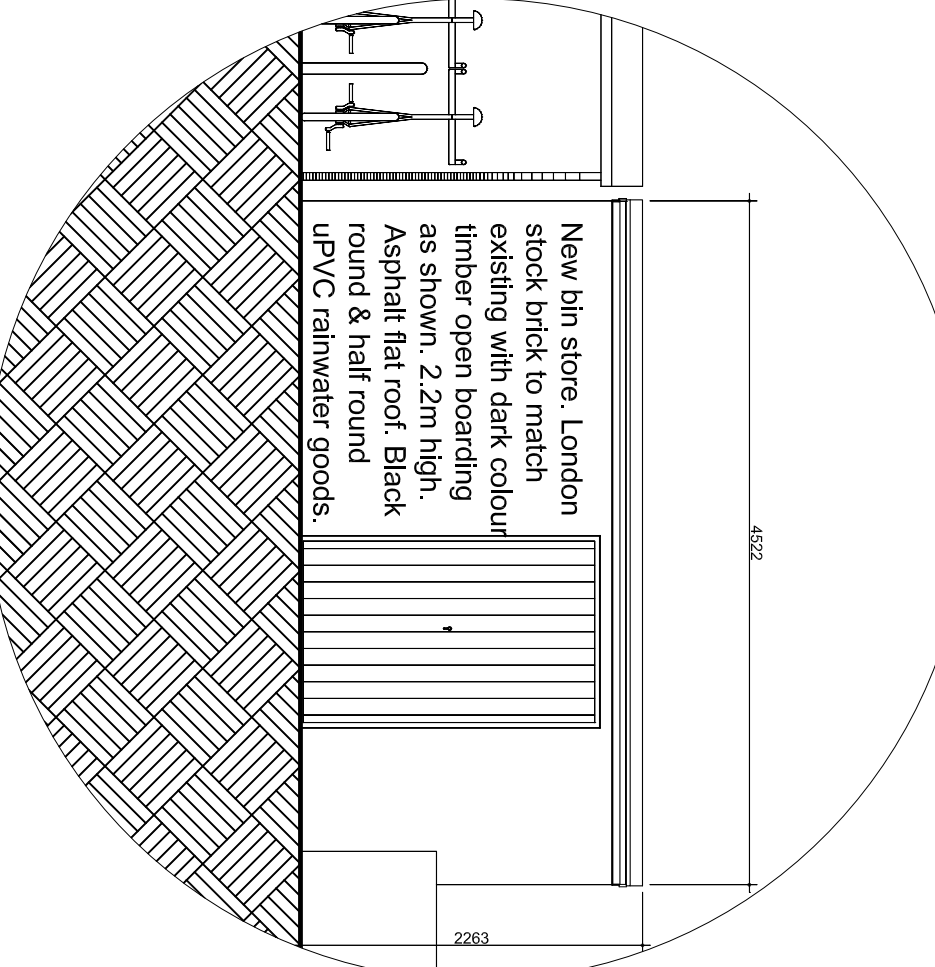
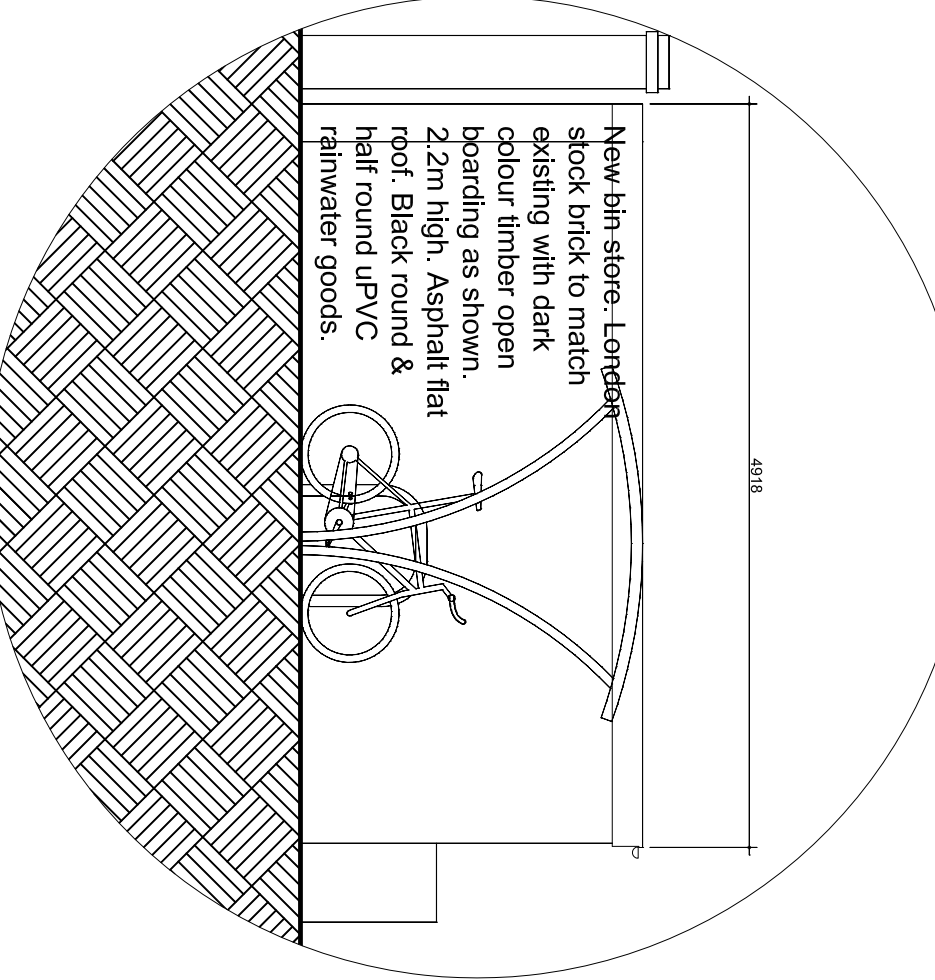
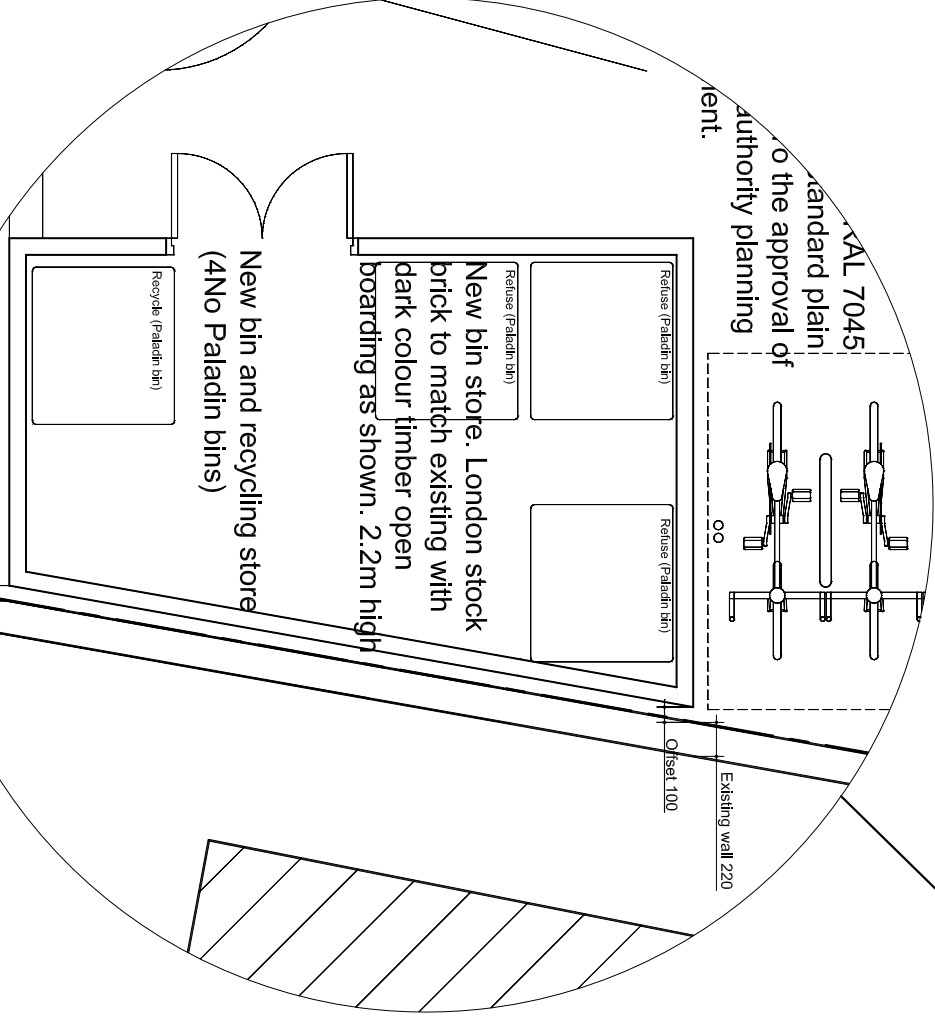
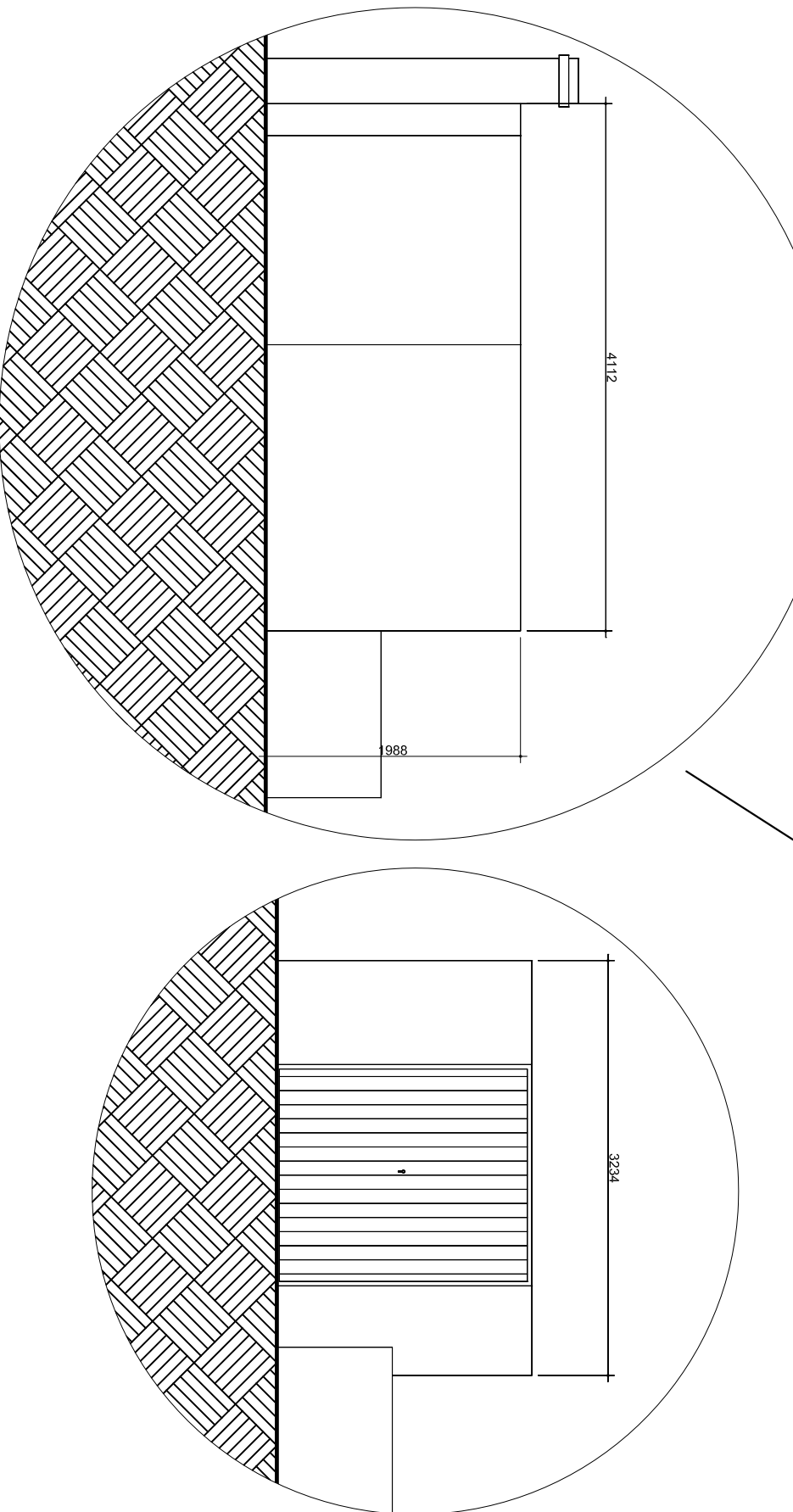

Existing Bin Store Elevations Detail - 1:50

Proposed Bin Store Plan & Elevations Detail - 1:50