

01 North Elevation B1 & B2  
Scale 1:100 @ A0

#### Plot B Material Specification

- Predominant brick type used throughout building - wirecut semi glazed clinker brick, engobe finish. Bond - random on flat areas. Colour - brown/purple/silver variegated brick with a degree of patterning within each brick. Mortar - flush pointed, colour to be determined after review of sample boards
- Vertical stretcher bond to horizontal bands above first floor
- Vertical stretcher bond to top storey window heads
- Castellated brick to top of plot B2
- Corbelled brick arch expressing community hall entrance
- Accent panels. Waterstruck brick, engobe finish. Colour -white with a degree of warm colour tone within each brick. Mortar -flush pointed, colour -white
- Reconstituted stone horizontal bands, polished finish. Colour - white light grey to match accent panel brick
- Cantilevered reconstituted stone canopy with recessed lighting to communal residential entrance, polished finish. Colour - light grey
- Clear glazed communal entrance doors to both the communal lobby, workspace entrance and community hall, with full height glazed windows above. Colour - light bronze/gold
- High quality lighting to communal entrance areas
- Refuse door - perforated anodised aluminium. Colour - light bronze/gold

- Clear glazed window. Frame anodised aluminium. Colour - light bronze/gold
- Window frame set behind brickwork reveal, minimum set back 225mm
- Polyester powder coated steel section ballustrade. Colour - light bronze/gold to match window frames
- Clear glazed balcony door. Frame anodised aluminium. Colour - light bronze/gold
- Decorative tile pattern to community hall entrance. Arched profile continued in the interior
- Slip resistant decorative tile to communal residential entrance and workspace entrance. Pattern on floor continues on walls

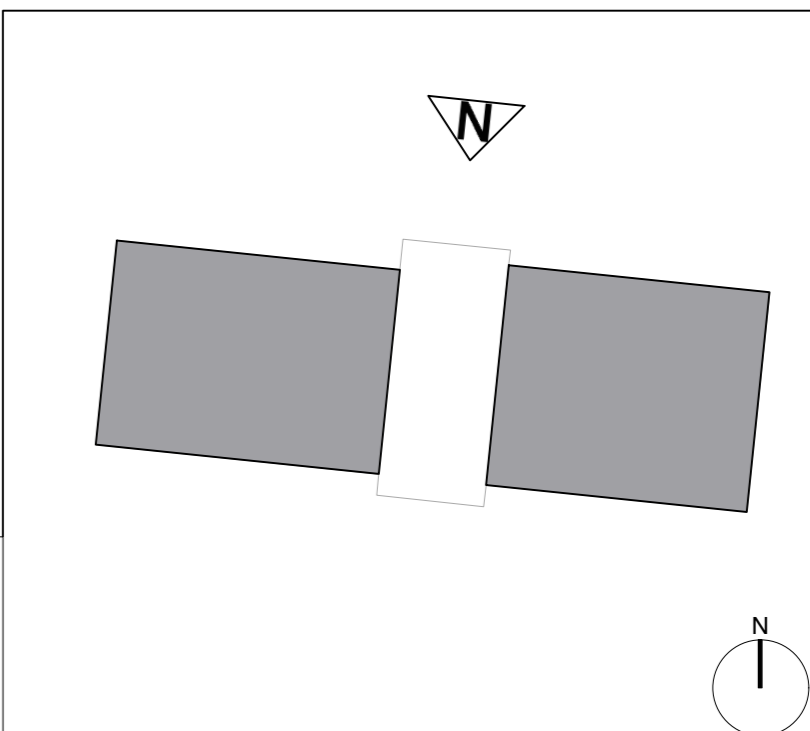
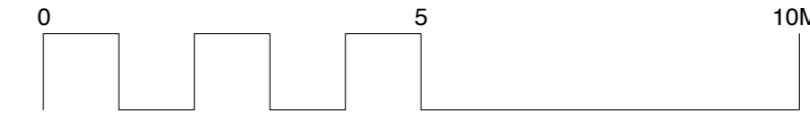

Copyright Hawkins Brown Architects LLP  
No implied license exists. This drawing should not be used to calculate areas for the purposes of valuation. Do not scale this drawing. All dimensions to be checked on site by the contractor and such dimensions to be their responsibility. All work must comply with relevant British Standards and Building Regulations requirements. Drawing errors and omissions to be reported to the architect.

#### Revisions

**Hawkins\Brown**  
60 Bastwick Street  
London EC1V 3TN  
020 7336 8030t  
020 7336 8851f  
mail@hawkinsbrown.com  
www.hawkinsbrown.com

Project  
Agar Grove  
Estate Regeneration

Drawing  
Plot B  
North Elevation

Scale @ A0 @ (A4)      Date  
1:100 (1:400)      December 2013

Drawn by      Checked by  
AC/JW      SR

Job Number      Status  
HB1423      Planning

Drawing No. & Revision  
1423\_DWG\_PlotB\_00\_250