

KEY PLAN

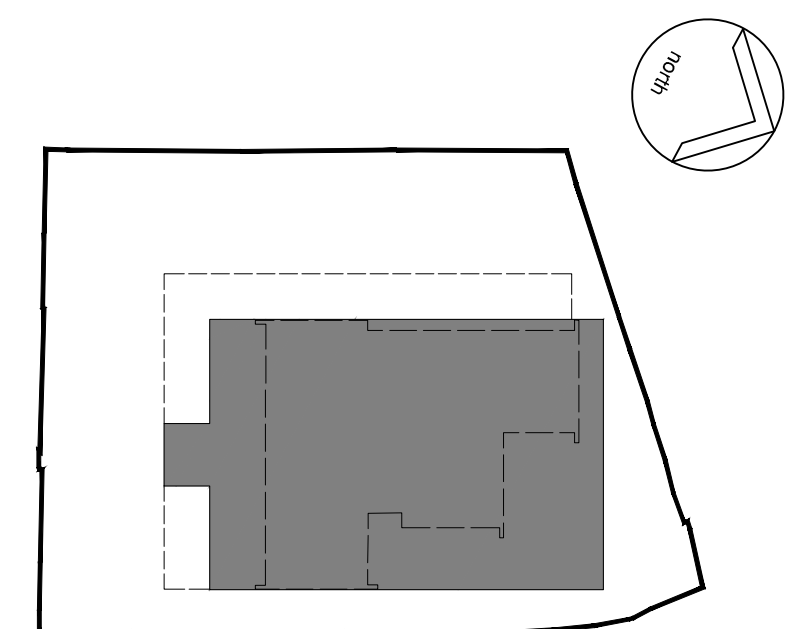

NOTES:

This drawing is produced for use in this project only and may not be used for any other purpose. NPS Property Consultants Ltd accept no liability for the use of this drawing other than the purpose for which it was intended in connection with this project as recorded on the title block fields 'Purpose for Issue' and 'File Status Code'.
 This drawing may not be reproduced in any form without prior written agreement.
 Do not scale from the drawing, use written dimensions only.

P1	ISSUED FOR PLANNING				
	REVISED BY: RG	DATE: 04.11.13	CHECKED BY: SS	DATE: 04.11.13	

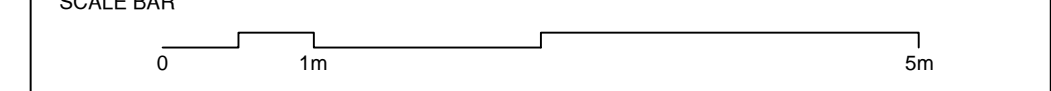

PURPOSE OF ISSUE
FOR PLANNING

FILE STATUS CODE
-

© COPYRIGHT NPS GROUP
Ordinance Survey mapping reproduced by permission of ?????? ADD & Controller of HM Stationery Office Crown Copyright.

Property Design and Management Services

Barron and Smith Architects
 3 Maltings Place
 169 Tower Bridge Road, London
 SE1 3JB
 TEL: 02079403456 FAX: 02079403460
 EMAIL: office@barronandsmith.co.uk

Head Office:
 Lancaster House, 18 Central Avenue, St Andrews Business Park,
 Newark, NE7 0PR. Tel: 01603 706000 Fax: 01603 706001

Other Office locations can be found on our website: www.nps.co.uk

CLIENT
London Borough of Camden

PROJECT
**Gospel Oak Primary School
 Early Years Foundation Stage
 Savernake Road NW3 2JB**

TITLE
Proposed Roof Plan

SCALES	DATE	DRAWN	CHECKED
1:50 @ A1	Oct 2013	RG	SS

FILE / DRAWING NAME	DRAWING FIELDS	UNIQUE NR	REV CODE
13-1-1011EYBAS-PL-A	067	067	P1