

WHEEL CHAIR ACCESSIBLE APARTMENT G.04

WHEELCHAIR ACCESSIBLE LAYOUT FOR GROUND FLOOR APARTMENT

2 Bed 3 Person

1. Dwelling has been designed on one level.
2. The main Entrance Door is 1010mm with a min clear opening of 800mm
3. The entrance hall way has a manoeuvring area of 1500mm x 1800mm behind the entrance door
4. A space to store and charge an electric wheelchair is provided in the sitting/dining/kitchen
5. All halls have been built to accommodate and facilitate 90 degree turns
6. All doors in rooms have been designed with 300mm clear on the pull side and 200mm clear on the push side
7. Sufficient turning space has been provided within the kitchen space and the layout has been designed to allow for flexibility of the user
8. All Bedrooms have a 1200 x 1200mm clear space to one side of the bed
9. Bathrooms have been provided to facilitate frontal and side transfer to toilets.
10. Wheelchair accessible bathrooms has a 1500x1500mm manoeuvring space clear of all fitting
11. In all wheelchair accessible bathrooms a drainage gully is to be provided to facilitate the installation of level entry shower (for a shower area of 1000 x 1000mm)
12. Suitable construction is in place to allow for a ceiling hoist within the apartment between main bedroom and bathroom
13. Windows are all operable from a seated position. Handle to be no higher than 1000mm from FFL.

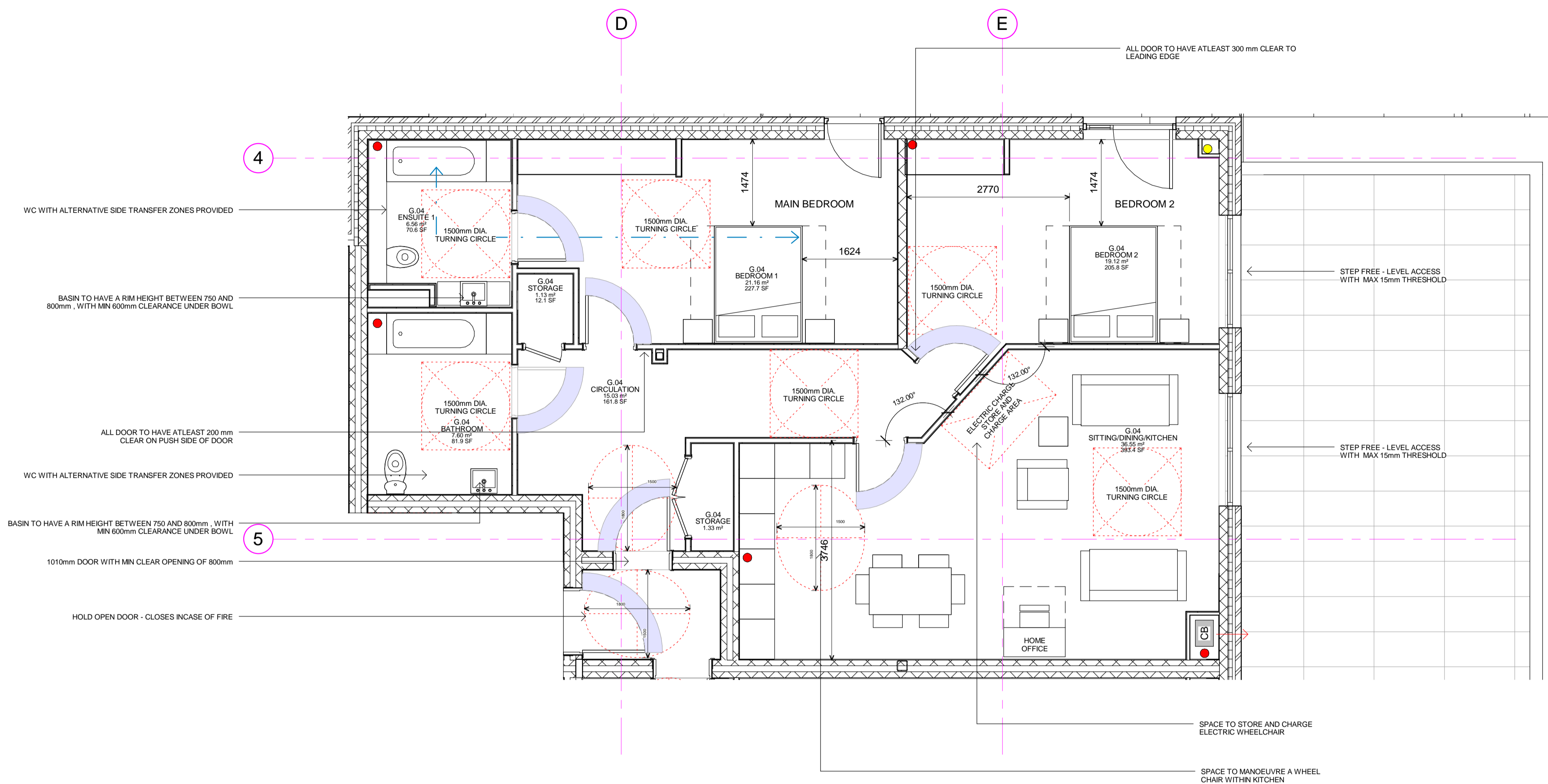

1 G.04 - WHEEL CHAIR ACCESSIBLE APARTMENT
1 : 50

KEY	RESIDUAL RISK
-----	---------------

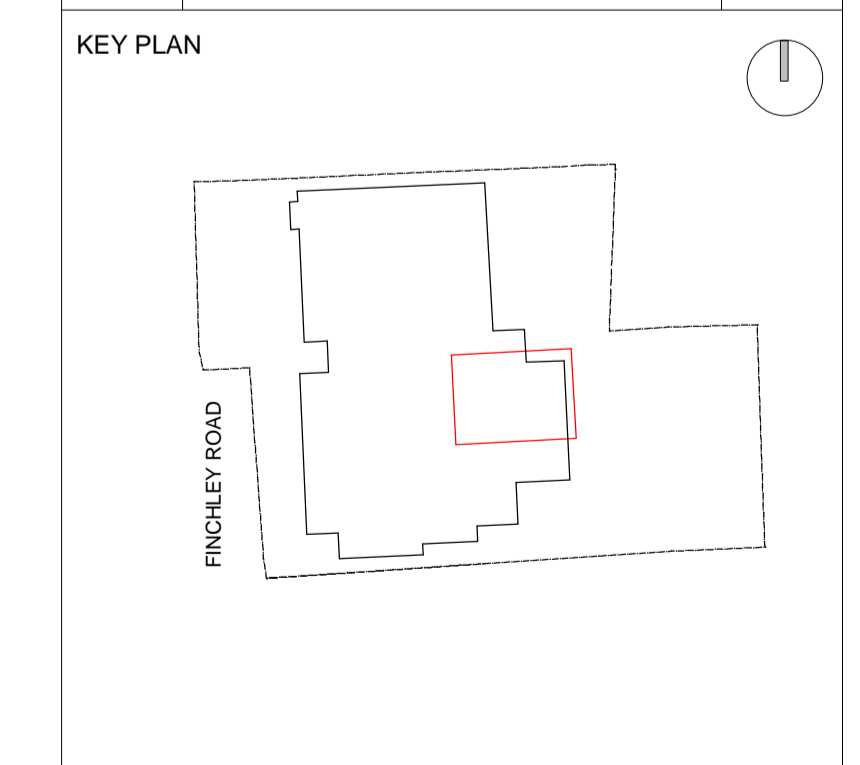

ORIGINATOR davidmillerarchitects WWW.DAVID-MILLER.CO.UK	DRAWING TITLE WHEEL CHAIR ACCESSIBLE APARTMENT LAYOUT-SHEET 3 OF 3						
JOB TITLE 388 - 372 FINCHLEY ROAD	JOB NO 282	STATUS FOR INFORMATION					
SCALE 1:50	DATE 12/18/13	CHECKED APPROVED @A1 Checker Approver					
PROJECT	ORIGIN	ZONE	LEVEL	TYPE	ROLE	SEQ NO	REV
FIN	DMA	ALL	GND	GA	A3	024	A

